

City of Monrovia Annexations

NO.	TYPENAME	REC'D DATE	ENY REC'D	ANNEX AREA	TOTAL AREA
1	ANNEX. BODY CHANGE 11-17-96	12/11/1997	1/5/2015		
2	ANNEXATION OF 1915		3/7/2005		
3	ANNEX. DIST. NO. 1	11/29/1947	9/28/1947	0.007	8.107
4	ANNEX. DIST. NO. 6	08/24/1948	8/23/1948	0.007	8.114
5	ANNEX. DIST. NO. 7	07/25/1949	7/25/1949	0.076	8.194
6	ANNEX. DIST. NO. 8	09/27/1950	9/25/1950	0.000	8.194
7	ANNEX. DIST. NO. 9	02/15/1951	1/8/1951	0.014	8.205
8	ANNEX. DIST. NO. 10	09/26/1951	7/18/1951	0.029	8.234
9	ANNEX. DIST. NO. 11	10/03/1952	9/26/1952	0.001	8.235
10	ANNEX. DIST. NO. 12	08/05/1953	6/26/1953	0.004	8.239
11	ANNEX. DIST. NO. 13	08/05/1953	6/26/1953	0.002	8.241
12	ANNEX. DIST. NO. 14	02/25/1954	2/15/1954	0.108	8.349
13	ANNEX. DIST. NO. 15	06/11/1954	5/24/1954	0.104	8.453
14	HIGHLAND TRAIL NO. 2 DETACH	11/28/1947	9/7/1954	-0.042	8.411
15	ANNEX. DIST. NO. 17	04/01/1956	3/28/1956	0.085	8.496
16	ANNEX. DIST. NO. 18	10/09/1956	10/14/1956	0.007	8.503
17	ANNEX. DIST. NO. 19	01/04/1957	08/23/1957	0.079	8.582
18	ANNEX. DIST. NO. 21	05/07/1957	5/2/1957	0.033	8.614
19	ANNEX. DIST. NO. 22	07/05/1957	07/05/1957	0.005	8.619
20	ANNEX. DIST. NO. 23	10/04/1957	9/23/1957	4.885	13.454
21	ANNEX. DIST. NO. 24	12/30/1957	12/20/1957	0.009	13.463
22	ANNEX. DIST. NO. 25	12/30/1957	12/20/1957	0.013	13.476
23	ONE ARCADEA ANNEX. 36 DETACH	06/19/1958	6/12/1958	0.001	13.477
24	ANNEX. DIST. FROM ARCADEA	06/19/1958	6/12/1958	0.001	13.477
25	ATTACH. OF TERR. ANNEX. NO. 29	08/04/1958	7/10/1958	0.000	13.477
26	ANNEX. DIST. FROM ARCADEA	08/22/1958	8/26/1958	0.003	13.480
27	ANNEX. DIST. NO. 27	08/22/1958	8/26/1958	0.005	13.485
28	ANNEX. DIST. NO. 30	08/23/1959	7/18/1959	0.011	13.496
29	ANNEX. DIST. NO. 31	08/24/1959	8/26/1959	0.000	13.496
30	ANNEX. DIST. NO. 40	06/19/1964	6/8/1964	0.004	13.517
31	ANNEX. DIST. NO. 33	09/04/1959	8/26/1959	0.001	13.501
32	ANNEX. DIST. NO. 34	12/03/1959	11/23/1959	0.006	13.507
33	ANNEX. DIST. NO. 35	11/09/1961	11/22/1961	-0.001	13.509
34	ANNEX. DIST. NO. 36	07/01/1962	7/06/1962	0.000	13.509
35	ANNEX. DIST. NO. 37	01/15/1963	1/7/1963	0.002	13.511
36	ANNEX. AREA NO. 38	03/20/1964	3/13/1964	0.002	13.513
37	ANNEX. DIST. NO. 40	06/19/1964	6/8/1964	0.004	13.517
38	ANNEX. NO. 41 FROM BRADY	06/19/1964	6/8/1964	0.006	13.523
39	ANNEX. 64 TO BRADY DR	07/28/1964	7/6/1964	-0.006	13.517
40	ANNEX. AREA NO. 7 TO DUATE DR	12/09/1966	12/5/1966	-0.001	13.516
41	ANNEX. NO. 42 DR FR DUATE	04/16/1969	3/4/1969	0.004	13.625
42	ANNEX. DIST. NO. 39.A	07/10/1969	6/25/1969	0.060	13.685
43	ANNEX. REORG. 26 TO DUATE	01/14/1979	01/14/1979	-0.002	13.683
44	ANNEX. REORG. 80 TO ARCADEA	08/01/1980	08/01/1980	0.007	13.690
45	ANNEX. REORG. NO 80 TO ARCADEA	06/02/1981	06/02/1981	0.000	13.690
46	REORG. 1.96 (PCS 182)	02/24/1997	02/24/1997	-0.004	13.686
47	REORG. 1.96 (PCS 182)	02/24/1997	02/24/1997	-0.004	13.686
48	REORG. TO 2015-01 DETACH FROM CITY OF MONROVIA ANNEX. TO CITY OF BRADBURY	01/11/2018		-0.005	13.681

NOTE: THE TOTAL AREA OF MONROVIA WAS 8,100 SQ. MI. AFTER NO. 2 ANNEXATION DISTRICT WAS ANNEXED.

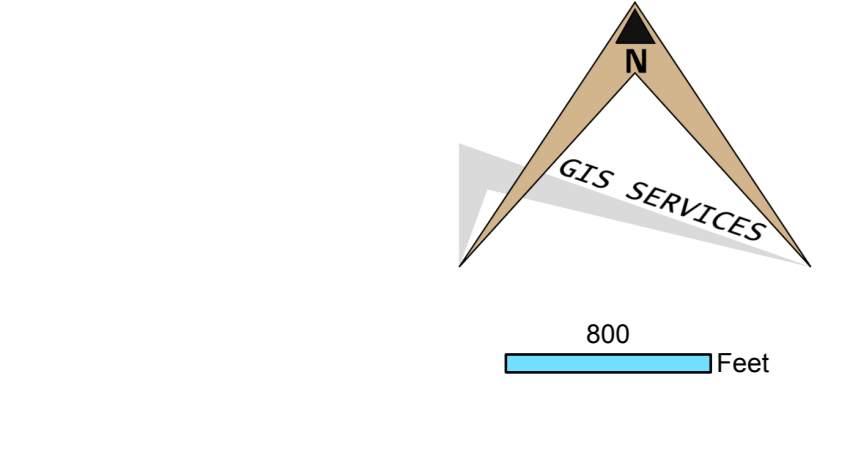
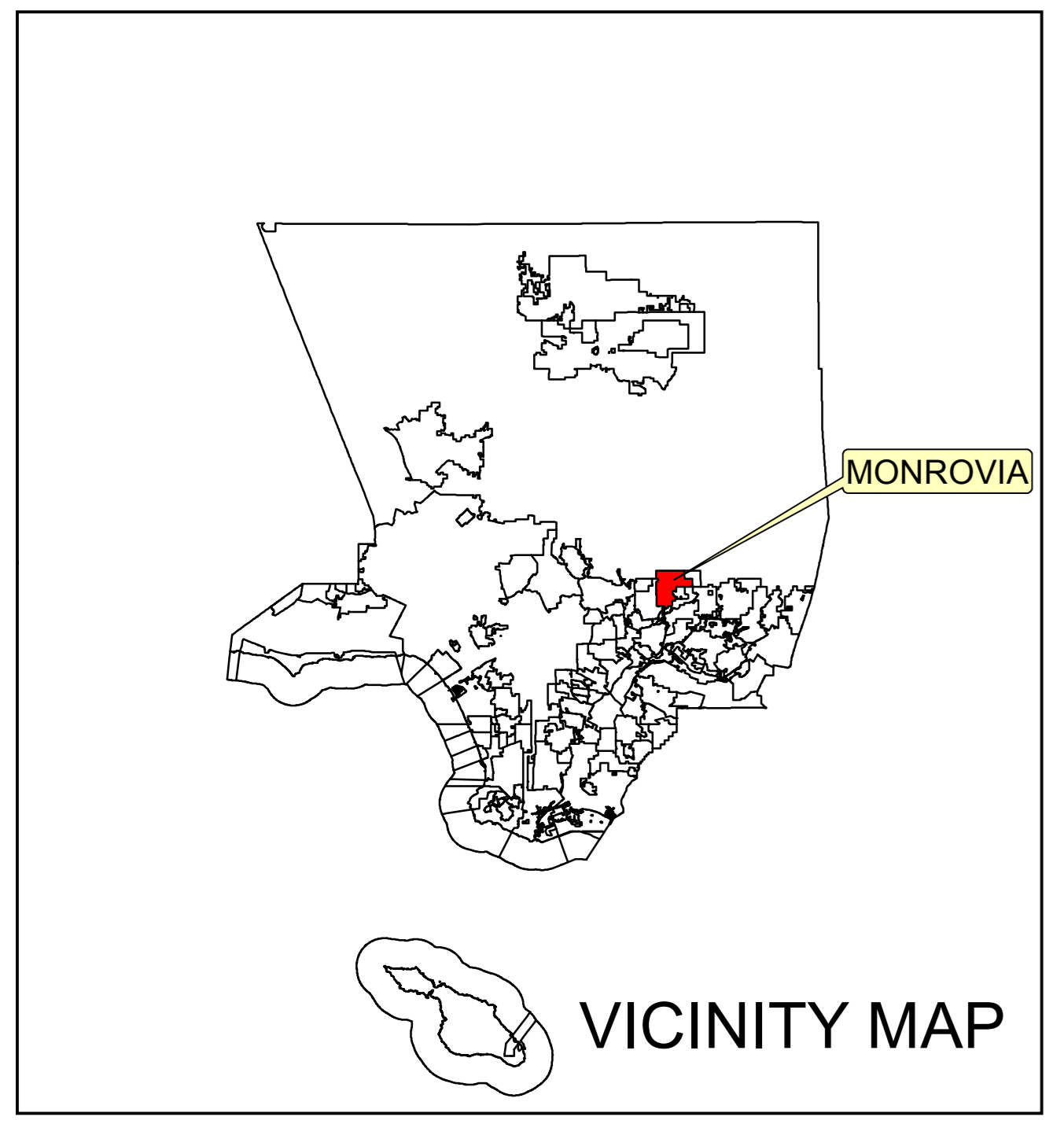
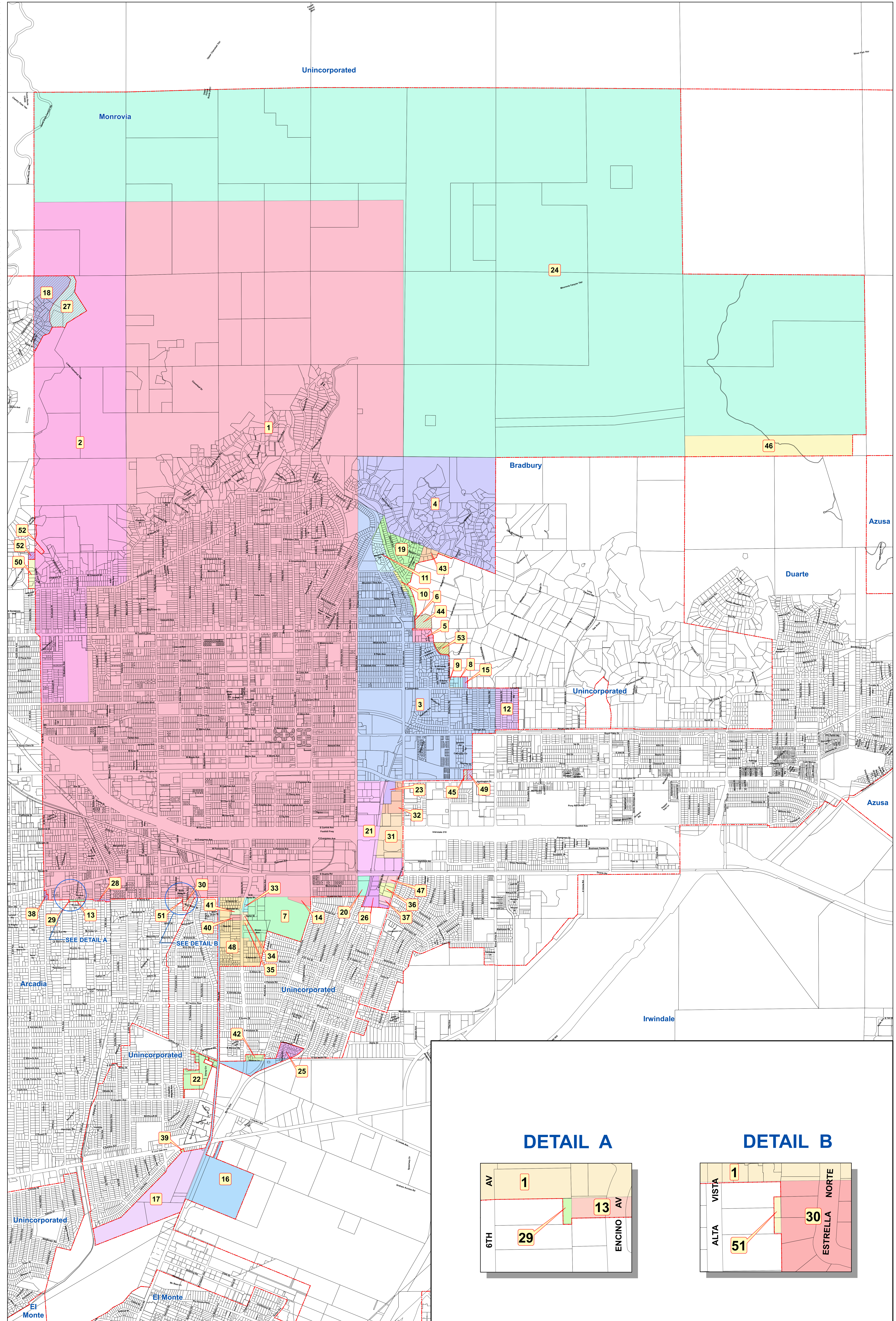

DEPARTMENT OF PUBLIC WORKS
 900 S. Fremont Ave.
 Alhambra, CA 91803
 Survey/Mapping & Property Management Division
 GIS Services

