

# CITY OF SAN GABRIEL ANNEXATIONS

NO.	TYPE	NAME	SEC. OF STATE	CNTY. RECORDER	ANNEX AREA	TOTAL AREA	
1	ORIGINAL INCORPORATION		04/22/1913				
2	ALBUQUERQUE DISTRICT		10/15/1928				
3	ALBUQUERQUE DISTRICT		08/12/1938				
4	SAN GABRIEL BOULEVARD DIST.		08/20/1938		3,280 Sq. M.	3,280 Sq. M.	
5	ALANEX DISTRICT NO. 5		10/05/1942		0.62	3.42	
6	ALANEX DIST. TO CITY OF ALHAMBRA		10/13/1955		0.02	3.50	
7	ALANEX NO. 7		03/02/1956		0.24	3.68	
8	ALANEX NO. 1959-3		03/18/1960		0.02	3.50	
9	ALANEX NO. 1960-1		09/09/1960		0.00	3.50	
10	ALANEX NO. 1960-2		11/25/1960		0.01	3.54	
11	ALANEX NO. 1960-3		03/25/1961		10/24/1960	0.01	3.50
12	ALANEX NO. 1962-3		10/29/1962		11/29/1962	0.00	3.50
13	ALANEX NO. 1962-3.1		03/20/1963		03/25/1963	0.02	3.52
14	ALANEX NO. 1963-1		04/21/1964		04/30/1964	0.02	3.52
15	ALANEX NO. 1964-5 BDRY. RELOC.		03/05/1965		03/13/1965	0.00	3.52
16	ALANEX NO. 1964-4		07/20/1965		08/05/1965	0.05	3.57
17	ALANEX NO. 1964-3		08/11/1965		08/16/1965	0.02	3.58
18	ALANEX NO. 1964-2		07/30/1965		08/06/1965	0.02	3.63
19	ALANEX NO. 1965-1		09/15/1965		09/17/1965	0.00	3.63
20	ALANEX NO. 1965-2		12/16/1965		12/17/1965	0.35	3.98
21	ALANEX NO. 1965-3		03/19/1965		03/04/1966	0.11	3.97
22	ALANEX NO. 1965-6		06/05/1967		06/12/1967	0.02	3.99
23	ALANEX NO. 1965-3		03/24/1968		03/30/1968	0.00	3.99
24	ALANEX NO. 1971-1		10/22/1971		11/03/1971	0.08	3.99
25	ALANEX NO. 1971-2		11/19/1971		12/01/1971	0.09	3.99
26	ALANEX NO. 1971-3		11/19/1971		12/01/1971	0.06	4.04
27	ALANEX NO. 1971-7		05/08/1972		05/15/1972	0.00	4.03
28	ALANEX NO. 1971-9		06/09/1972		06/23/1972	0.07	4.08
29	ALANEX NO. 1971-10		06/09/1972		06/23/1972	0.05	4.08
30	ALANEX NO. 1971-11		06/09/1972		06/23/1972	0.04	4.07
31	ALANEX NO. 1971-1		06/16/1972		07/03/1972	0.01	4.08
32	ALANEX NO. 1971-4		03/07/1972		07/20/1972	0.04	4.06
33	ALANEX NO. 1972-14		08/04/1972		08/10/1972	0.01	4.03
34	ALANEX NO. 1972-15		08/04/1972		08/10/1972	0.03	4.06
35	ALANEX NO. 1972-16		08/04/1972		08/10/1972	0.04	4.00
36	ALANEX NO. 1972-17		08/04/1972		08/10/1972	0.02	4.02
37	ALANEX NO. 1972-19		08/21/1972		08/29/1972	0.01	4.03
38	ALANEX NO. 1972-20		09/19/1972		09/25/1972	0.01	4.04
39	ALANEX NO. 1972-26		10/06/1972		10/12/1972	0.02	4.06
40	ALANEX NO. 1973-1		07/20/1973		08/03/1973	0.01	4.07
41	ALANEX NO. 1973-1		07/20/1973		08/03/1973	0.02	4.05
42	ALANEX NO. 1982-1		03/13/1983		08/02/1983	0.01	4.05

NOTE: THE TOTAL AREA OF SAN GABRIEL WAS 3,280 SQ. MI. AFTER THE SAN GABRIEL BOULEVARD DISTRICT ANNEXATION WAS ANNEXED.

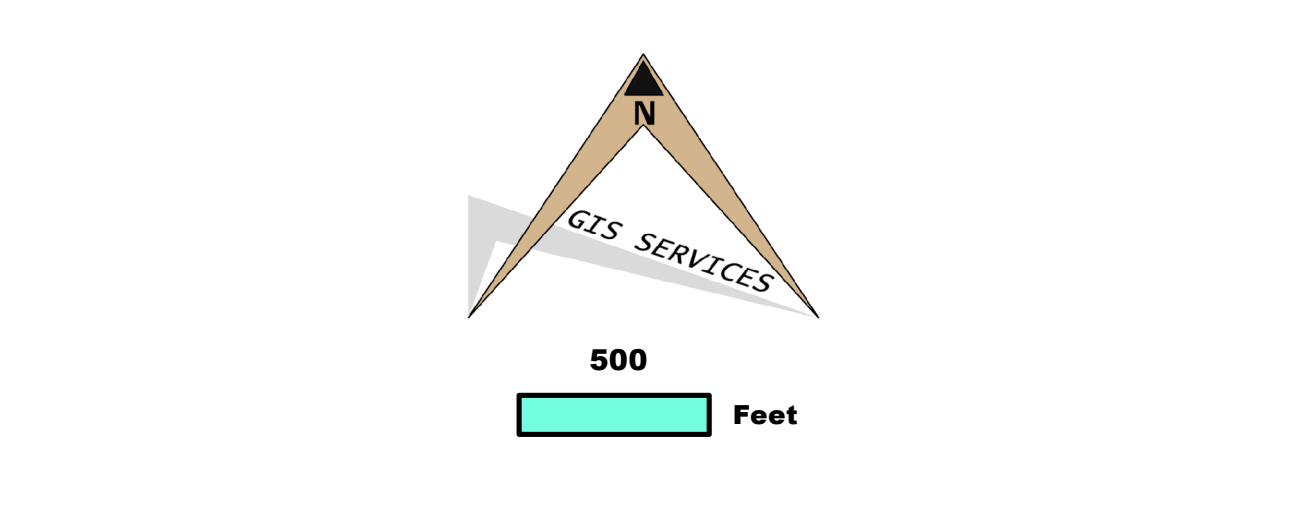
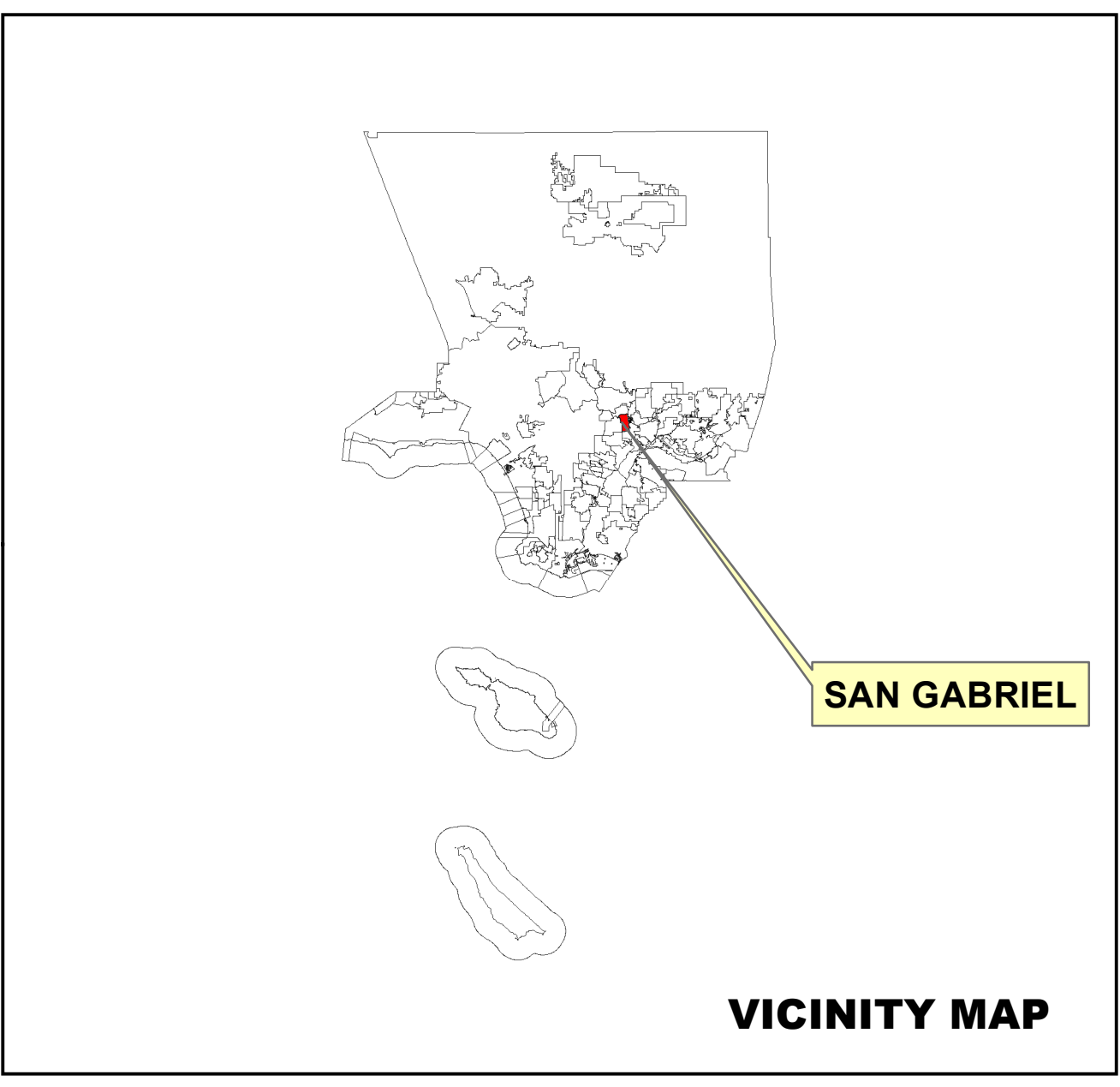
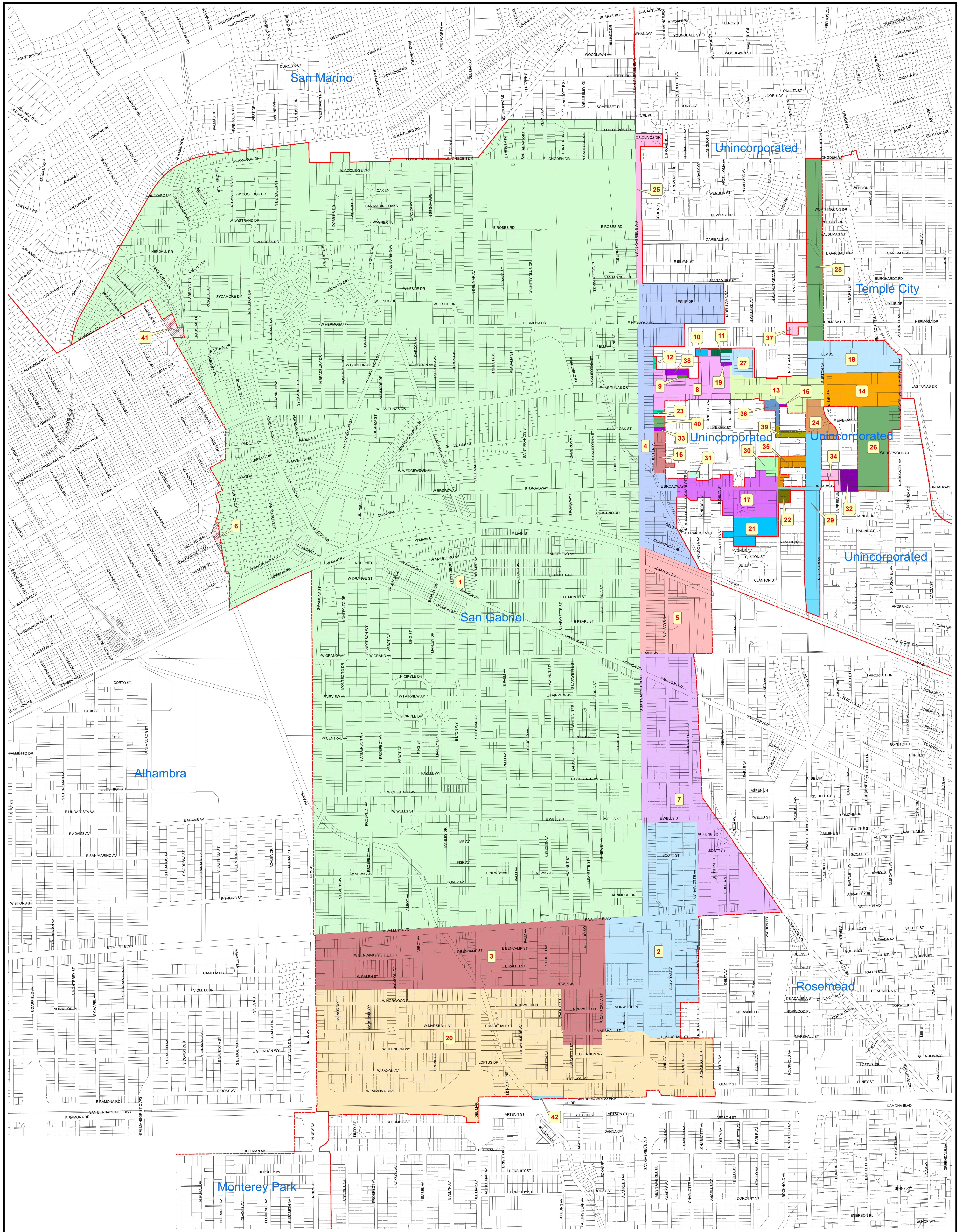

DEPARTMENT OF PUBLIC WORKS  
900 S. Fremont Ave.  
Alhambra, CA 91803

**PUBLIC WORKS**  
Survey/Mapping & Property Management  
Division - GIS Services

LOS ANGELES COUNTY EXPRESSLY DISCLAIMS ANY LIABILITY FOR INACCURACIES WHICH MAY BE PRESENT IN THIS MAP.

Data contained in this map is produced in whole or part from the Los Angeles County Department of Public Works Digital Database.