

John D. Conroy
185

Los Angeles City
March 22nd 1870

I hereby certify this to be a true copy of a map in my office showing the relative position of the 10 acre tract granted by the City of Los Angeles to Concha de Lewis April 19th 1855 & the tract described in a conveyance from Henry Hancock to Benjamin Virgin of date October 24th 1859. George Hansen. Surveyor.

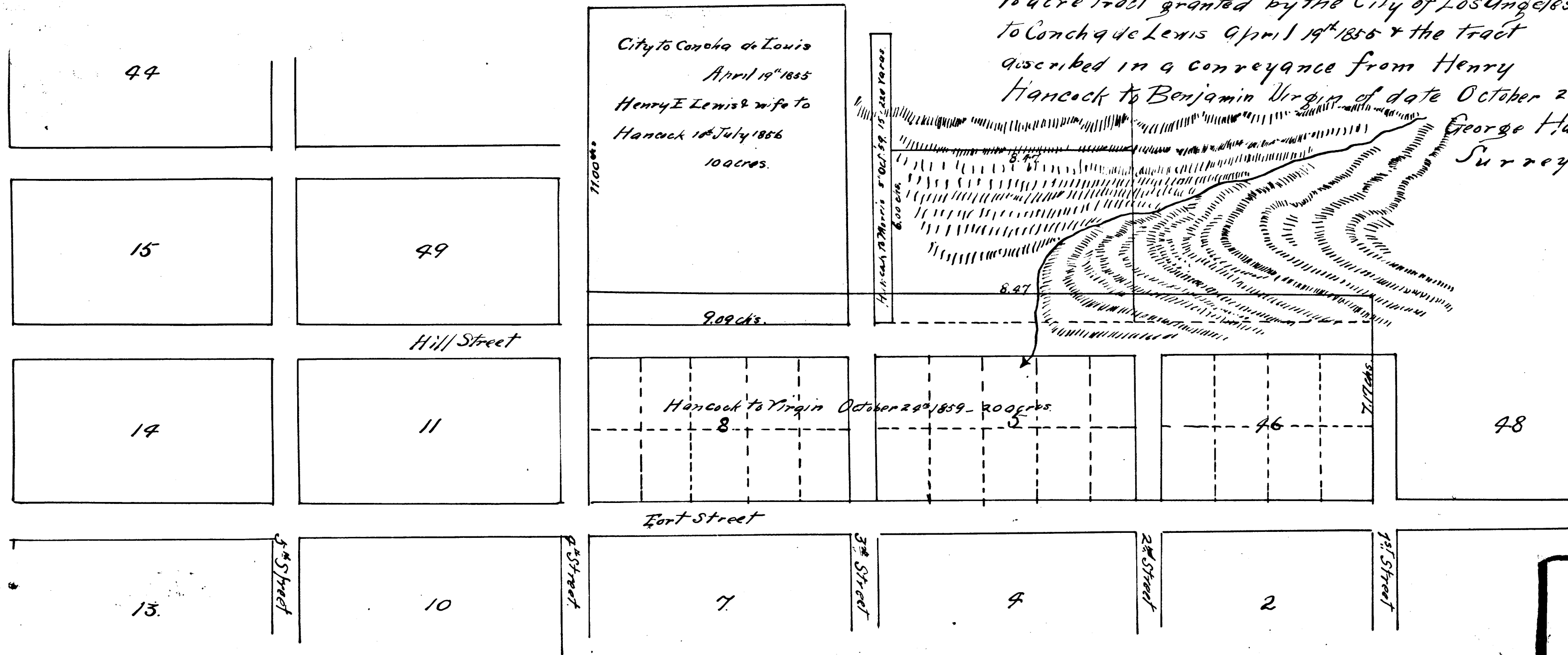

C.F. 24

District Court
No. 1456
Exh. L.

