

AN RAFAEL AND LA CANADA

CALIFORNIA

Surveyed by
 J. J. McCouven
 of Los Angeles County

INSTRUCTIONS OF
 J. S. Eaton and A. W. Hutton

appointed by order of the Hon^{ble} District
 Court of the State of California in
 the case # 1621 on the Docket of said
 case in et al. Plff^s v. Fernando Sepulveda
 et al Def^{ts}
 NEG. NO 29

MERIDIAN COURSES
 BEARING 15° EAST
 80 CHAINS PER INCH

Surveyors Map No 7566
 S. C. S. 3254 & L. S. 10-6

M. 8
 M. 41

Record of Final Jdmt.
 See minute Books of Dist. Ct. # 11 pg 35 et. sq.
 also Jdmt Book B. pg 671 et sq.

In the District Court of the 17th Judicial District
 of the State of California in and for the County
 of Los Angeles

ALFRED B. CHAPMAN ET. AL. }
 VS } N° 1621
 FERNANDO SEPULVEDA ET. AL. }

We the undersigned
 Referees in partition in this Suit do hereby
 certify that this Map exemplifies the division
 made by us and is the Map referred to in the
 Decree in this case and used by us in the
 partition

Los Angeles October 31. 1871.

James H. Gaudin

A. W. Hutton
Benj S Eaton

Filed Nov 21 1871
 S. H. Mott
 Clerk.

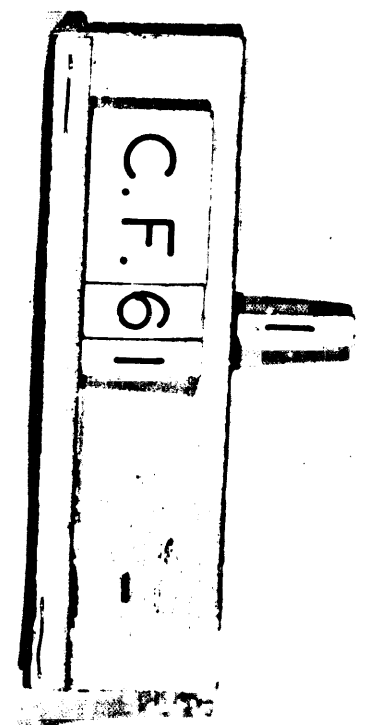
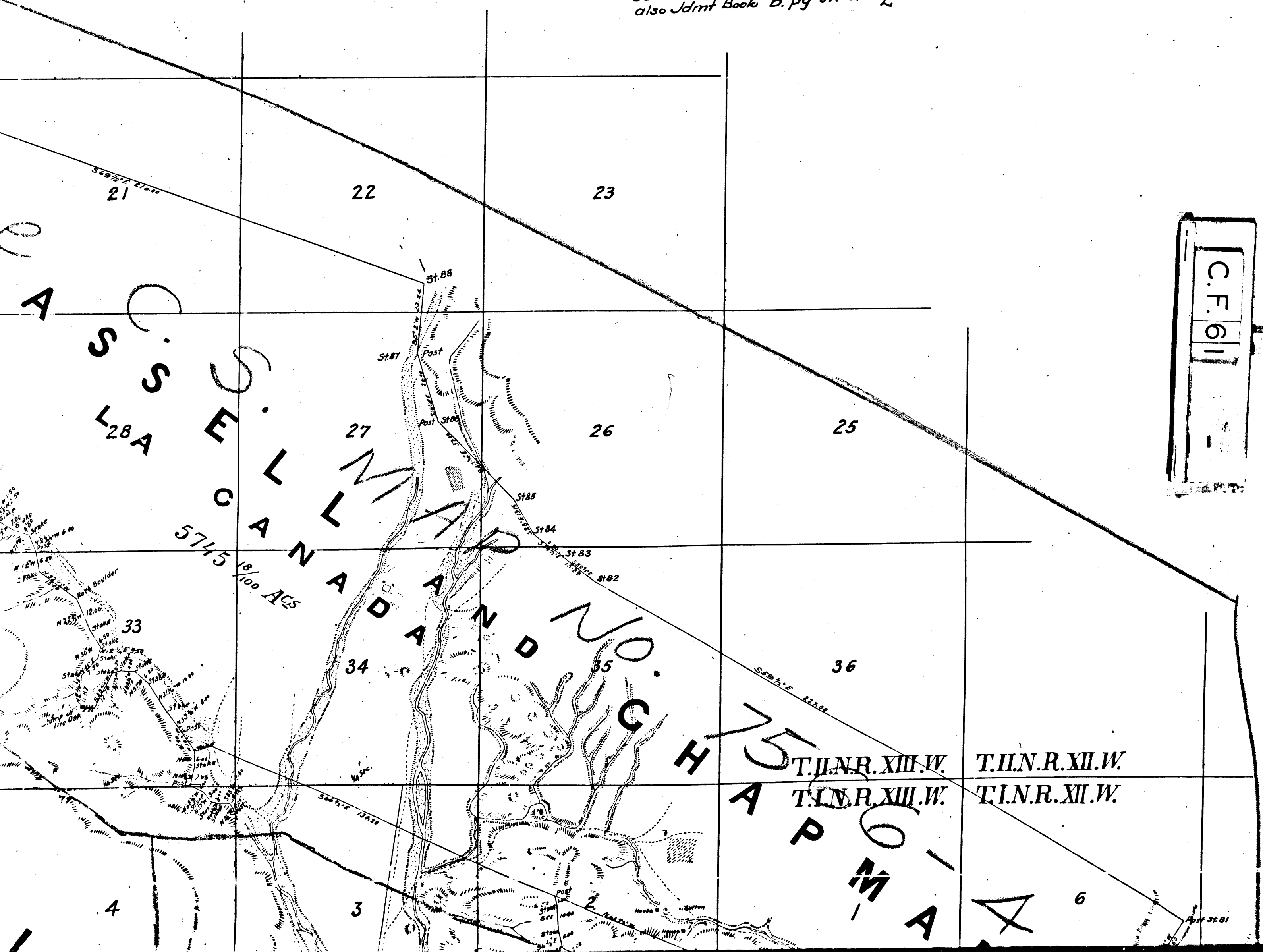

T.I.N.R. XII.W.
 T.I.N.R. XIII.W.

T.I.N.R. XII.W.
 T.I.N.R. XII.W.

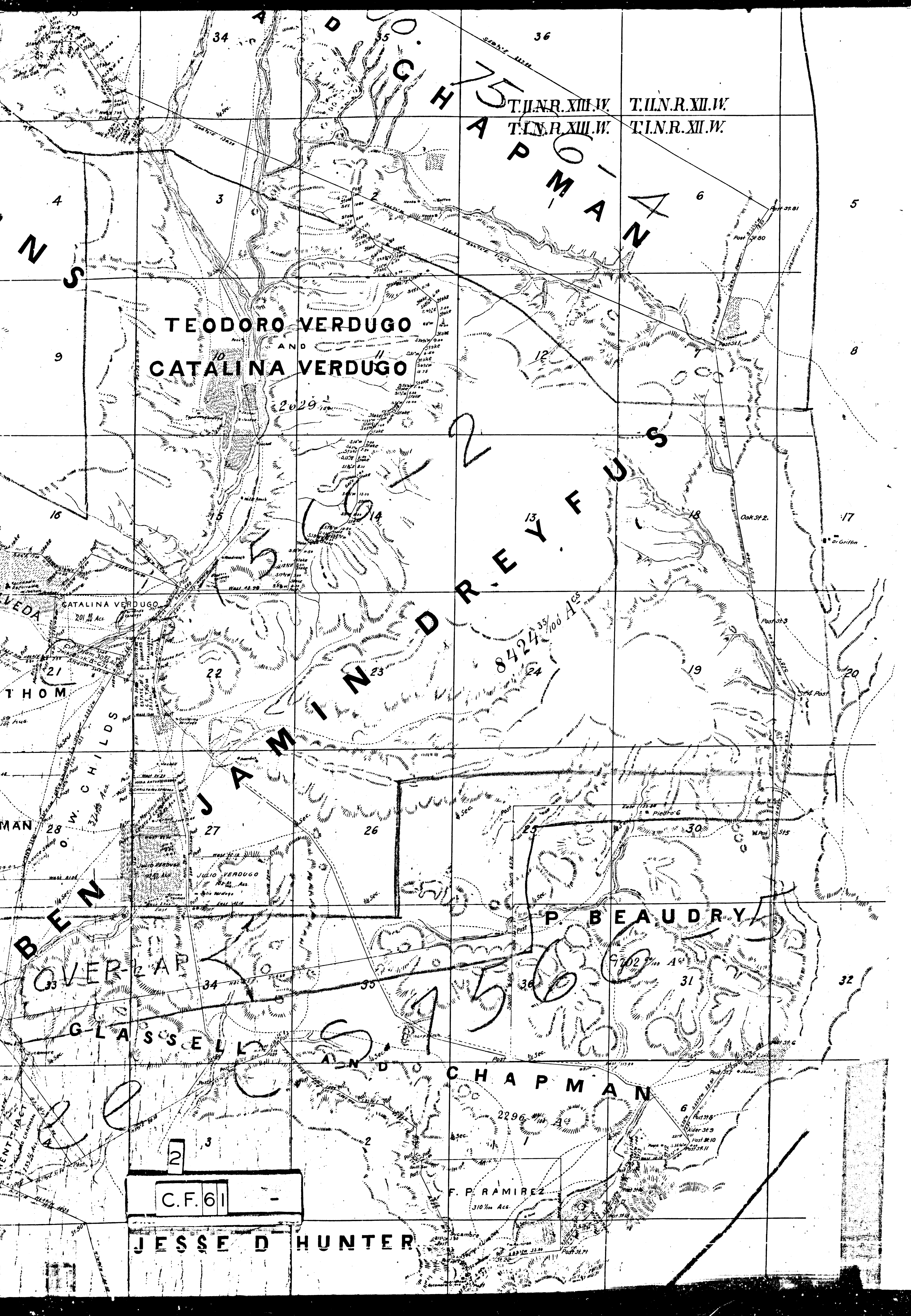

TEODORO VERDUGO
AND
CATALINA VERDUGO

T.11.N.R.XII.W.
T.12.N.R.XII.W.

JAMIN DREYFUS

OVERLAP
GLASSSELL

C.F. 61

JESSE D HUNTER

F. P. RAMIREZ
310 1/2 Acs.

8424 35/100 Acs

7702 3/100 Acs

2296 1/100 Acs

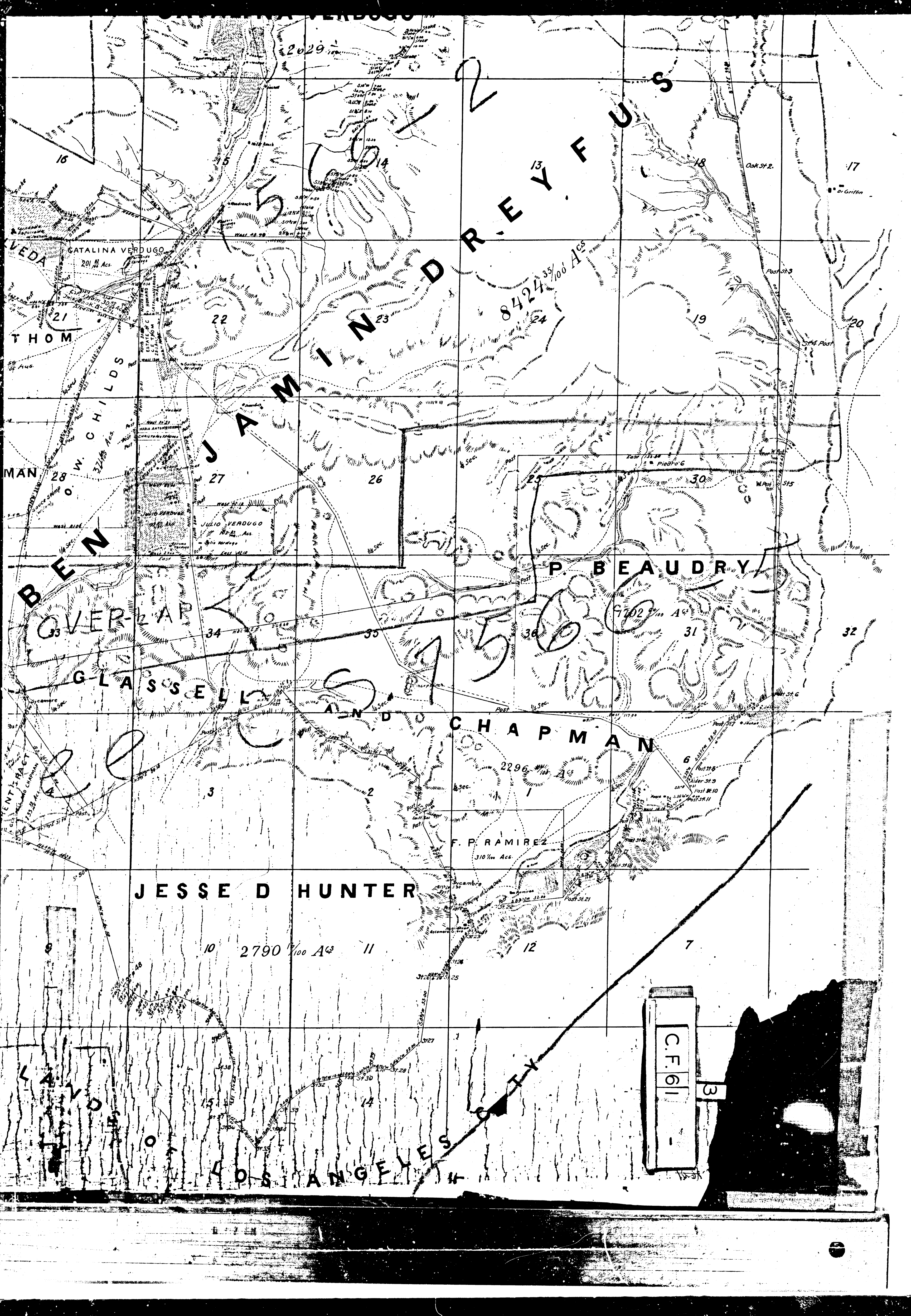

SCOTT TRACT

DAVID BURBANK

4603 ³⁵/₁₀₀ Acs

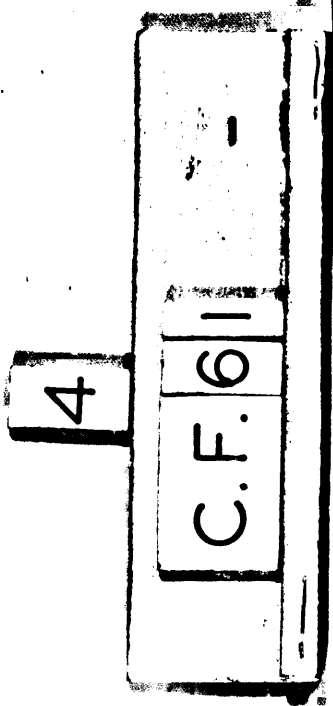

County Surveyors Note

- For description of Verdugo R^s see M:27-237
- " " " Camino del Arroyo (Glendale Ave) See M:36-171
- " " " Monterey See M:36-172
- " " " San Fernando Road " M:36-174

- Por to State for Hwy purp. - E:148-13.
- Por to City of Glendale for St. purp. - E:155-255 (CALLE VAQUERO @ VERDUGO ST.) (F.M. 20045)
- Por 262 1/2 Acs in Fair Glendale Way - E:162-198 OR E:1970-110
- Por " " " " " " " " - E:162-199 OR E:1970-112
- Por " " " " " " " " - E:162-200 OR E:1970-114
- Por " " " " " " " " - E:162-200 OR E:1970-124
- Por " " " " " " " " - Broadview Dr. & Park Pl. - E:164-37, O.R. 53331-182
- Por 669.08 " " " " " " " " - City of Glendale - E:173-244, C.R. D 135-879

Note: these corrections in red agree with the positions given in wording of Decree and with main map. Marginal map wrong in original. Spelling corrected to agree with Decree B:4671 CRISOSTIMO VERDUGO de CHABOLLA (in full)

BENJAMIN DREYFUS	
WEST 1/4	MARIA ANITA VERDUGO
WEST 1/4	CRISOSTIMO VERDUGO
WEST 1/4	MARIA ANITA VERDUGO
WEST 1/4	VITTORIO VERDUGO
WEST 1/4	GUILLERMO VERDUGO
WEST 1/4	RAFAEL VERDUGO
WEST 1/4	QUIRINO VERDUGO
WEST 1/4	JOSE MARIA VERDUGO
WEST 1/4	PEDRO VERDUGO
WEST 1/4	FERNANDO VERDUGO
JULIO VERDUGO	

SCALE 10 CHS PT INCH

T.I.N.R. XIII.W.
T.I.S.R. XIII.W.

SANTA EULALIA

WM. C. B. RICHARDSON

671 ⁸⁰/₁₀₀ Acs

GLASSELL AND CHAPMAN
29 669 ¹/₁₀₀ Acs

RAFAELA VERDUGO DE SEPULVEDA
909 ⁴⁰/₁₀₀ Acs

MARIA SEPULVEDA DE SANCHEZ
212 ⁴⁰/₁₀₀ Acs

P. BEAUDRY GETHON
500 ⁸⁰/₁₀₀ Acs

610 ⁸⁰/₁₀₀ Acs

11
Past St 70

14

13

8

8

9

18

17

16

30

20

21

31

32

33

8

CITY LA

Map of the exterior Boundaries and
 Subdivision lines of the Ranchos San Rafael
 and La Cañada, County and State afore-
 said as surveyed and marked by me in the
 months of May, June, July and August 1871.
 Los Angeles October 31, 1871.

Frank Leavitt
 County Surveyor of Los Angeles County

and for Los Angeles County in case #
 Court of Alfred B. Chapman et al. Plff
 et al Def^d

NEG. No 23

TRUE MERIDIAN C
 VARIATION 15° E
 SCALE 20 CHAINS

See County Surveyors M
 See C.F. 893, C.F. 295, C.S. 3254 & L.S.

I.M. 8
 L.M. 41

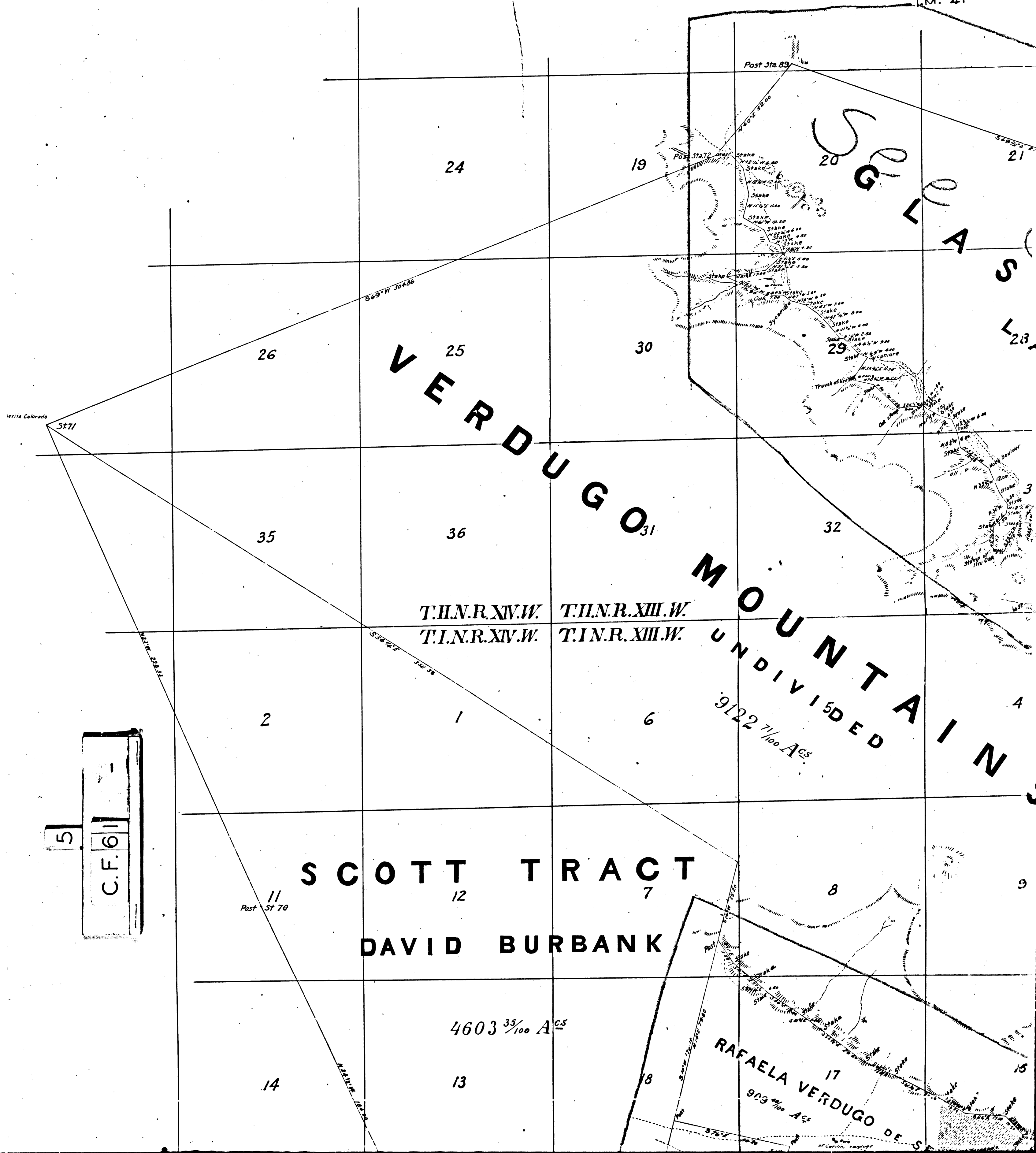

5
 C.F. 611

SCOTT TRACT
 DAVID BURBANK

4603 ³⁵/₁₀₀ A^{cs}

RAFAELA VERDUGO DE S
 903 ⁷/₁₀₀ A^{cs}

MAP OF THE RANCHOS SAN RAFAEL
 Surveyed by
Frank Lecove
 County Surveyor of Los Angeles
 LOS ANGELES CO.

UNDER INSTRUCTIONS

Mess^{rs}. J. H. Lander. Benj. S. East

Referees in Partition appointed by or
 Court of the 17th Judicial District of the
 and for Los Angeles County in case # 10
 Court of Alfred B. Chapman et al. Plff
 et al Def^{ts}

NEG. No 29

TRUE MERIDIAN CO
 VARIATION 15° E
 SCALE 20 CHAINS

See County Surveyors Mo
 See C.F. 893, C.F. 235, C.S. 3254 & L. 5

I.M. 8
 I.M. 41

County Surveyors Office

COUNTY OF LOS ANGELES
 STATE OF CALIFORNIA

I the undersigned
 do hereby certify the within to be a true and
 correct Map of the exterior Boundaries and
 Subdivision lines of the Ranchos San Rafael
 and La Cañada, County and State afore-
 said as surveyed and marked by me in the
 months of May, June, July and August 1871.
 Los Angeles October 31. 1871.

Frank Lecove
 County Surveyor of Los Angeles, Calif.

