

by L. Friel.

W.H. Norway

Description from

stances of

erly Bound-

ding to Han-

re shown

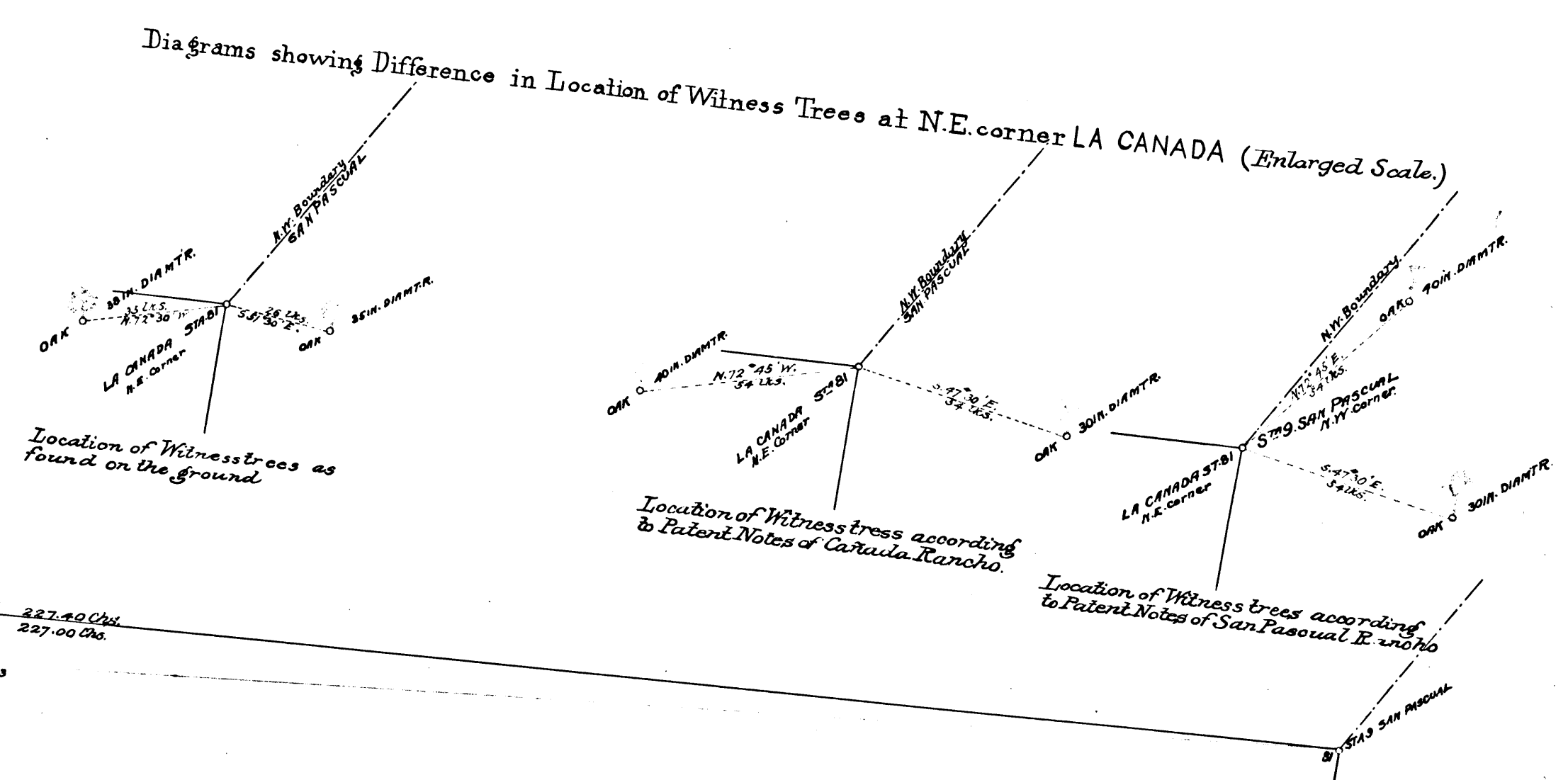
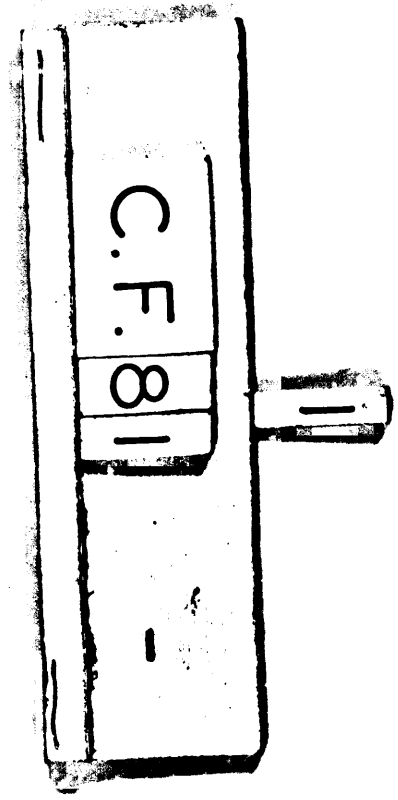
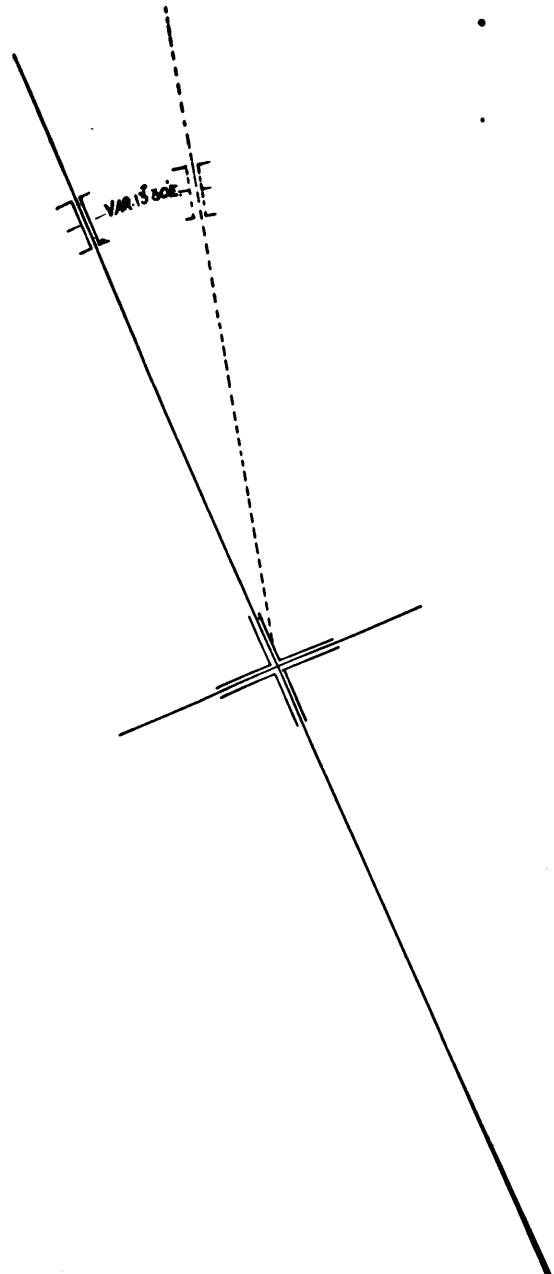

Actual Course and Distance N.60° 00' W. 227.40 Chs.  
 Patent Course and Distance N.60° 30' W. 227.00 Chs.  
 N.62° 18' W. 234.43

TABLE

FROM PARENT NOTES

LA CANADA

FROM PARENT NOTES		FROM HANCOCK'S SURVEY NOTES					
Course	Dist.	Remarks	Numbers	Course	Dist.	Remarks	Var. 13° 30' E
12° 12' N.	0.59	To Stake Station	135	N. 12° W.	0.59	To Station	
51 1/2° E.	2.72	Stake Station	136	N. 51 1/2° E.	2.72	Sta. Oak 1 1/2 diam.	
66 1/2° E.	4.84	Stake Station	137	S. 66 1/2° E.	4.84	Stake Station	
43 1/2° E.	5.78	Stake Station	138	S. 43 1/2° E.	5.78	Sta. Oak 2 1/2 diam.	
86° E.	2.94	Stake Station	139	N. 86° E.	2.94	Stake Station	
71 1/2° E.	16.00	Stake Station	140	S. 71 1/2° E.	16.00	Stake Station	
57 1/2° E.	11.84	Sycamore 2 1/2 diam to Str.	141	S. 57 1/2° E.	11.84	Str. Sycamore, 2 1/2 diam.	
77 1/2° E.	0.69	Stake Str. at foot of Granite point	142	N. 77 1/2° E.	0.69	Str. at foot of a Granite point	
32° E.	7.83	Stake Station	143	S. 32° E.	7.83	Str. a dead Sycamore 1 1/2 diam.	
13 1/2° E.	4.96	Oak 12 in. diam. to Station	144	S. 13 1/2° E.	4.96	Str. Oak 1 1/2 diam.	
67° E.	1.10	Stake Station	145	S. 67° E.	1.10	Str. Stake	
13 1/2° E.	7.39	Oak 24 in. diam. to Station	146	S. 13° E.	7.39	Str. Oak, 2 1/2 diam.	
81° E.	1.29	Stake Station	147	N. 81° E.	1.29	Str. Stake on Edge of Gulch	
82° E.	5.66	Stake Station	148	S. 82° E.	5.66	Str. Stake	
62° E.	4.50	Stake Station	149	S. 62° E.	4.50	Str. Stake	
23° W.	4.58	Oak, 12 diam. to Station	150	S. 23° W.	4.58	Str. Oak 1 1/2 diam.	
30 1/2° E.	2.48	Stake Station	151	S. 30 1/2° E.	2.48	Stake Station	
28 1/2° E.	3.40	Oak 18 in. diam. to Station	152	S. 28 1/2° E.	3.40	Str. Oak 1 1/2 diam.	
72° E.	9.85	Stake Station	153	S. 72° E.	9.85	Str. Sycamore 1 1/2 diam.	
26 1/2° E.	6.97	Sycamore 12 in. diam. to Str.	154	S. 26 1/2° E.	6.97	Str. Oak 2 1/2 diam.	
7 1/2° W.	2.35	Oak, 12 in. diam. to Station	155	S. 7 1/2° W.	2.35	Str. Oak 1 1/2 diam.	
38 1/2° W.	5.58	Stake Station	156	S. 38 1/2° W.	5.58	Str. a Rock	
20 1/2° E.	1.08	Stake Station	157	S. 20 1/2° E.	1.08	Str. Stake in Chaparral	
38° W.	2.40	Oak, 24 in. diam. to Station	158	S. 38° W.	2.40	Str. Oak 2 1/2 diam.	
84 1/2° E.	3.12	Stake Station	159	S. 84 1/2° E.	3.12	Stake Station	
60 1/2° W.	1.16	Oak, 12 in. diam. to Station	160	S. 50 1/2° W.	1.16	Str. Live Oak 1 1/2 diam.	
59 1/2° W.	1.95	Oak, 36 in. diam. to Station	161	S. 59 1/2° W.	1.95	Str. Oak 3 1/2 diam.	
21 1/2° E.	1.92	Stake Station	162	S. 21 1/2° E.	1.92	Str. Oak 2 1/2 diam. (to rough to run further up Cañada)	
76° E.	2.10	Stake Station	163	N. 76° E.	2.10	Stake Station	
East	3.06	Stake Station	164	East	3.06	Str. Oak 1 1/2 diam.	
74 1/2° E.	2.83	Stake Station	165	N. 74 1/2° E.	2.83	Str. Oak 1 1/2 diam.	
62 1/2° E.	7.50	Stake Station	166	N. 62 1/2° E.	7.50	Str. Stake	
82° E.	2.50	Stake Station	167	N. 82° E.	2.50	Str. Stake	
7 1/2° E.	2.96	Oak 12 in. diam. to Str.	68	S. 70 1/2° E.	2.96	Str. Oak, 1 1/2 diam.	
53° E.	4.50	Sycamore 9 in. diam. to Str.	169	S. 53° E.	4.50	Str. Sycamore, 1 1/2 diam. on Edge of Arroyo	
31° E.	3.93	Stake Str. on bank of an Arroyo	170	S. 31° E.	3.93	Str. Stake	
27 1/2° E.	5.62	Stake Str.	171	S. 27 1/2° E.	5.62	Str. Stake	
13 1/2° E.	3.03	Oak Str.	172	S. 13 1/2° E.	3.03	Str. Oak 2 1/2 diam.	
25 1/2° E.	2.72	Oak 12 in. diam. to Station	173	S. 25 1/2° E.	2.72	Str. Oak, 1 1/2 diam.	
51° E.	1.82	a blazed Sycamore 16 in. diam.	174	S. 61° E.	1.82	Str. Sycamore, 16 in. diam.	

RANCHO SAN PASCUAL

FILED MAY 23 1893

# PLAT

## OF THE EXTERIOR BOUNDARY OF THE "LA CAÑADA" RANCHO

Resurveyed according to Hancock's Survey Notes, in August 1890

by L. Friel.

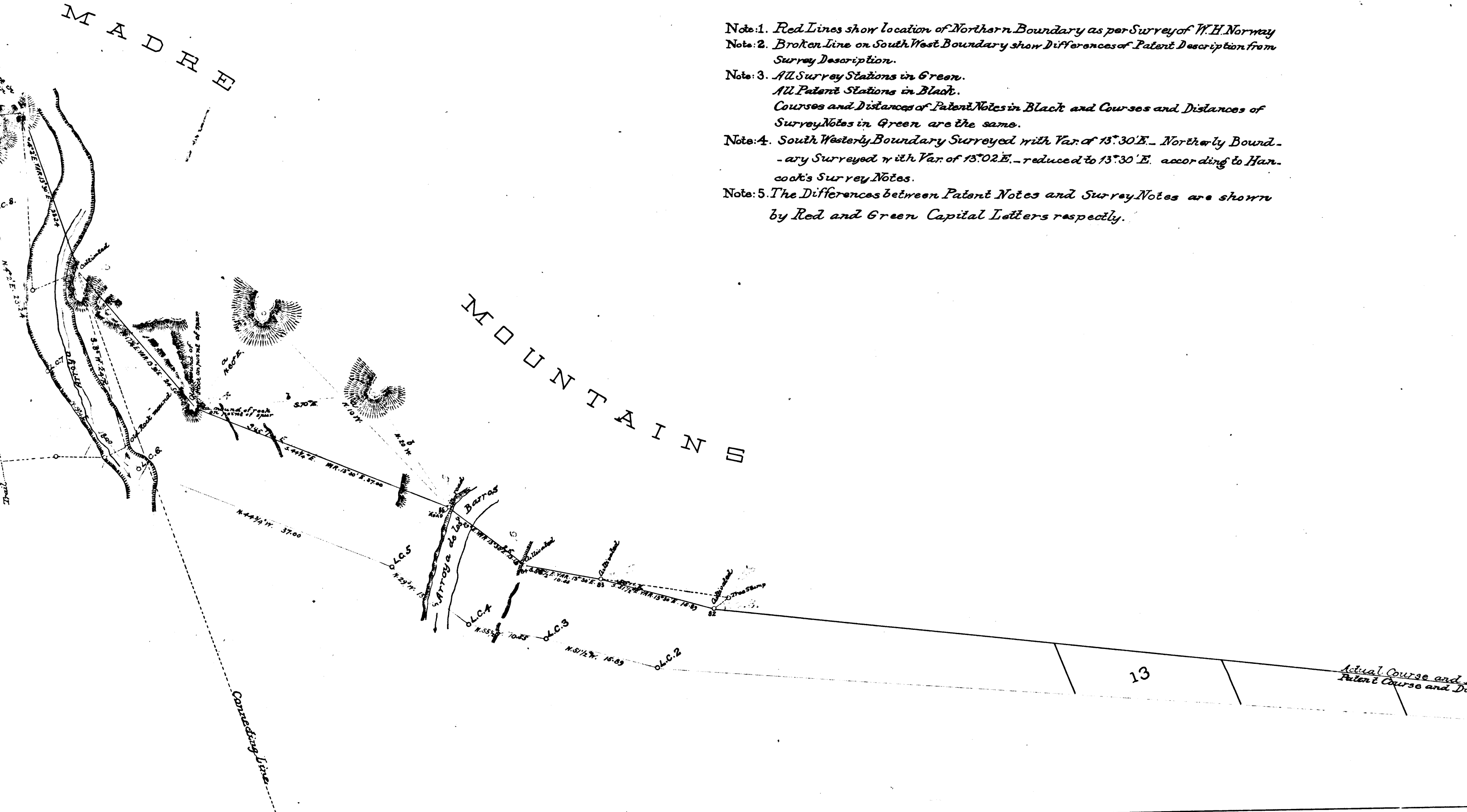

- Note 1. Red Lines show location of Northern Boundary as per Survey of W.H. Norway
- Note 2. Broken Line on South West Boundary show Differences of Patent Description from Survey Description.
- Note 3. All Survey Stations in Green.  
All Patent Stations in Black.  
Courses and Distances of Patent Notes in Black and Courses and Distances of Survey Notes in Green are the same.
- Note 4. South Westerly Boundary Surveyed with Var. of 13° 30' E. - Northernly Boundary Surveyed with Var. of 13° 02' E. - reduced to 13° 30' E. according to Hancock's Survey Notes.
- Note 5. The Differences between Patent Notes and Survey Notes are shown by Red and Green Capital Letters respectively.

### REFERENCE TABLE OF SURVEY OF SOUTHWESTERN PORTION RANCHO LA CAÑADA

FROM PATENT NOTES				FROM HANCOCK'S SURVEY NOTES				FROM PATENT NOTES			
Numbers	Course	Dist.	Remarks	Numbers	Course	Dist.	Remarks	Numbers	Course	Dist.	Remarks
1	S. 22 1/2° E.	1.84	To Stake Station	99	S. 22 1/2° E.	1.64	To Station	38	N. 12° W.	0.59	To Stake Station
2	S. 44 1/2° E.	0.83	Live Oak, 12' diam.	100	S. 44 1/2° E.	0.63	Sta. Live Oak, 12 in. diam.	39	N. 51 1/2° E.	2.72	Stake Station
3	S. 7 1/2° E.	3.18	Live Oak, 30 in. diam.	101	S. 7 1/2° E.	3.16	Sta. Oak, 3 ft. diam.	40	S. 68 1/2° E.	4.84	Stake Station
4	S. 36 1/2° E.	0.87	Stake Station	102	S. 36 1/2° E.	0.87	Sta. in bed of Arroyo	41	S. 43 1/2° E.	5.78	Stake Station
5	S. 3° E.	1.71	Stake Station, the dry Bed of an Arroyo, course S.E.	103	S. 3° E.	1.71	Sta. Live Oak, 2 ft. diam.	42	N. 86° E.	2.94	Stake Station
6	S. 24 1/2° E.	4.40	Stake Station	104	S. 24 1/2° E.	4.40	Station	43	S. 71 1/2° E.	16.00	Stake Station
7	S. 73° E.	14.04	Live Oak, 18 in. diam. to Station	105	S. 13° E.	14.04	Station, Live Oak 18 in. diam.	44	S. 37 1/2° E.	11.84	Sycamore, 2 ft. diam. to Str.
8	S. 59° E.	4.05	Live Oak, 24 in. diam. to Station	106	S. 59° E.	4.05	Str. Oak, 2 ft. diam.	45	N. 71° E.	0.69	Stake Str. at foot of Granite point
9	S. 25° E.	2.59	Live Oak, 20 in. diam. to Station	107	S. 25° E.	2.59	Str. Oak, 1 ft. diam.	46	S. 13 1/2° E.	7.83	Stake Station
10	S. 10 1/2° E.	4.20	Live Oak, 24 in. diam. to Station	108	S. 10 1/2° E.	4.20	Str. Oak, 2 ft. diam.	47	S. 32 1/2° E.	4.96	Oak, 12 in. diam. to Station
11	S. 78 1/2° E.	2.86	Live Oak, 24 in. diam. to Station	109	S. 78 1/2° E.	2.86	Str. Oak, 2 ft. diam.	48	S. 67° E.	1.10	Stake Station
12	S. 50° E.	2.79	Live Oak, 18 in. diam. to Station	110	S. 50° E.	2.79	Str. Oak, 18 in. diam.	49	S. 13° E.	7.39	Oak, 24 in. diam. to Station
13	S. 8° E.	3.14	Live Oak, 12 in. diam. to Station	111	S. 8° E.	3.14	Str. Oak, 1 ft. diam.	50	N. 81° E.	1.29	Stake Station
14	S. 67 1/2° W.	1.85	Live Oak, 12 in. diam. to Station	112	S. 67 1/2° W.	1.85	Str. Oak, 1 ft. diam.	51	S. 82° E.	5.66	Stake Station
15	S. 19 1/2° W.	3.21	Live Oak, 6 in. diam. to Station	113	S. 19 1/2° W.	3.21	Str. Oak, 1/2 ft. diam.	52	S. 62° E.	4.50	Oak, 12 in. diam. to Station
16	S. 40 1/2° W.	7.95	Stake Sta. on top of Spur, 4 Ch. wide, course North	114	S. 40 1/2° W.	7.95	5.00 to top of Spur, 7.95 to Str. on Slope of Hill	53	S. 23 1/2° W.	4.58	Oak, 12 in. diam. to Station
17	S. 79 1/2° W.	18.57	Oak, 30 in. diam. to Sta. on top of Spur 8 Ch. wide course North	115	S. 79 1/2° W.	18.57	8.00 to top of Ridge, 18.57 to Str. Oak, 2 ft. diam. on point of Spur	54	S. 30 1/2° E.	2.48	Stake Station
18	S. 80° E.	3.91	Oak, 27 in. diam. to Station	116	S. 80° E.	3.91	To Str. Live Oak, 27 ft. in. diam.	55	S. 28 1/2° E.	3.40	Oak, 18 in. diam. to Station
19	S. 70° E.	7.00	Stake Station	117	S. 70° E.	7.00	Str.	56	S. 72° E.	3.65	Stake Station
20	S. 75° E.	4.57	Oak, 36 in. diam. to Station	118	S. 75° E.	4.57	Str. Oak, 3 ft. diam.	57	S. 26 1/2° E.	6.97	Sycamore, 12 in. diam. to Str.
21	S. 63° E.	4.92	Oak, 21 in. diam. to Station	119	S. 63° E.	4.92	Str. Oak, 2 ft. diam.	58	S. 14 1/2° W.	2.35	Oak, 12 in. diam. to Station
22	N. 80° E.	1.00	Oak, 12 in. diam. to Station	120	N. 80° E.	1.00	Sta. Oak, 1 ft. diam.	59	S. 38 1/2° W.	5.58	Stake Station
23	N. 84° E.	4.87	Stake Sta. in rocky Bed of dry Arroyo, course South East	121	N. 84° E.	4.87	3.50 into rocky Bed of Arroyo, 4.87 to Sta. Oak, 2 ft. diam.	60	S. 20 1/2° E.	1.08	Stake Station
24	S. 87 1/2° E.	2.00	Stake Station	122	S. 87 1/2° E.	2.00	To Str. Oak, 3 ft. diam.	61	S. 38 1/2° W.	3.12	Stake Station
25	S. 51° E.	3.50	Sycamore, 8 in. diam. to Station	123	S. 51° E.	3.50	Str. Sycamore, 1 1/2 ft. diam.	62	S. 84 1/2° W.	3.12	Oak, 12 in. diam. to Station
26	S. 69 1/2° E.	4.00	Stake Station	124	S. 69 1/2° E.	4.00	Str.	63	S. 50 1/2° E.	1.18	Oak, 36 in. diam. to Station
27	S. 54 1/2° E.	12.00	Stake Station	125	S. 54 1/2° E.	12.00	Str. Oak, 1 ft. diam. on top of prominent point	64	S. 59 1/2° W.	1.93	Stake Station
28	S. 47 1/2° E.	3.50	Oak, 12 in. diam. to Sta. on top of prominent point	126	S. 47 1/2° E.	3.50	Str. on Slope of Hill, on Oak, 1 ft. diam.	65	S. 21 1/2° E.	1.92	Stake Station
29	S. 2 1/2° W.	5.66	Stake Station	127	S. 2 1/2° W.	5.66	0.50 on top of Spur, 30 ft. high, 100 in. Hill, 5.66 to Sta. Oak 3 ft. diam. East side of Hill, 50 ft. high	66	N. 76° E.	2.10	Stake Station
30	S. 67° E.	8.80	Stake Station, on point 50 ft. high, 10 Ch. wide, course North	127	S. 67° E.	8.80	Str. Oak, 1 ft. diam. on top of point 50 ft. high	67	East	3.06	Stake Station
31	S. 50 1/2° E.	9.88	Stake Station	128	S. 50 1/2° E.	9.88	To Station	68	N. 74 1/2° E.	2.83	Stake Station
32	S. 11° E.	2.74	Stake Str.	129	S. 11° E.	2.74	Station	69	S. 31° E.	3.93	Stake Str. on bank of an Arroyo
33	S. 48 1/2° E.	5.10	Oak, 6 in. diam. to Station	130	S. 48 1/2° E.	5.10	Station, Oak, 1/2 ft. diam.	70	N. 82° E.	2.50	Stake Station
34	S. 56 1/2° W.	2.06	Oak, 24 in. diam. Str. on point of Spur 6 Ch. wide, course North	131	S. 56 1/2° W.	2.06	Str. Oak, 2 ft. diam. on Slope of point opposite a Spring	71	S. 70 1/2° E.	2.96	Oak, 12 in. diam. to Str.
35	S. 50 1/2° W.	5.66	Stake Station	132	S. 50 1/2° W.	5.66	Str. Oak, 1 ft. diam. of clear water	72	S. 53° E.	4.50	Sycamore 9 in. diam. to Str.
36	S. 40° E.	1.83	Stake Station	133	S. 40° E.	1.83	Str. Oak, 2 ft. diam.	73	S. 31° E.	3.93	Stake Str.
37	N. 87° E.	4.97	Oak, 24 in. diam. to Station	134	N. 87° E.	4.97	Str. Oak, 2 ft. diam.	74	S. 27 1/2° E.	5.62	Stake Str.
								75	S. 13 1/2° E.	3.03	Stake Str.
								76	S. 23 1/2° E.	2.12	Oak, 12 in. diam. to Station
								77	S. 51° E.	1.82	a blazed Sycamore 16 in. diam.

C.F. 81

2

3

SIERRA

MADRID

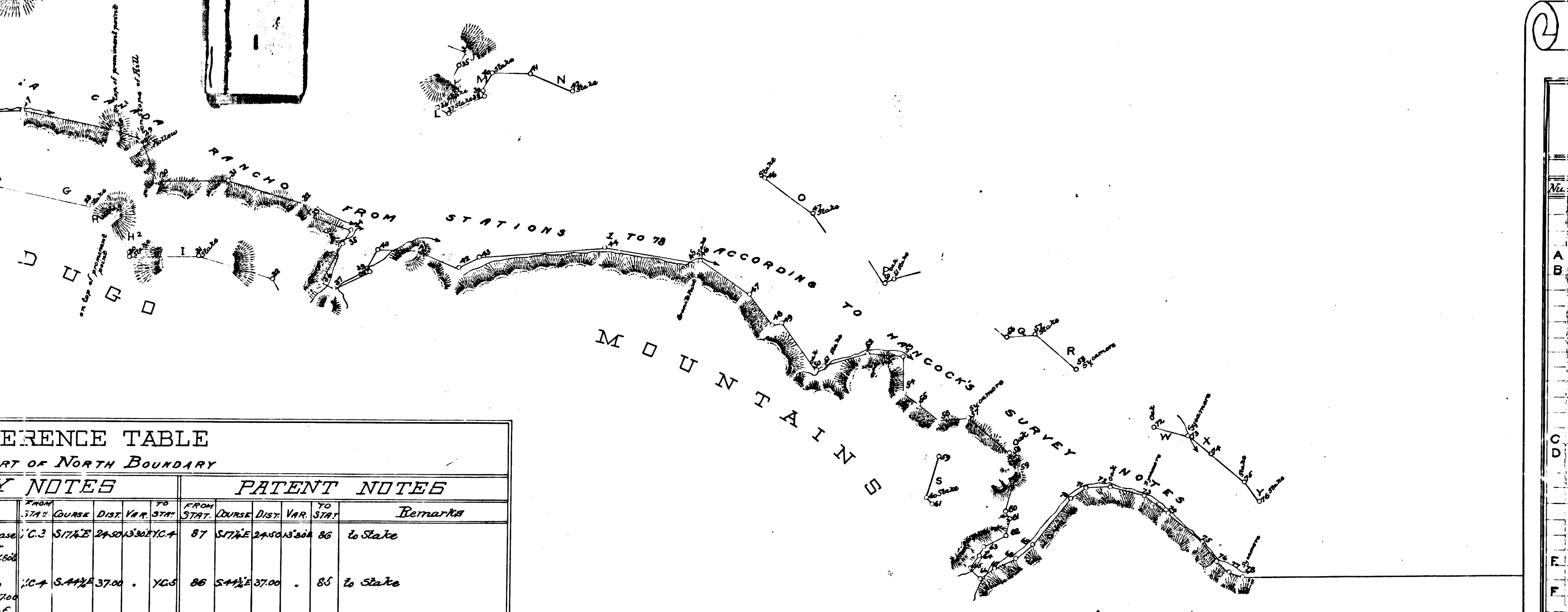
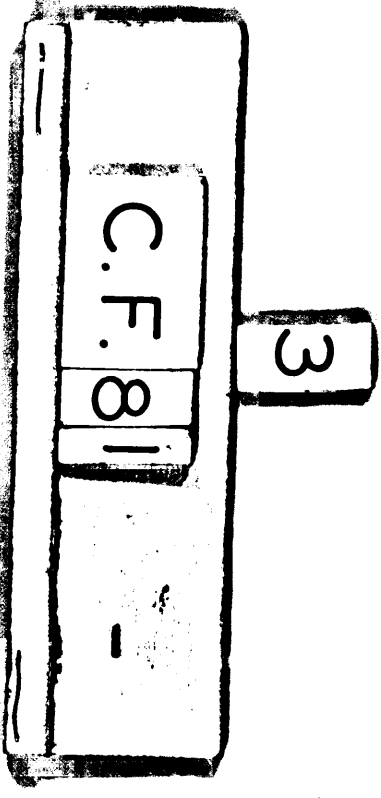
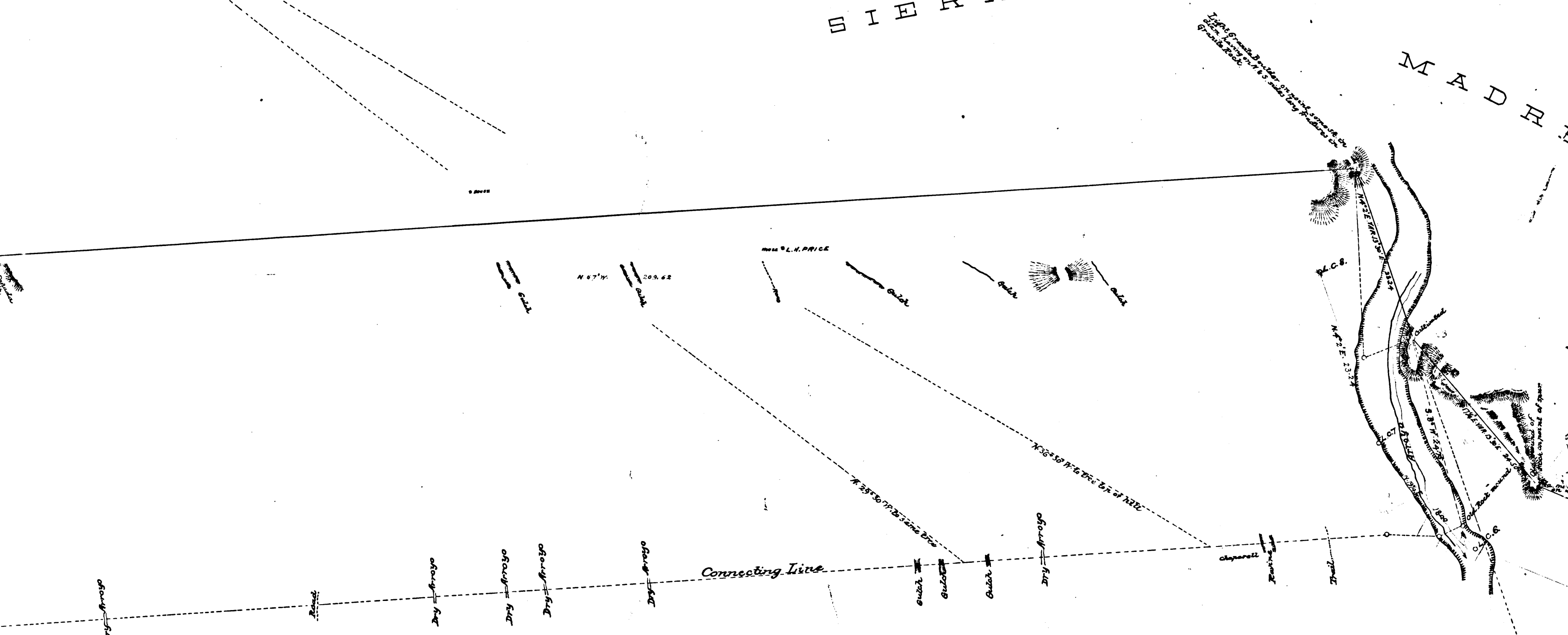

REFERENCE TABLE  
PART OF NORTH BOUNDARY

PATENT NOTES					PATENT NOTES					Remarks
FROM STATION	COURSE	DIST	VAR	TO STATION	FROM STATION	COURSE	DIST	VAR	TO STATION	
Y.C.3	S 77 1/2° E	2450	13 30 E	Y.C.4	87	S 77 1/2° E	2450	13 30 E	86	to State
Y.C.4	S 44 1/2° E	37.00		Y.C.5	86	S 44 1/2° E	37.00		85	to State
Y.C.5	S 29° E	13.50		Y.C.6	85	S 29° E	13.50		84	to State
Y.C.6	S 53 1/2° E	10.50		Y.C.7	84	S 53 1/2° E	10.50		83	to post & charred Stake in irregular mound of rock
Y.C.7	S 51 1/2° E	15.89		Y.C.8	83	S 51 1/2° E	15.89		82	to post and charred Stake in irregular mound of Rock.

Scale: 10 Chains to One Inch.

2  
A  
B  
C  
D  
E  
F  
G  
H  
I  
J  
K  
L  
M  
N  
O  
P  
Q  
R  
S  
T  
U  
V  
W  
X  
Y  
Z

RANCHO TUJUNGA

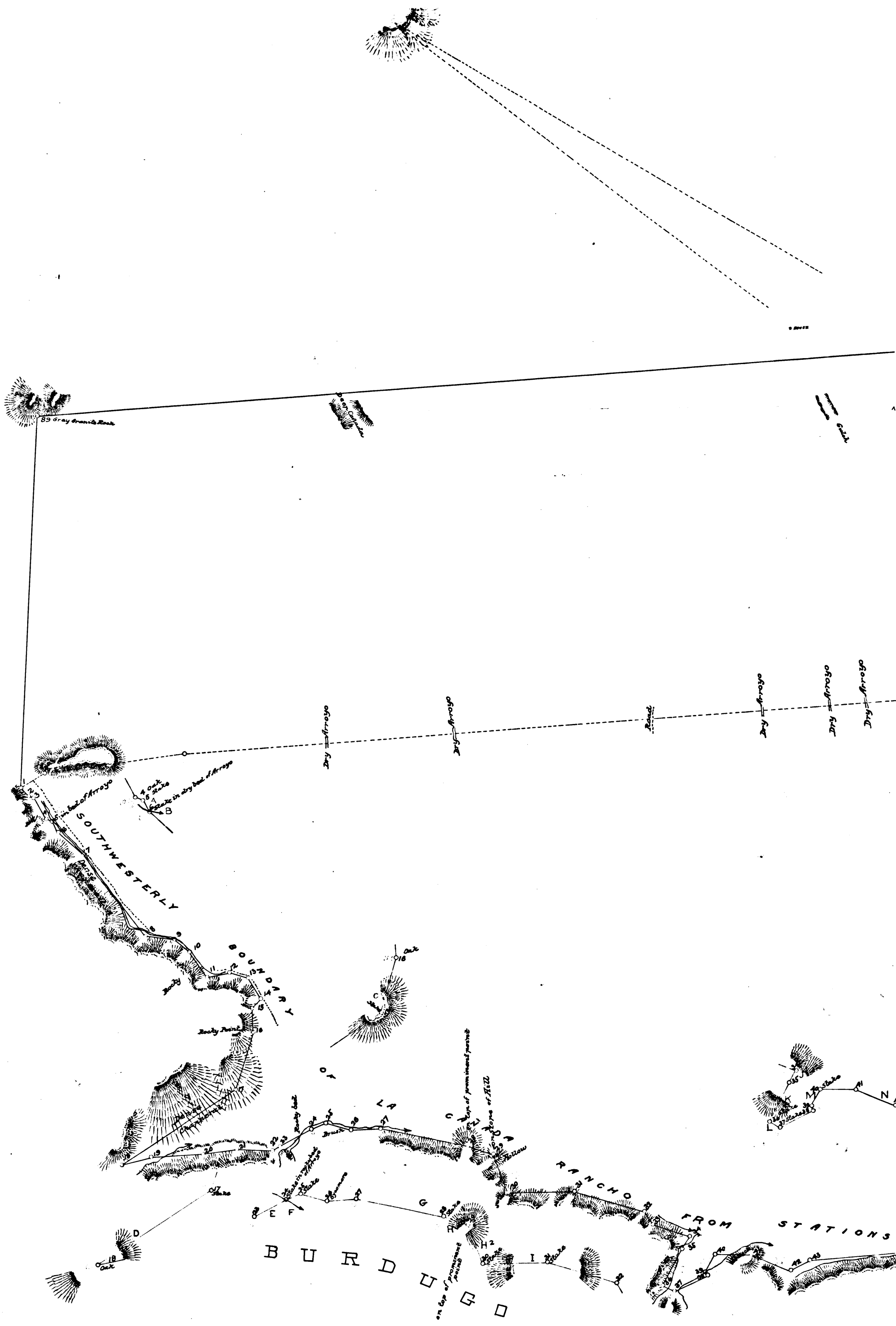

C.F. 81  
4

REFERENCE TABLE TO PART OF NORTH BOUNDARY																	
HANCOCK'S SURVEY NOTES							PATENT NOTES										
FROM STAT.	COURSE	DIST.	YR.	TO STAT.	Remarks	FROM STAT.	COURSE	DIST.	YR.	TO STAT.	Remarks	FROM STAT.	COURSE	DIST.	YR.	TO STAT.	Remarks
YC.3	S.17 1/2° E.	24.50	13.02	YC.4	5.00 top of spur 11.50 base of spur; 24.50 Sta. 28 or YC.7, fr. which bears 4 1/2° 1800 6 S.706.	YC.3	S.17 1/2° E.	24.50	13.02	YC.4	87	S.17 1/2° E.	24.50	13.02	86		to State
YC.4	S.45 1/2° E.	37.00	"	YC.5	5.00 across Arroyo Seco 1/150 to another Arroyo 37.00 to YC.5 on edge of bank of Arroyo de Los Barros fr. which bears 6 1/2° 11.20 11'	YC.4	S.45 1/2° E.	37.00	"	YC.5	86	S.45 1/2° E.	37.00	"	85		to State
YC.5	S.29 1/2° E.	13.15	"	YC.6	1.75 to bottom of Arroyo 5.50 across it, 13.15 to Sta. YC.6	YC.5	S.29 1/2° E.	13.15	"	YC.6	85	S.29 1/2° E.	13.15	"	84		to State
YC.6	S.56 1/2° E.	10.55	"	YC.7		YC.6	S.56 1/2° E.	10.55	"	YC.7	84	S.56 1/2° E.	10.55	"	83		to post & charred stake in regular mound of rock
YC.7	S.31 1/2° E.	15.89	"	YC.8		YC.7	S.31 1/2° E.	15.89	"	YC.8	83	S.31 1/2° E.	15.89	"	82		to post and charred stake in irregular mound of rock.