

T. 1 S. - R. 12 W.
S. B. NO. B. & M.
SECTION 31 SECTION 32

Z
A
R
A
N
Z
O
C
H
I
O

Arcadio B. de Baker

California Railway

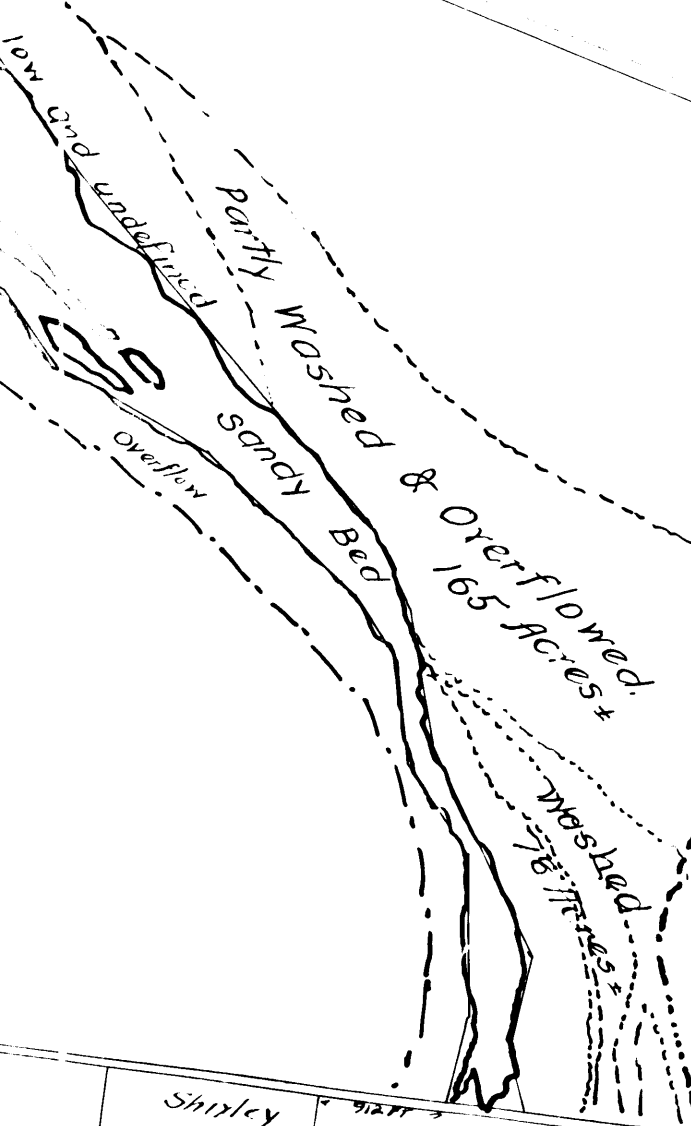

BANDINI STATION
7 1/2 Miles from Los Angeles

To Santa Ana
Baker
vs.
S. Cal Ry Co.
Ex. 6
Filed Oct 19, 1892

C.F. 87

and Channel San Gabriel River

Map
showing
Old and New Channels
of the
Los Angeles River

South of the City of Los Angeles
and their relation to the Railroads and Levees
as at present located
October 10th 1892

Scale 1000 ft to an Inch

Surveyed and Compiled
by Samuels & Coleman

Los Angeles, Cal
Surveyed in May '92.

T. 1 S. - R. 13 W.
S. B. NO. B.
SECTION 31

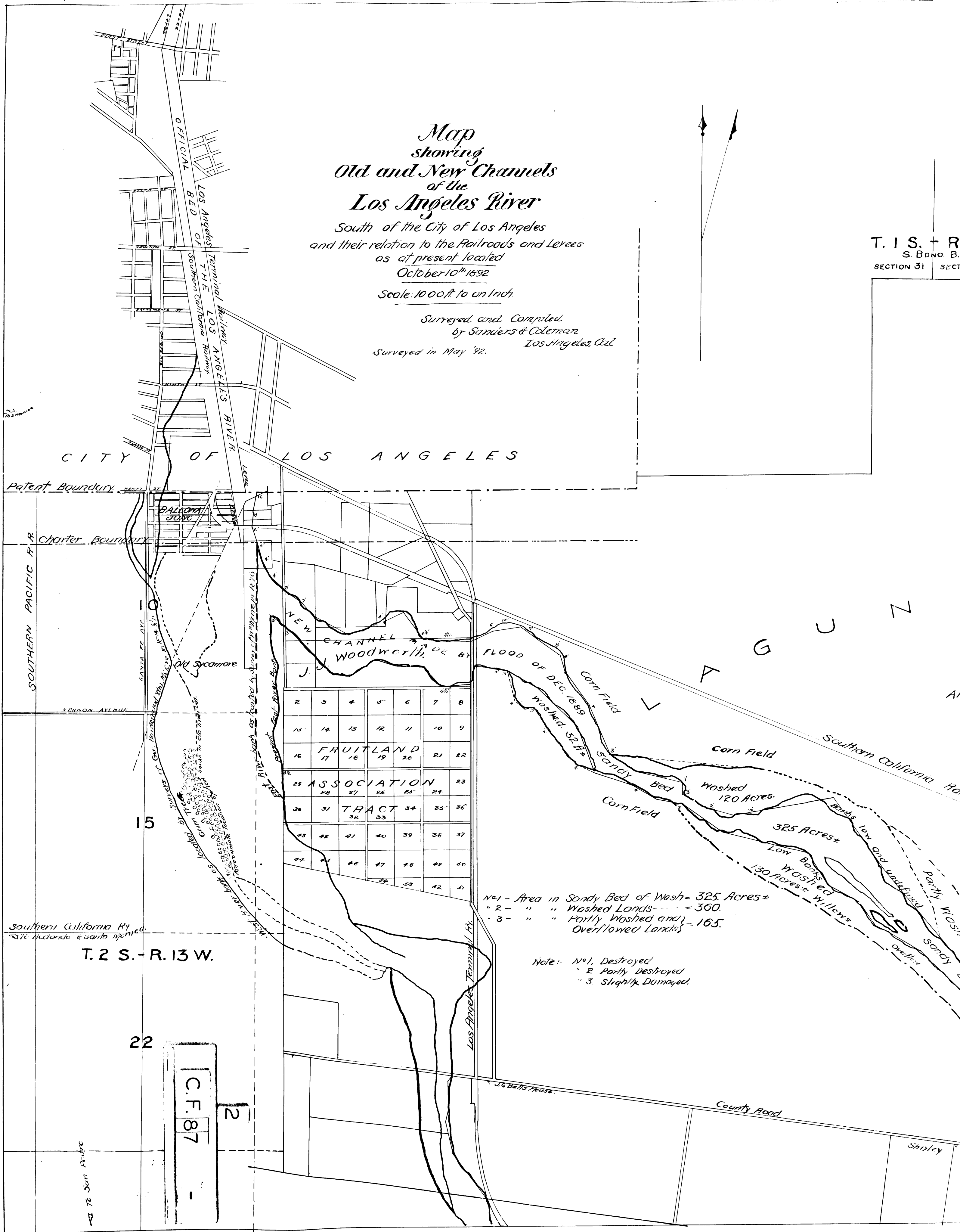

2	3	4	5	6	7	8
15	14	13	12	11	10	9
16	17	18	19	20	21	22
29	30	31	32	33	34	35
36	37	38	39	40	41	42
43	44	45	46	47	48	49
50	51	52	53	54	55	56

No. 1 - Area in Sandy Bed of Wash = 325 Acres ±
 " 2 - " " Washed Lands = 350
 " 3 - " " Partly Washed and Overflowed Lands = 165.

Note: No. 1, Destroyed
 " 2, Partly Destroyed
 " 3, Slightly Damaged.

C.F. 87
 2