

**Map**  
 OF THE PARTITION OF THAT PORTION  
 OF THE

**MIGUEL LEONIS ESTATE**

WHICH LIES IN THE

**RANCHO LAS VIRGENES**

COUNTY OF LOS ANGELES STATE OF CALIFORNIA

**CONSISTING OF LOTS B.C.F AND G OF THE FINAL PARTITION OF SAID RANCHO**

*SURVEYED AND PARTITIONED UNDER THE INSTRUCTIONS OF THE REFEREES IN PARTITION APPOINTED BY THE SUPERIOR COURT OF THE COUNTY OF LOS ANGELES, STATE OF CALIFORNIA IN CASE No 15847 IN THE DOCKET, AND IN CONFORMITY WITH THE INSTRUCTIONS OF SAID SUPERIOR COURT IN APRIL AND MAY 1892 BY*

REFEREE AND SURVEYOR

TRUE COURSES  
 VARIATION 14°30' EAST  
 Scale 8 Chains to One Inch

Land colored  
 Land colored  
 Land colored

is 1<sup>st</sup> Class Land  
 is 2<sup>d</sup> Class Land  
 is 3<sup>d</sup> Class Land

Sht-93,00

C.F. 91

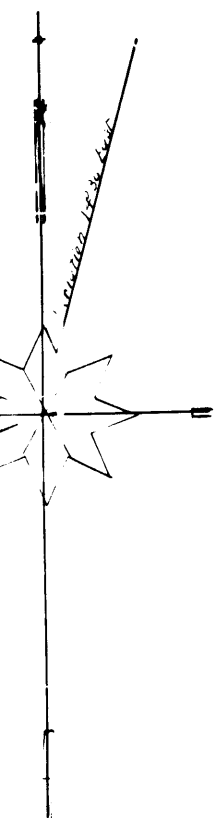

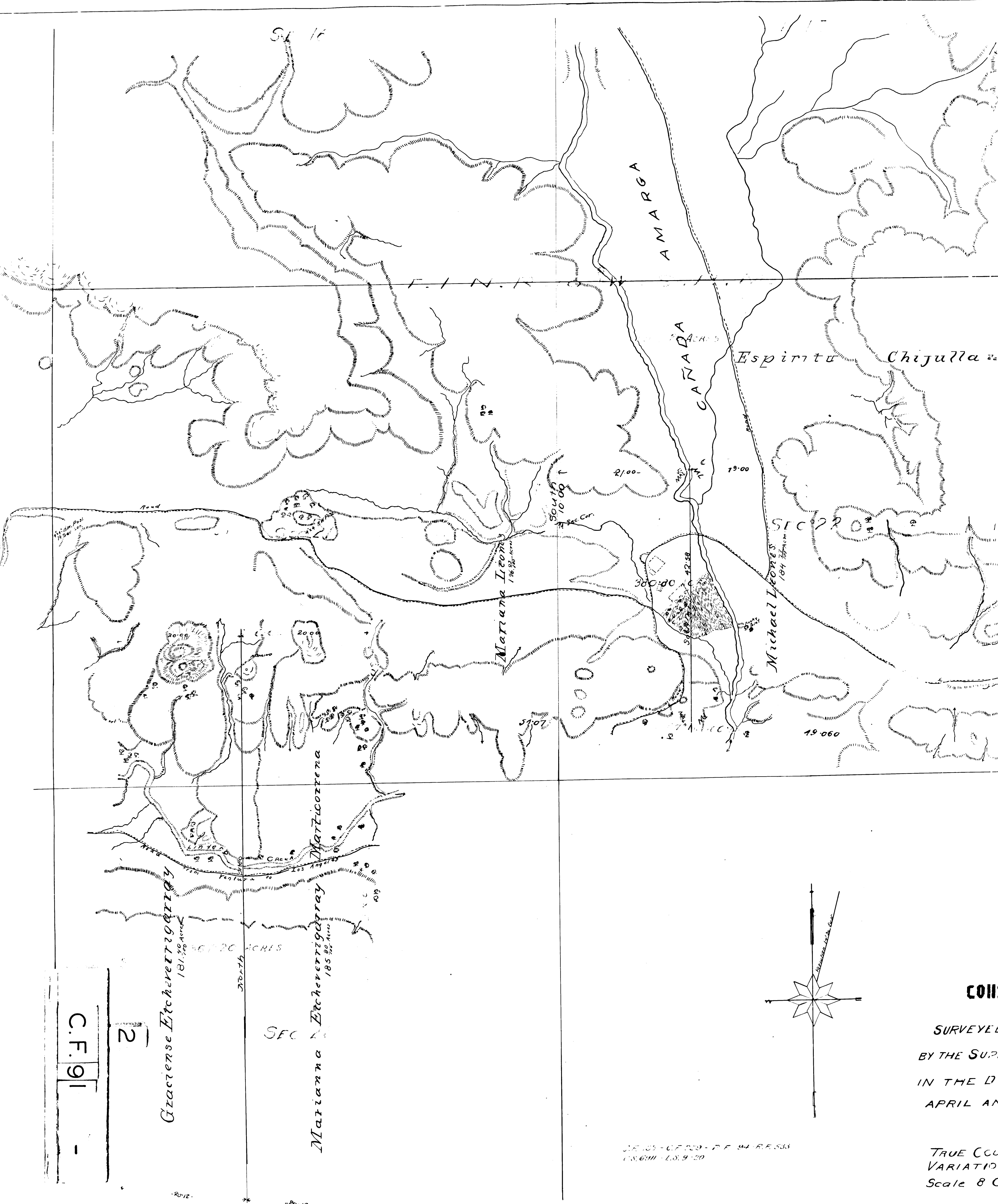

COM

SURVEYED  
BY THE SUR  
IN THE D  
APRIL AN

TRUE COU  
VARIATIO  
Scale 8 C

35 105 - C.F. 91 - P.F. 94 R.E. 533  
C.S. 6711 - L.O. 9-20

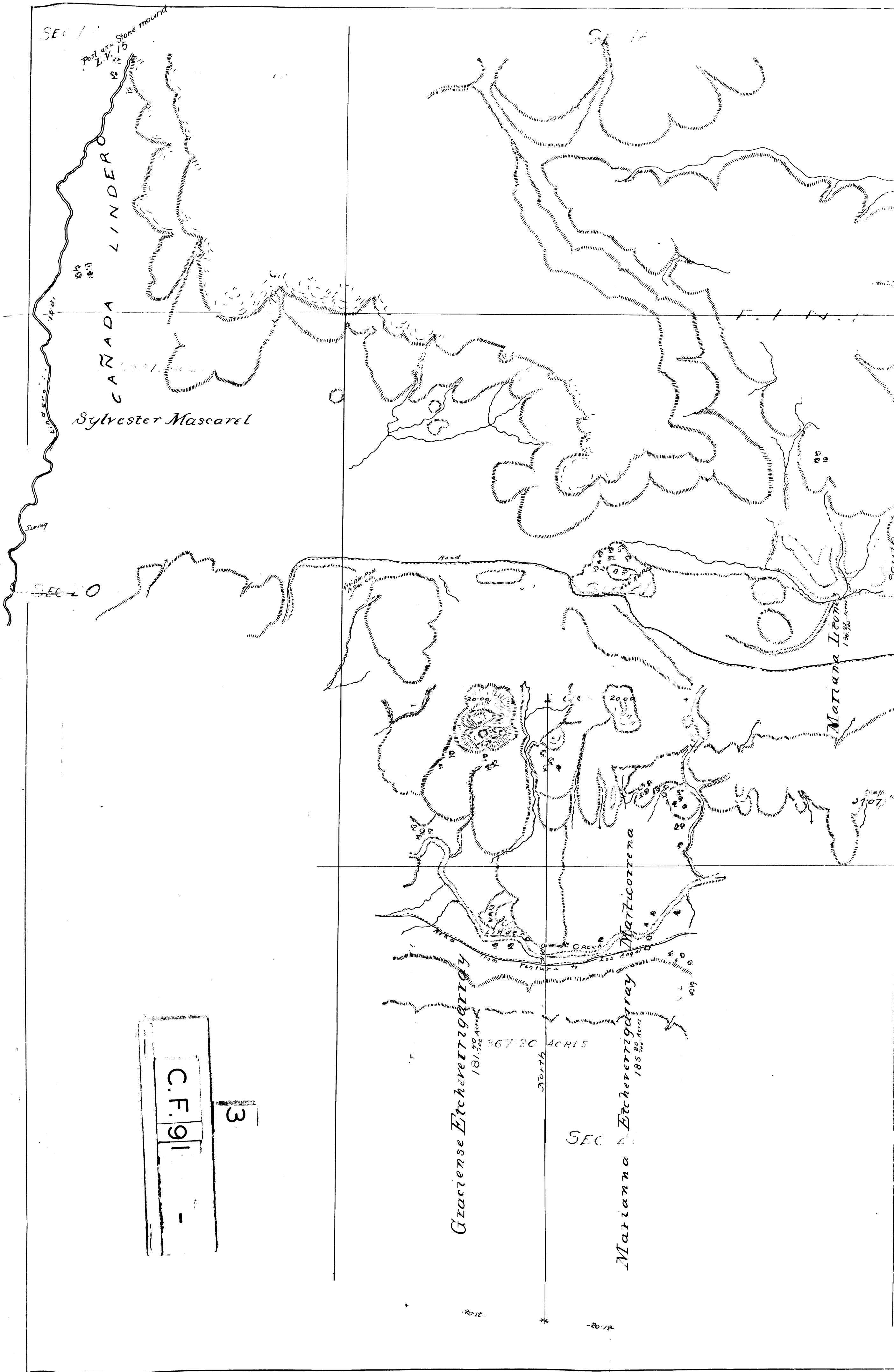

C.F. 91

3