

Scale of 8 Chains to One Inch.

Courses are magnetic  
Var 13° 30' E

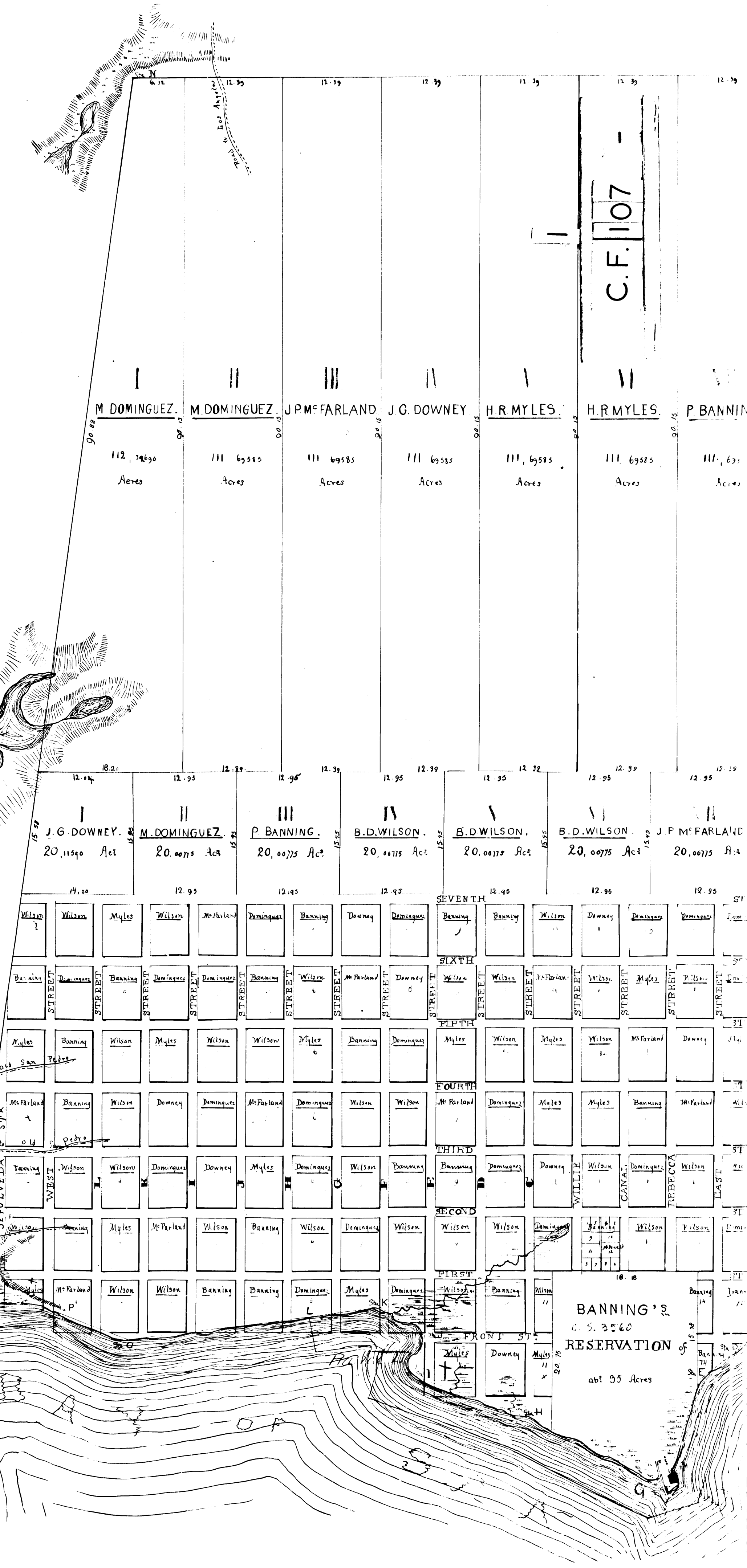
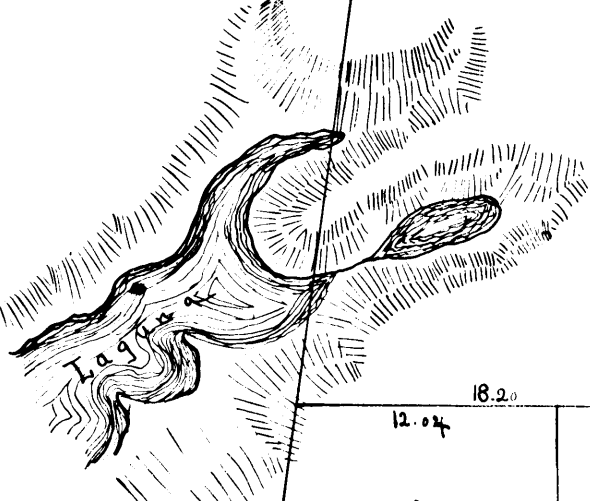
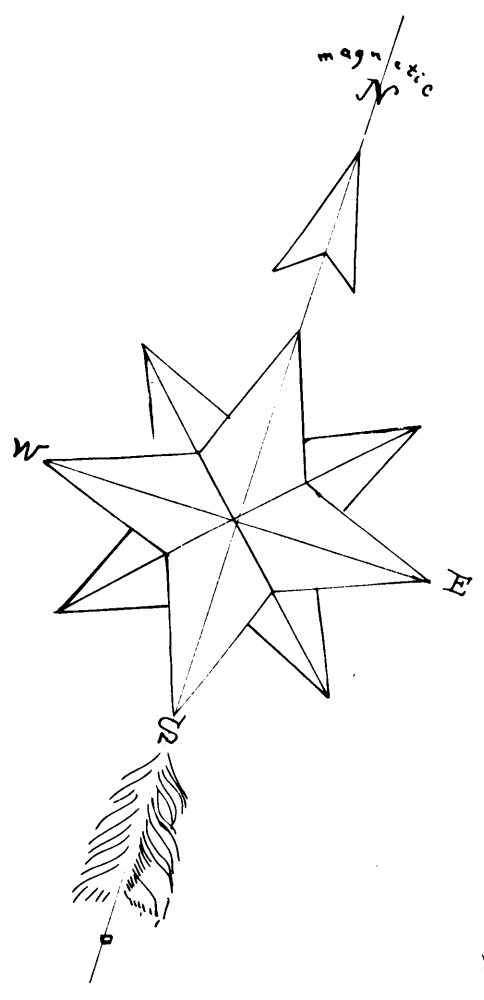

In the District Court of the 1st  
Judicial District, State of Cal-  
ifornia Los Angeles County.

Phineas Banning et al }  
vs } No 877.  
John G. Downey et al. }

We the Referees appointed  
to make partition in the above  
suit, hereby certify this to be the  
crop referred to in our Report of  
partition of this date.

Los Angeles, Oct. 11<sup>th</sup> 1872

John S Griffin  
D. Marchessault  
J. B. Weston

October 31, 1872  
John W. Lyons Clerk  
Joseph H. H. Dr. H. H. H.

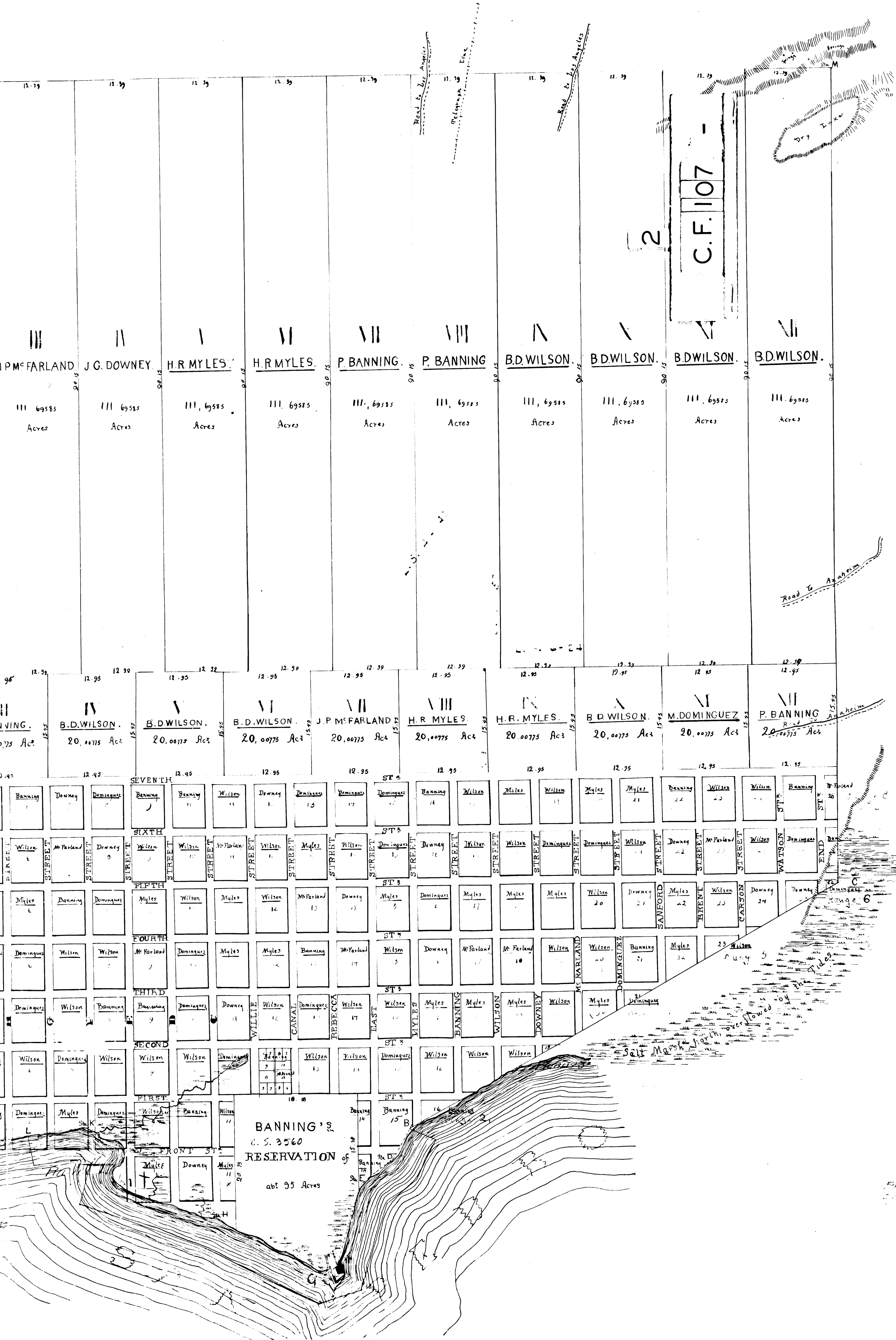

the **B**  
**NEW**  
 show  
 Mr. J. B. Winston, J.  
 Cur

S'	Courses	Dist
N	N 72 35 E	743 0
M	S 47 25 E	122 61
C	S 45 W	75 64
B	S 7 30 W	50 01
D	S 84 W	6 12
E	S	12 24
F	S 57 30 W	2 4
G	N 80 45 W	17 01
H	N 86 15 W	15 7
I	N 2 30 W	5 50
J	N 78 45 W	7 01
K	S 65 45 W	32 01
O	S 88 45 W	10 41
P	S 72 35 W	11 01
A	N 10 15 W	160 01

From Sta. L 8 6 (ac from Sta K on the Distance of One Mile from Highwater Mark, following the said Mean Highwater Line)

Add Area 18

The City, STREETS are of N. 72° 35' E  
 The City BLOCKS are 330 Feet, and are in Range 3, the small LOTS are 115 1/2 Feet

For change of street name...

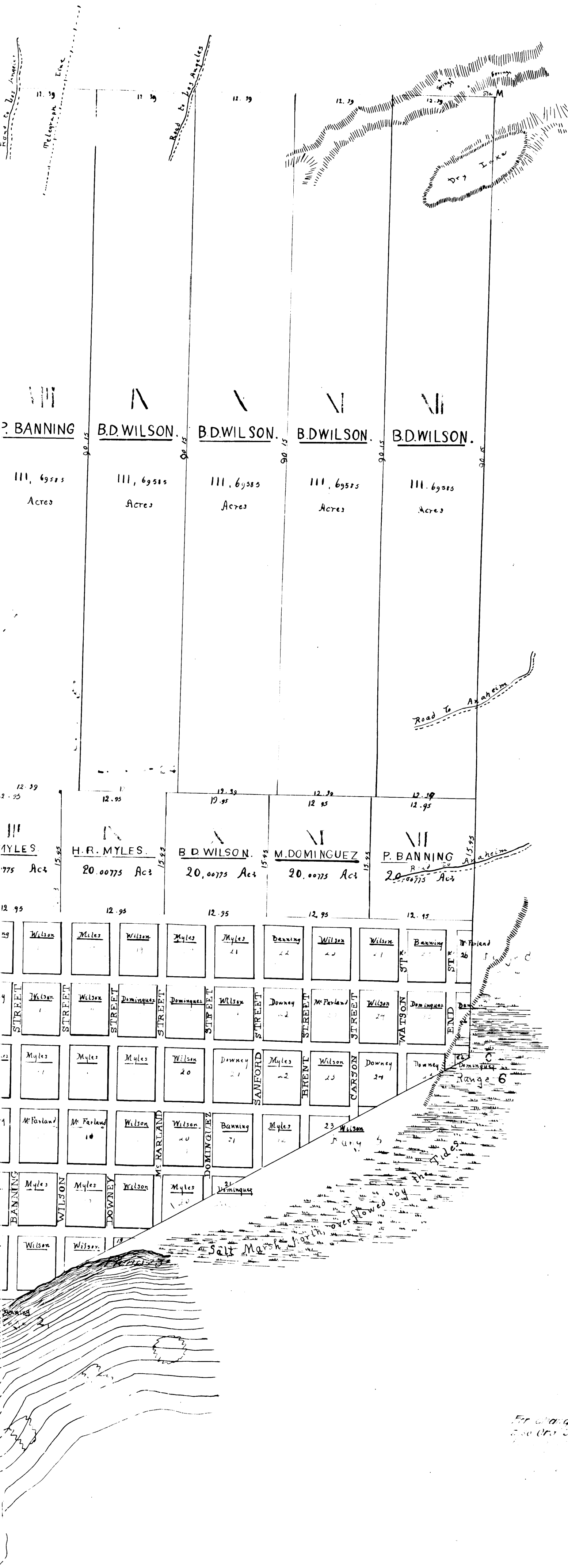

  
 OF  
 the **RANCHO**  
**NEW SAN PEDRO**

showing the proposed  
**Subdivision**  
 by Order of

Messrs J. B. Winston, J. G. Griffin and Damien Marchessault  
 Referees appointed

*Surveyed & Drawn*  
 by  
**FRANK LECOUVREUR.**



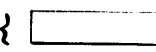
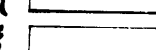
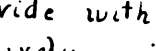

3  
 C.F. 1107

St.	Courses	Dist	Lat.	Dep.	DMD	Area +	Area -
N	N 72° 35' E	743.01	+ 43.03	+ 136.97	+ 136.97	5893.8191	
M	S 47.25 E	122.68	- 116.88	+ 37.05	+ 310.90		36348.5112
C	S 43 W	73.60	- 53.80	- 50.00	+ 298.09		16034.5520
B	S 7.30 W	50.04	- 5.00	- .66	+ 247.38		1236.9000
D	S 84 W	6.18	- 5.39	- 3.55	+ 243.17		1286.3493
E	S	12.20	- 12.20		+ 233.02		2923.3640
F	S 57.50 W	2.48	- 1.33	- 2.07	+ 237.55		312.8415
G	N 80 45 W	17.00	+ 2.73	- 18.70	+ 218.70	597.2634	
H	N 86 15 W	15.75	+ 1.03	- 18.84	+ 186.84	152.0352	
I	N 2.30 W	5.50	+ 5.50	- .24	+ 170.36	938.1000	
J	N 78 45 W	7.00	+ 1.37	- 6.84	+ 163.70	223.9676	
K	S 65 45 W	32.00	- 13.12	- 29.08	+ 127.56		1673.5872
O	S 88 45 W	10.46	- .23	- 10.40	+ 88.02		20.2534
P	S 72 35 W	11.00	- 3.31	- 10.94	+ 67.34		222.4644
A	N 10 15 W	160.00	+ 157.50	- 38.40	+ 28.40	4473.0000	
From Sta. L, 80' due from Sta. K on the Course K to O marks the Distance of One Mile from Station Buley near Highwater Mark, following the Turns and Bends of said Meas. Highwater Turn.						12318.1693	60062.0300
							12318.1693
Double Area Ochs						47743.3787	
Area, Acres						2387.19195	
Add Area of 1 Mile below Highwater Mark from Sta. B to L 100 yards wide.						36,363.60	
<b>TOTAL AREA</b>						<b>2423.55756 A<sup>2</sup></b>	

**EXPLANATION.**

Banning's Reservation .....   
 McDonald's do .....   
 The undivided Rancho ..... 

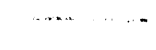
The City STREETS are 1.00 Ch<sup>2</sup> or 66 Feet wide with a magnetic Course of N. 72° 35' E and N 17° 25' W, respectively.  
 The City BLOCKS measure 700 Ch<sup>2</sup> by 5.00 Ch<sup>2</sup> or 469 Feet by 930 Feet and are to be subdivided as shown in Block 12 of Range 3, the ALLEYWAY in the Center being 10 Feet wide.  
 The small LOTS No 1, 2, 3, 4, 5, 6, 7, 8, are 80 Feet Front by 115 1/2 Feet Depth and the large Lots No 9, 10, 11, 12, are 115 1/2 Feet Front by 160 Feet Depth.

B. D. WILSON .....   
 P. BANNING .....   
 H. R. MYLES .....   
 M. DOMINGUEZ .....   
 J. G. DOWNEY .....   
 J. P. MCFARLAND ..... 

For change of street names - ord 33230  
 See Ord 33230 dated 3/15/15 and Ord 33231 dated 3/15/15