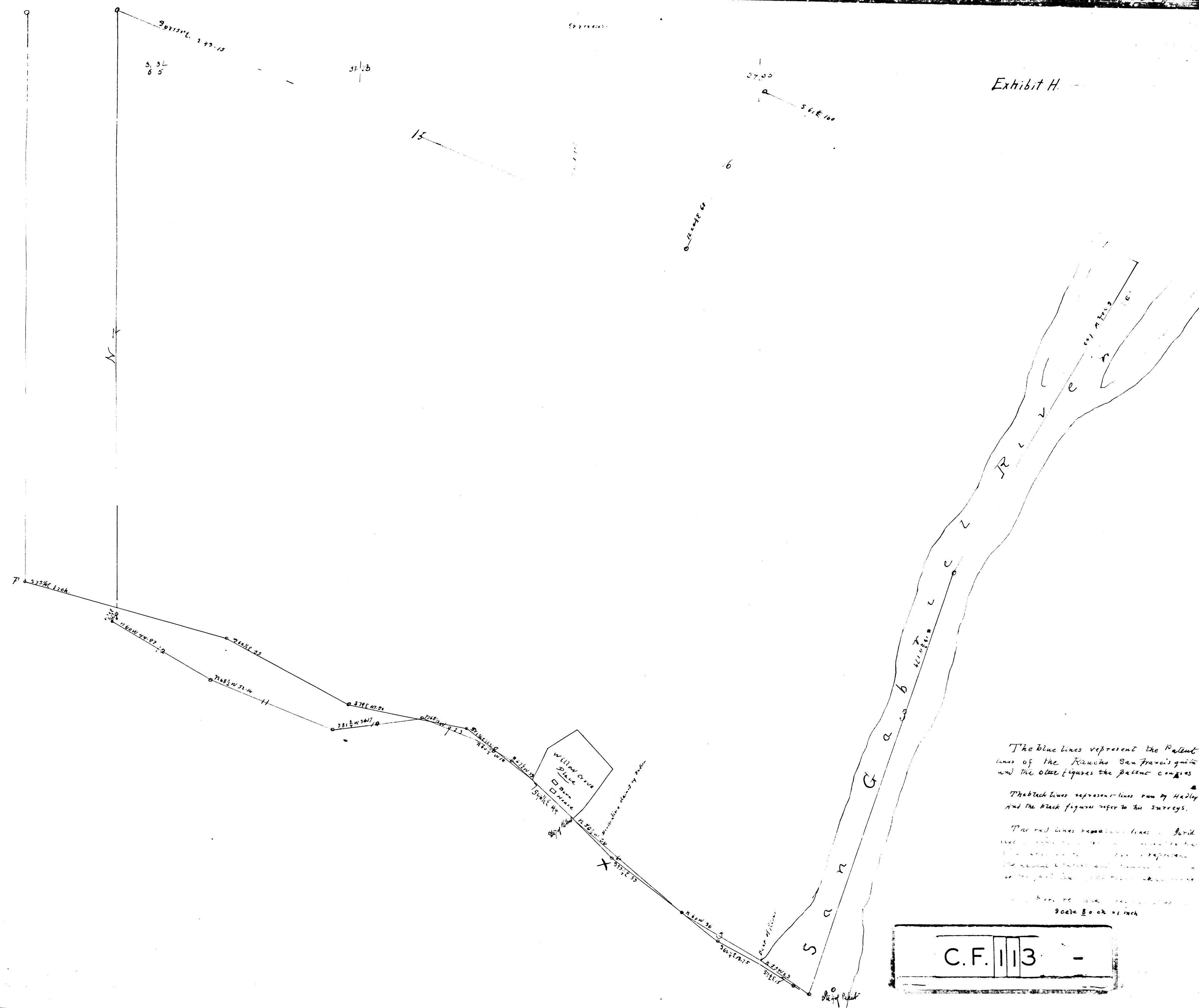

Exhibit H.



The blue lines represent the Patent lines of the Rancho San Francisco and the blue figures the Patent corners.

The black lines represent lines run by Hadley and the black figures refer to his surveys.

The red lines represent lines run by David [unclear] and the red figures refer to his surveys. The red lines represent lines run by [unclear] and the red figures refer to his surveys.

Scale 80 ft = 1 inch

C.F. 113