

Rancho Taujita or Los Cuervos

Rancho San Antonio

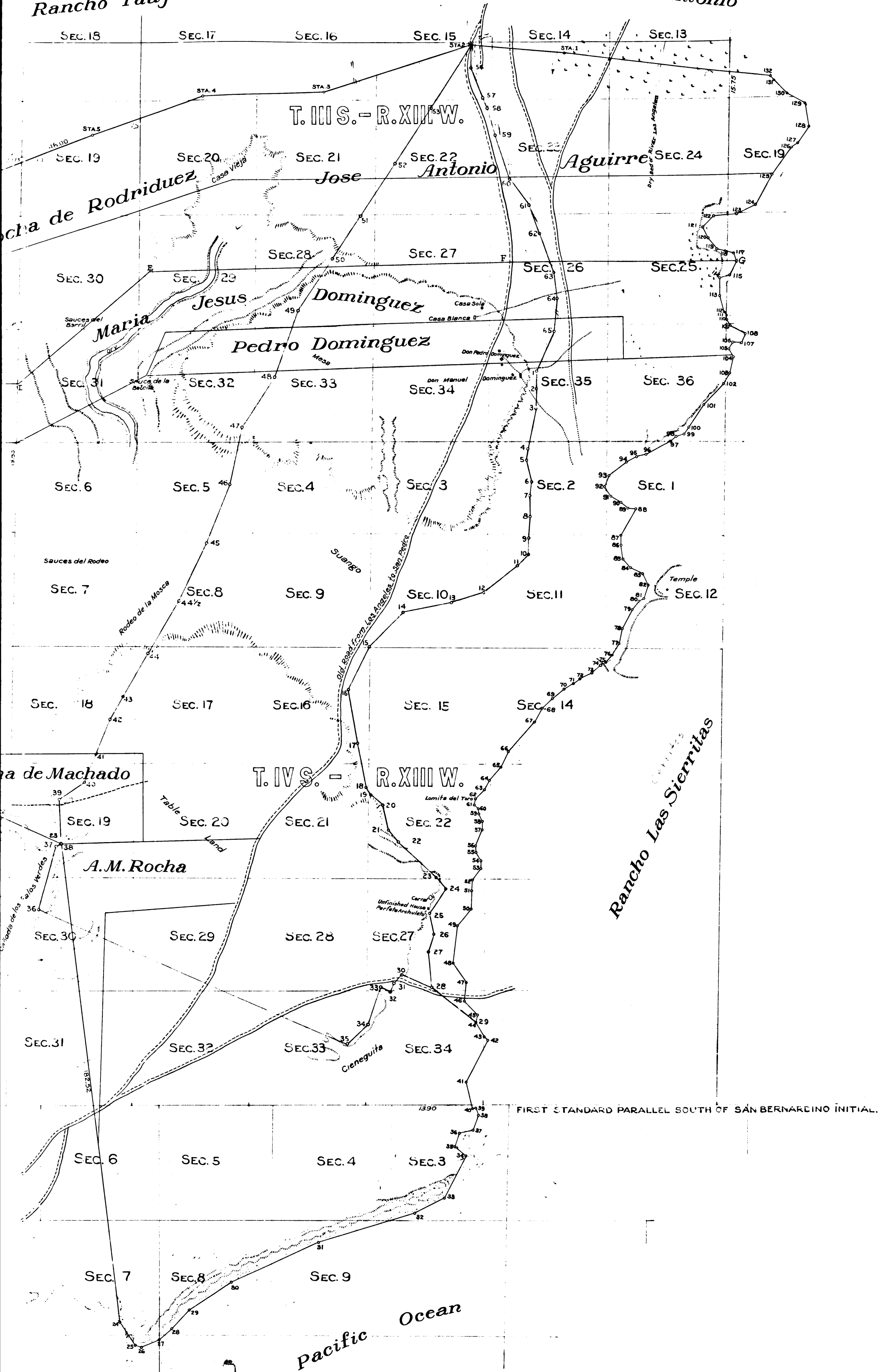

STATIONS	BEARINGS	DISTANCES	STATIONS	BEARINGS	DISTANCES
		CH'S LKS.			CH'S LKS.
1	N.83 1/2°W.	62.03	67	N.30 1/2°E.	11.50
2	S.72°W.	105.60	68	N.44 3/4°E.	9.00
3	S.87°W.	81.10	69	N.48 1/4°E.	11.00
4	S.71 1/4°W.	85.82	70	N.62 1/2°E.	6.20
5	S.67 1/4°W.	84.05	71	N.47 1/2°E.	7.00
6	S.69°W.	261.02	72	N.61 1/2°E.	10.00
7	S.50 1/4°W.	50.50	73	N.47 1/4°E.	7.00
8	S.53 3/4°W.	42.02	74	N.68 1/2°E.	4.80
9	S.58 3/4°W.	64.00	75	N.40 1/2°E.	6.00
10	S.68 3/4°W.	91.00	76	N.24 1/2°E.	10.00
11	S.23 1/4°E.	22.26	77	N.14 3/4°E.	10.80
12	S.26 1/4°E.	8.50	78	N.23 1/2°E.	16.00
13	S.33°E.	20.00	79	N.85 3/4°E.	6.00
14	S.24°E.	30.00	80	N.60°E.	5.00
15	S.7°E.	13.92	81	N.15 1/2°E.	10.00
16	S.2 3/4°W.	25.92	82	N.24°W.	8.50
17	S.3 1/4°W.	20.00	83	N.65 1/4°W.	10.00
18	S.88°E.	32.10	84	N.24°W.	7.62
19	S.84 1/2°E.	185.67	85	N.17°W.	10.00
20	S.77 1/2°E.	138.50	86	N.9 1/2°W.	6.00
21	S.66 1/2°E.	104.61	87	N.28 1/2°E.	21.20
22	S.64 3/4°E.	46.32	88	N.78°W.	6.50
23	S.7°E.	337.20	89	N.55 3/4°W.	8.00
24	S.31 1/2°E.	19.44	90	N.55 3/4°W.	6.00
25	S.68 1/2°E.	3.80	91	N.57 3/4°W.	7.91
26	N.68 1/2°E.	11.31	92	N.15 1/2°E.	8.00
27	N.50°E.	10.50	93	N.52°E.	15.73
28	N.41 1/2°E.	20.00	94	N.57°E.	7.27
29	N.57 1/2°E.	35.00	95	N.77 1/2°E.	6.00
30	N.66°E.	66.00	96	N.56 3/4°E.	18.37
31	N.73°E.	67.00	97	N.57°E.	3.76
32	N.61 1/2°E.	23.00	98	N.79°E.	6.31
33	N.27 1/2°E.	35.50	99	N.43 1/4°E.	5.17
34	N.49°W.	10.00	100	N.30°E.	19.63
35	N.18 1/2°E.	9.00	101	N.43 3/4°E.	18.80
36	N.75 1/4°E.	10.00	102	N.76 1/4°E.	7.30
37	N.14 1/4°E.	11.50	103	N.18 1/2°E.	14.40
38	N.16 1/4°W.	4.50	104	N.26 1/4°W.	5.50
39	S.65°W.	2.30	105	N.20°E.	5.00
40	N.15 1/2°W.	19.00	106	S.89°E.	6.40
41	N.24 1/2°E.	33.50	107	N.16 3/4°E.	7.40
42	N.49°W.	3.50	108	N.57 1/4°W.	10.81
43	N.26 1/2°W.	12.00	109	N.24 1/4°W.	4.50
44	N.10°E.	4.22	110	N.9 1/2°W.	2.94
45	N.48 1/2°W.	13.00	111	N.51 3/4°W.	1.70
46	N.3 3/4°E.	13.50	112	N.19 1/2°E.	11.00
47	N.33 1/4°W.	15.70	113	N.5°W.	13.50
48	N.6°E.	26.50	114	N.73 1/2°E.	7.00
49	N.36 1/4°E.	15.50	115	N.26°E.	11.89
50	N.1 1/4°W.	12.00	116	N.26 1/2°W.	5.21
51	N.7°E.	8.00	117	N.60°W.	5.00
52	N.30 1/2°E.	10.00	118	N.74 3/4°W.	7.53
53	N.5°E.	5.18	119	N.36 1/2°W.	11.35
54	N.32 3/4°W.	7.50	120	N.21 1/2°W.	6.00
55	N.1°E.	4.00	121	N.39 1/2°E.	9.43
56	N.22°E.	12.50	122	N.85°E.	15.97
57	N.1°W.	6.50	123	N.63 1/2°E.	14.41
58	N.26 1/2°W.	5.13	124	N.27 1/2°E.	24.68
59	N.1°E.	3.87	125	N.34 1/2°E.	24.15
60	N.45°W.	4.40	126	N.54 1/2°E.	4.50
61	N.5°E.	3.50	127	N.30 1/2°E.	14.50
62	N.46°E.	8.30	128	N.12°W.	16.00
63	N.26°E.	7.20	129	N.63 3/4°W.	11.50
64	N.40 1/2°E.	11.58	130	N.44°W.	14.60
65	N.25°E.	10.50	131	N.58°W.	3.50
66	N.40 1/2°E.	26.60	132	N.83 1/2°W.	140.98

Area 44218.82/100 Acres
 Saltworks 214 1/2
 Newtown 2400
 Bay about 1604 3/100 Acres

C.F. 118 -

Rancho Taujita or Los Cuervos

T. III S. - R. XIV W.

T. III S. - R. XIII W.

T. IV S. - R. XIV W.

T. IV S. - R. XIII W.

ions of Col. J.C. Hayes
ry Hancock
U.S. Dep. Surveyor
by

o F.
t
e
y 1856

Rancho Sausal Redondo

Rocha de Rodriguez

Concepcion

Jose Antonio

Maria Jesus

Dominguez

Pedro Dominguez

M. Rocha de Machado

A.M. Rocha

Pacific Ocean

State of California }
County of Los Angeles } ss.
I, George Hansen, Surveyor for the referees in the
tion of partition of the rancho of "San Pedro" or "Dominguez rancho"
the District Court of the first Judicial District; in and for
County of Los Angeles, do hereby certify that the present is an
and perfect copy of the map made by me for said referees
under their direction and referred to by them in their Report
in the final judgment of said Court. Signed at the
City of Los Angeles, this July 16th A.D. 1877

Geo Hansen.
Land Surveyor.

scribed and sworn
me this 16th July 1877
H. W. Sells County Clerk
By [Signature] Deputy

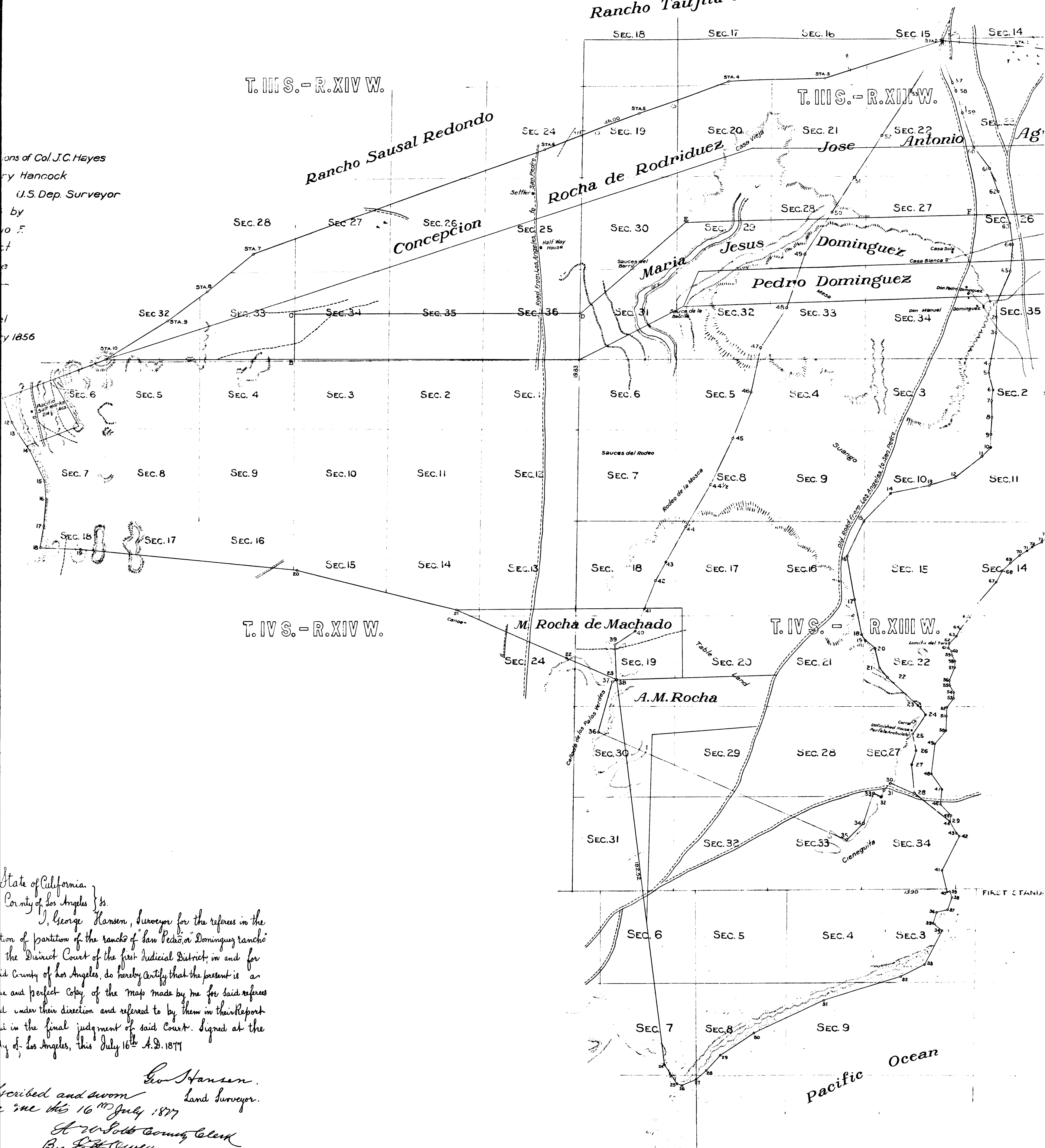

MAP
of
RANCHO
SAN PEDRO

T. III S. - R. XIV W.

Situated in the County of Los Angeles, California
Claimed by Manuel Dominguez et al and at his request surveyed in conformity with instructions of Col. J.C. Hayes
U.S. Surveyor General for the State of California of Date Feb 9th 1855 by Henry Hancock

U.S. Dep. Surveyor

The lines preparatory to the subdivision surveyed in Nov. 1855 by
G. Hansen, a surveyor appointed to Ygnacio del Valle, Antonio F.
Coronel & Augustin Olvera, referees appointed by the District
Court of the 1st Judicial District in and for said County for the
purpose of making a partition of said tract of land in con-
formity with a decree of said Court

The lines of Subdivision surveyed on request of Don Manuel
Dominguez & Don Jose Antonio Aguirre in the month of January 1856
by said G. Hansen under the above mentioned appointment.

Rancho Sausal Redondo

Concepcion

STATION	MAGN BEARINGS	TRUE BEARINGS	DISTANCE	STATIONS	TRUE BEARINGS	DISTANCE	STATIONS	BEARINGS	DISTANCE	
LINES RUN PREPARATORY TO SUBDIVISION										
1	S. 1 1/2° E.		110.0	BOUNDARIES OF THE TRACT OF ANTONIO M. ROCHA						
2	S. 12 1/4° E.		130.0	BOUNDARIES OF THE SUM OF THE TRACTS OF CONCEPCION ROCHA de RODRIGUEZ & JOSE ANTONIO AGUIRRE						
3	S. 1 1/2° E.		28.00	BOUNDARIES OF THE TRACT OF MARIA ROCHA & MACADD						
4	S. 1 1/2° E.		5.50	BOUNDARIES OF THE SUM OF THE TRACTS OF PEDRO DOMINGUEZ & MARIA JESUS DOMINGUEZ SAUCES de la BOLSITA						
5	S. 3 1/4° E.		15.00	BOUNDARIES OF THE SUM OF THE TRACTS OF PEDRO DOMINGUEZ & MARIA JESUS DOMINGUEZ SAUCES de la BOLSITA						
6	S. 3° E.		10.00	BOUNDARIES OF THE SUM OF THE TRACTS OF PEDRO DOMINGUEZ & MARIA JESUS DOMINGUEZ SAUCES de la BOLSITA						
7	S. 17° E.		15.00	BOUNDARIES OF THE SUM OF THE TRACTS OF PEDRO DOMINGUEZ & MARIA JESUS DOMINGUEZ SAUCES de la BOLSITA						
8	S. 11 1/4° E.		13.50	BOUNDARIES OF THE SUM OF THE TRACTS OF PEDRO DOMINGUEZ & MARIA JESUS DOMINGUEZ SAUCES de la BOLSITA						
9	S. 1 1/4° E.		14.00	BOUNDARIES OF THE SUM OF THE TRACTS OF PEDRO DOMINGUEZ & MARIA JESUS DOMINGUEZ SAUCES de la BOLSITA						
10	S. 26 1/2° W.		11.50	BOUNDARIES OF THE SUM OF THE TRACTS OF PEDRO DOMINGUEZ & MARIA JESUS DOMINGUEZ SAUCES de la BOLSITA						
11	S. 39 1/2° W.		30.00	BOUNDARIES OF THE SUM OF THE TRACTS OF PEDRO DOMINGUEZ & MARIA JESUS DOMINGUEZ SAUCES de la BOLSITA						
12	S. 58° W.		26.00	BOUNDARIES OF THE SUM OF THE TRACTS OF PEDRO DOMINGUEZ & MARIA JESUS DOMINGUEZ SAUCES de la BOLSITA						
13	S. 64° W.		31.00	BOUNDARIES OF THE SUM OF THE TRACTS OF PEDRO DOMINGUEZ & MARIA JESUS DOMINGUEZ SAUCES de la BOLSITA						
14	S. 25 1/2° W.		30.00	BOUNDARIES OF THE SUM OF THE TRACTS OF PEDRO DOMINGUEZ & MARIA JESUS DOMINGUEZ SAUCES de la BOLSITA						
15	S. 12° W.		31.00	BOUNDARIES OF THE SUM OF THE TRACTS OF PEDRO DOMINGUEZ & MARIA JESUS DOMINGUEZ SAUCES de la BOLSITA						
16	S. 23 1/2° E.		39.00	BOUNDARIES OF THE SUM OF THE TRACTS OF PEDRO DOMINGUEZ & MARIA JESUS DOMINGUEZ SAUCES de la BOLSITA						
17	S. 25 1/2° E.		31.00	BOUNDARIES OF THE SUM OF THE TRACTS OF PEDRO DOMINGUEZ & MARIA JESUS DOMINGUEZ SAUCES de la BOLSITA						
18	S. 43 1/2° E.		6.00	BOUNDARIES OF THE SUM OF THE TRACTS OF PEDRO DOMINGUEZ & MARIA JESUS DOMINGUEZ SAUCES de la BOLSITA						
19	S. 60 1/2° E.		11.00	BOUNDARIES OF THE SUM OF THE TRACTS OF PEDRO DOMINGUEZ & MARIA JESUS DOMINGUEZ SAUCES de la BOLSITA						
20	S. 28 1/2° E.		20.00	BOUNDARIES OF THE SUM OF THE TRACTS OF PEDRO DOMINGUEZ & MARIA JESUS DOMINGUEZ SAUCES de la BOLSITA						
21	S. 63° E.		11.00	BOUNDARIES OF THE SUM OF THE TRACTS OF PEDRO DOMINGUEZ & MARIA JESUS DOMINGUEZ SAUCES de la BOLSITA						
22	S. 58 1/2° E.		38.50	BOUNDARIES OF THE SUM OF THE TRACTS OF PEDRO DOMINGUEZ & MARIA JESUS DOMINGUEZ SAUCES de la BOLSITA						
23	S. 50 1/2° E.		8.50	BOUNDARIES OF THE SUM OF THE TRACTS OF PEDRO DOMINGUEZ & MARIA JESUS DOMINGUEZ SAUCES de la BOLSITA						
24	S. 19 1/2° W.		20.00	BOUNDARIES OF THE SUM OF THE TRACTS OF PEDRO DOMINGUEZ & MARIA JESUS DOMINGUEZ SAUCES de la BOLSITA						
25	S. 26 1/2° E.		15.00	BOUNDARIES OF THE SUM OF THE TRACTS OF PEDRO DOMINGUEZ & MARIA JESUS DOMINGUEZ SAUCES de la BOLSITA						
26	S. 2 1/2° E.		11.00	BOUNDARIES OF THE SUM OF THE TRACTS OF PEDRO DOMINGUEZ & MARIA JESUS DOMINGUEZ SAUCES de la BOLSITA						
27	S. 14 1/2° E.		27.00	BOUNDARIES OF THE SUM OF THE TRACTS OF PEDRO DOMINGUEZ & MARIA JESUS DOMINGUEZ SAUCES de la BOLSITA						
28	S. 65 1/2° E.		40.50	BOUNDARIES OF THE SUM OF THE TRACTS OF PEDRO DOMINGUEZ & MARIA JESUS DOMINGUEZ SAUCES de la BOLSITA						
29	S. 1 1/2° W.		1.50	BOUNDARIES OF THE SUM OF THE TRACTS OF PEDRO DOMINGUEZ & MARIA JESUS DOMINGUEZ SAUCES de la BOLSITA						
30	S. 18 1/2° W.		21.00	BOUNDARIES OF THE SUM OF THE TRACTS OF PEDRO DOMINGUEZ & MARIA JESUS DOMINGUEZ SAUCES de la BOLSITA						
31	S. 26° W.		8.00	BOUNDARIES OF THE SUM OF THE TRACTS OF PEDRO DOMINGUEZ & MARIA JESUS DOMINGUEZ SAUCES de la BOLSITA						
32	S. 31 1/2° W.		6.50	BOUNDARIES OF THE SUM OF THE TRACTS OF PEDRO DOMINGUEZ & MARIA JESUS DOMINGUEZ SAUCES de la BOLSITA						
33	S. 64° W.		7.00	BOUNDARIES OF THE SUM OF THE TRACTS OF PEDRO DOMINGUEZ & MARIA JESUS DOMINGUEZ SAUCES de la BOLSITA						
34	S. 4° W.		27.00	BOUNDARIES OF THE SUM OF THE TRACTS OF PEDRO DOMINGUEZ & MARIA JESUS DOMINGUEZ SAUCES de la BOLSITA						
35	S. 30 1/2° W.		18.00	BOUNDARIES OF THE SUM OF THE TRACTS OF PEDRO DOMINGUEZ & MARIA JESUS DOMINGUEZ SAUCES de la BOLSITA						
36	S. 80° W.		2.28 70	BOUNDARIES OF THE SUM OF THE TRACTS OF PEDRO DOMINGUEZ & MARIA JESUS DOMINGUEZ SAUCES de la BOLSITA						
37	S. 1 1/2° E.		43.00	BOUNDARIES OF THE SUM OF THE TRACTS OF PEDRO DOMINGUEZ & MARIA JESUS DOMINGUEZ SAUCES de la BOLSITA						
38	S. 50° E.		3.30	BOUNDARIES OF THE SUM OF THE TRACTS OF PEDRO DOMINGUEZ & MARIA JESUS DOMINGUEZ SAUCES de la BOLSITA						
39	S. 15 1/2° W.		31.00	BOUNDARIES OF THE SUM OF THE TRACTS OF PEDRO DOMINGUEZ & MARIA JESUS DOMINGUEZ SAUCES de la BOLSITA						
40	S. 41 1/2° E.		21.00	BOUNDARIES OF THE SUM OF THE TRACTS OF PEDRO DOMINGUEZ & MARIA JESUS DOMINGUEZ SAUCES de la BOLSITA						
41	S. 1 1/2° E.		25.00	BOUNDARIES OF THE SUM OF THE TRACTS OF PEDRO DOMINGUEZ & MARIA JESUS DOMINGUEZ SAUCES de la BOLSITA						
42	S. 15 1/2° E.		19.00	BOUNDARIES OF THE SUM OF THE TRACTS OF PEDRO DOMINGUEZ & MARIA JESUS DOMINGUEZ SAUCES de la BOLSITA						
43	S. 14 1/2° E.		34.00	BOUNDARIES OF THE SUM OF THE TRACTS OF PEDRO DOMINGUEZ & MARIA JESUS DOMINGUEZ SAUCES de la BOLSITA						
44	S. 17° E.		14.00	BOUNDARIES OF THE SUM OF THE TRACTS OF PEDRO DOMINGUEZ & MARIA JESUS DOMINGUEZ SAUCES de la BOLSITA						
45	S. 9 1/4° E.		75.00	BOUNDARIES OF THE SUM OF THE TRACTS OF PEDRO DOMINGUEZ & MARIA JESUS DOMINGUEZ SAUCES de la BOLSITA						
46	S. 6° E.		42.00	BOUNDARIES OF THE SUM OF THE TRACTS OF PEDRO DOMINGUEZ & MARIA JESUS DOMINGUEZ SAUCES de la BOLSITA						
47	S. 1 1/4° W.		40.00	BOUNDARIES OF THE SUM OF THE TRACTS OF PEDRO DOMINGUEZ & MARIA JESUS DOMINGUEZ SAUCES de la BOLSITA						
48	S. 11 1/2° E.		38.00	BOUNDARIES OF THE SUM OF THE TRACTS OF PEDRO DOMINGUEZ & MARIA JESUS DOMINGUEZ SAUCES de la BOLSITA						
49	S. 1° E.		49.00	BOUNDARIES OF THE SUM OF THE TRACTS OF PEDRO DOMINGUEZ & MARIA JESUS DOMINGUEZ SAUCES de la BOLSITA						
50	S. 17 1/2° E.		43.00	BOUNDARIES OF THE SUM OF THE TRACTS OF PEDRO DOMINGUEZ & MARIA JESUS DOMINGUEZ SAUCES de la BOLSITA						
51	S. 17 1/2° E.		35.00	BOUNDARIES OF THE SUM OF THE TRACTS OF PEDRO DOMINGUEZ & MARIA JESUS DOMINGUEZ SAUCES de la BOLSITA						
52	S. 19 1/2° E.		44.00	BOUNDARIES OF THE SUM OF THE TRACTS OF PEDRO DOMINGUEZ & MARIA JESUS DOMINGUEZ SAUCES de la BOLSITA						
53	S. 19° E.		45.00	BOUNDARIES OF THE SUM OF THE TRACTS OF PEDRO DOMINGUEZ & MARIA JESUS DOMINGUEZ SAUCES de la BOLSITA						
54	S. 19° E.		5080	BOUNDARIES OF THE SUM OF THE TRACTS OF PEDRO DOMINGUEZ & MARIA JESUS DOMINGUEZ SAUCES de la BOLSITA						
55	S. 19° E.		2.13	BOUNDARIES OF THE SUM OF THE TRACTS OF PEDRO DOMINGUEZ & MARIA JESUS DOMINGUEZ SAUCES de la BOLSITA						
56	S. 5 1/2° E.		14.00	BOUNDARIES OF THE SUM OF THE TRACTS OF PEDRO DOMINGUEZ & MARIA JESUS DOMINGUEZ SAUCES de la BOLSITA						
57	S. 33 1/2° E.		19.00	BOUNDARIES OF THE SUM OF THE TRACTS OF PEDRO DOMINGUEZ & MARIA JESUS DOMINGUEZ SAUCES de la BOLSITA						
58	S. 36 1/2° E.		11.00	BOUNDARIES OF THE SUM OF THE TRACTS OF PEDRO DOMINGUEZ & MARIA JESUS DOMINGUEZ SAUCES de la BOLSITA						
59	S. 30 1/2° E.		18.00	BOUNDARIES OF THE SUM OF THE TRACTS OF PEDRO DOMINGUEZ & MARIA JESUS DOMINGUEZ SAUCES de la BOLSITA						
60	S. 48° E.		32.00	BOUNDARIES OF THE SUM OF THE TRACTS OF PEDRO DOMINGUEZ & MARIA JESUS DOMINGUEZ SAUCES de la BOLSITA						
61	S. 30 1/2° E.		25.00	BOUNDARIES OF THE SUM OF THE TRACTS OF PEDRO DOMINGUEZ & MARIA JESUS DOMINGUEZ SAUCES de la BOLSITA						
62	S. 33 1/2° E.		20.00	BOUNDARIES OF THE SUM OF THE TRACTS OF PEDRO DOMINGUEZ & MARIA JESUS DOMINGUEZ SAUCES de la BOLSITA						
63	S. 21 1/2° E.		30.00	BOUNDARIES OF THE SUM OF THE TRACTS OF PEDRO DOMINGUEZ & MARIA JESUS DOMINGUEZ SAUCES de la BOLSITA						
64	S. 9 1/2° E.		19.00	BOUNDARIES OF THE SUM OF THE TRACTS OF PEDRO DOMINGUEZ & MARIA JESUS DOMINGUEZ SAUCES de la BOLSITA						
65	S. 9 1/2° E.		24.20	BOUNDARIES OF THE SUM OF THE TRACTS OF PEDRO DOMINGUEZ & MARIA JESUS DOMINGUEZ SAUCES de la BOLSITA						
66	S. 9° W.		25.00	BOUNDARIES OF THE SUM OF THE TRACTS OF PEDRO DOMINGUEZ & MARIA JESUS DOMINGUEZ SAUCES de la BOLSITA						
67	S. 9° W.		6.75	BOUNDARIES OF THE SUM OF THE TRACTS OF PEDRO DOMINGUEZ & MARIA JESUS DOMINGUEZ SAUCES de la BOLSITA						

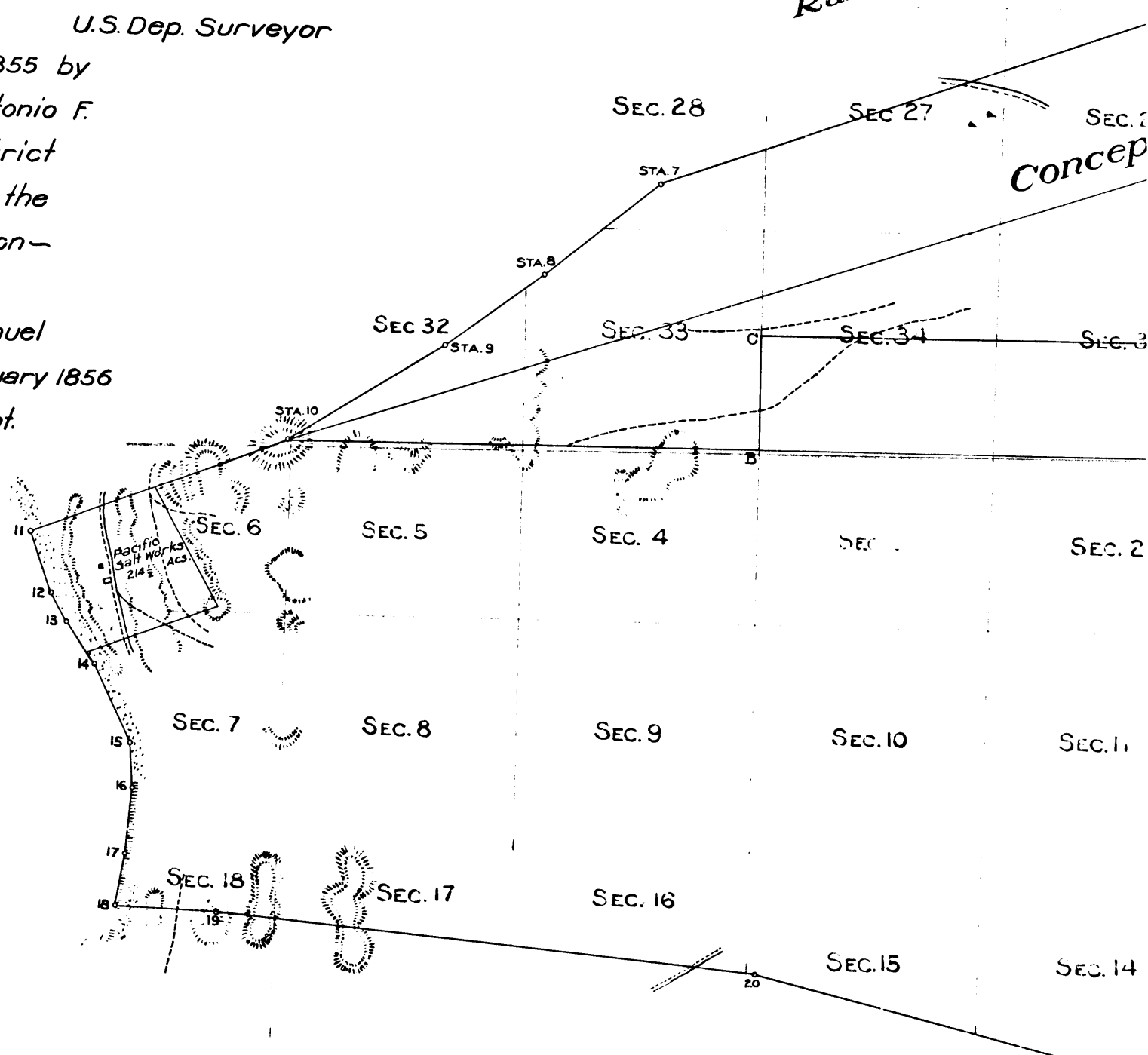

T. IV S. - R. XIV W.

State of California }
County of Los Angeles } ss.
I, George Hansen, Surveyor for the referees in the
action of partition of the rancho of San Pedro, or Dominguez rancho
in the District Court of the first Judicial District, in and for
said County of Los Angeles, do hereby certify that the present is a
true and perfect copy of the map made by me for said referees
and under their direction and referred to by them in their report
and in the final judgment of said Court. Signed at the
City of Los Angeles, this July 16th A.D. 1877

Subscribed and sworn to before me this 16th July 1877
Geo Hansen. Land Surveyor.
Attest: W. J. Gold, County Clerk
By E. H. Olvera Deputy

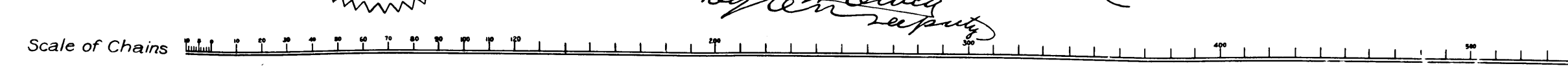
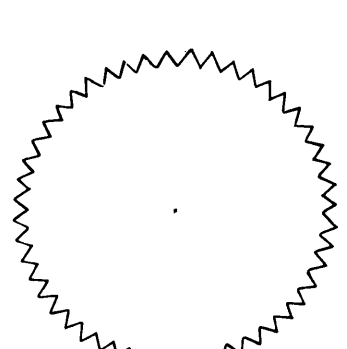

C.F. 118

3