

MAP OF ATLANTIC & PACIFIC RAIL ROAD

Through the county of
Los Angeles and part of San Bernardino
State of California
showing
Connection with Public Land surveys

Scale 6 M=1

Office of the Atlantic and Pacific R.R. Co.
Boston February 1st 1872.

It is hereby certified that in pursuance of the act of Congress approved July 27 1866 entitled "An act granting lands to aid in the construction of a Railroad and Telegraph line from the State of Missouri and Arkansas to the Pacific Coast" wherein a grant of lands is made by the Third section to the Atlantic and Pacific Mail Road Company who are thereby authorized to construct a rail road and telegraph line from Springfield in the state of Missouri to the Pacific Ocean this map shows the linear route of said Rail Road from a point in the western boundary of the county of Los Angeles to a point in Township seven north and Range seven east of San Bernardino Base and meridian in the state of California as definitely fixed in compliance with said act of Congress and in pursuance of the resolutions of the executive committee of the board of Directors of said company duly authorized thereto by said Board passed the first day of February 1872 and that the dates of the field work thereof are truly indicated along the line from station to station along the map.

Survey and mark upon the ground the line or route of the Atlantic & Pacific Rail Road from a point on the western boundary line of Los Angeles county to a point in Township seven North and Range seven east of San Bernardino Base and Meridian, state of California in the sections and at the times respectively designated by dates which are included between the flagstuffs upon and along the line of route of said railroad as delineated on this map showing the lines of the public surveys in connection with the surveyed line of the route and that the acts of said deputy or division Engineer in the premises were duly approved and accepted on behalf of said company by this deponent as said Chief Engineer of the Atlantic and Pacific Rail Road Company

J. Blichensderfer Jr.
Chief Engineer.

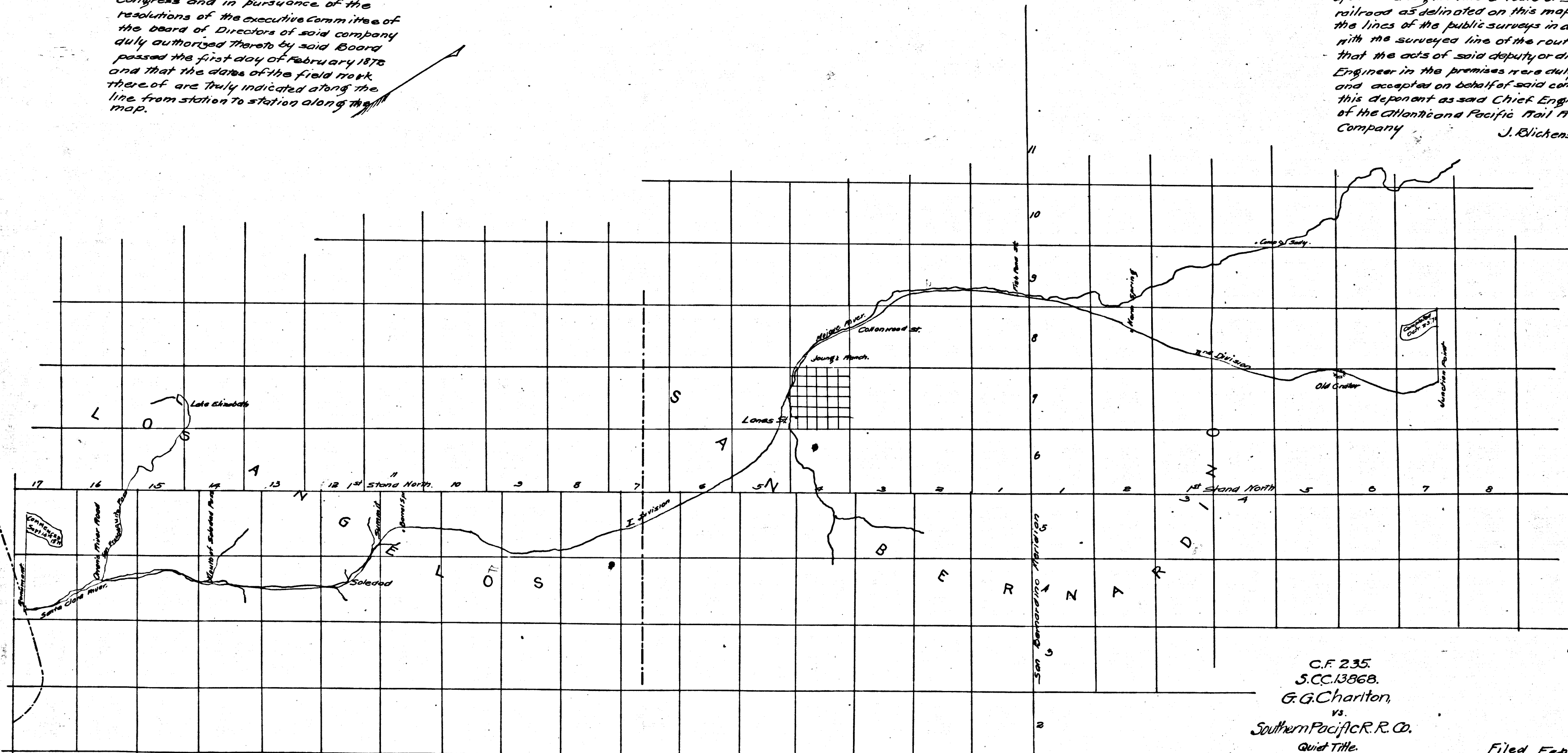

C.F. 235
S.C.C. 13868.
G. G. Charlton,
vs.
Southern Pacific R.R. Co.
Quiet Title.
F. Judgt. for Def. June 16-1891.
• Affirmed, Aug. 25-1891.
• Book. 28-263.
Judgt. does not mention map.

Filed Feb 18, 1891.

G. G. Charlton
vs.
S.P.R.R. Co.

F.S. = for Def. June 16-91
Aff. Aug. 25-91
J. Book 28-263

