

10TH

VEMCO PASADENA, CAL.

10TH

70 UNION ST. 70

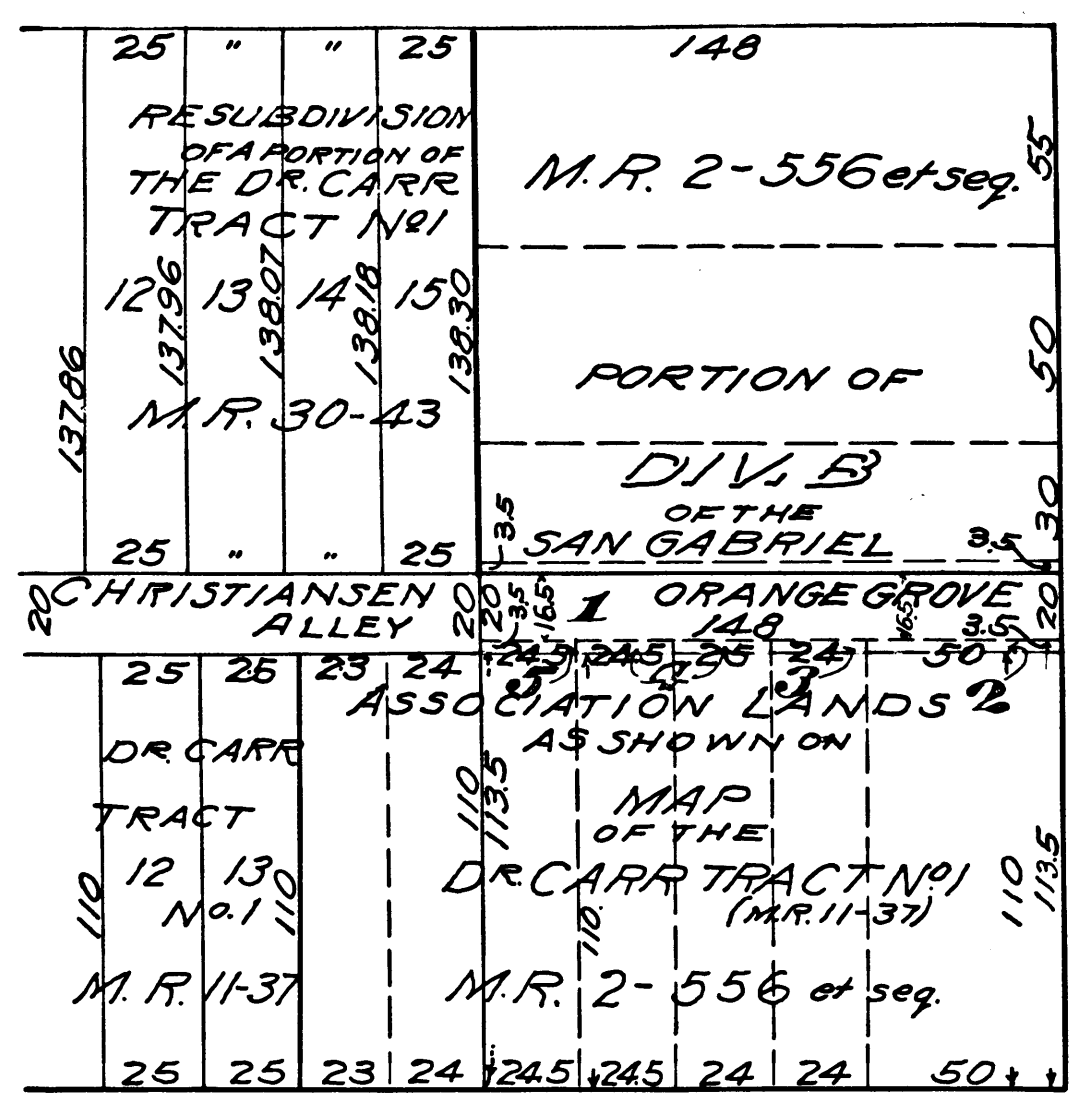

MAP

SHOWING LAND SOUGHT TO BE CONDEMNED AS DESCRIBED IN ORDINANCE No. 61 (P.W.) FOR THE OPENING AND EXTENDING OF CHRISTIANSEN ALLEY FROM THE PRODUCTION NORTH OF THE EAST LINE OF LOT 13, DR. CARR TRACT No. 1, AS PER MAP RECORDED IN BOOK 11, PAGE 37, MISCELLANEOUS RECORDS OF LOS ANGELES COUNTY, TO THE WEST LINE OF DELACEY STREET IN PASADENA, CALIFORNIA.

SCALE: - Lewis E. Smith
1 inch = 50 feet City Engineer.
Pasadena, California.
June 1913.

Note: - Shaded portion shows land sought to be condemned.

EXHIBIT "C"

S.C.C. B.2782 City of Pasadena vs. Stoneham.
Int. Judgment Dec. 8, 1913 to P.H. Final Judgt. July 27, 1914.
For judgment See D:5867-133 D:18-62.

For naming extension of Christiansen Alley see Ord. 1776 D:25-235
Opening and extending " " " " D:38-3 O.R. 2790-249

Index #8

C.F. 740 -

10TH

VEMCO PASADENA, CAL.

10TH

70

80

50

50

50

50

50

50

50