

Superior Court Case No. B. 91609  
 Suit for Condemnation  
 Filed Mar. 21<sup>st</sup> 1921  
 City of Pasadena, Pltff  
 Vs.  
 Grace A. Ohrmund et. al. Def.

Pending April 27<sup>th</sup> 1921  
 Pending Apr. 11, 1922  
 Interlocutory Decree rendered April 7<sup>th</sup> 1922  
 Pending May 10<sup>th</sup> 1924  
 Final Judgment Oct. 19<sup>th</sup> 1922

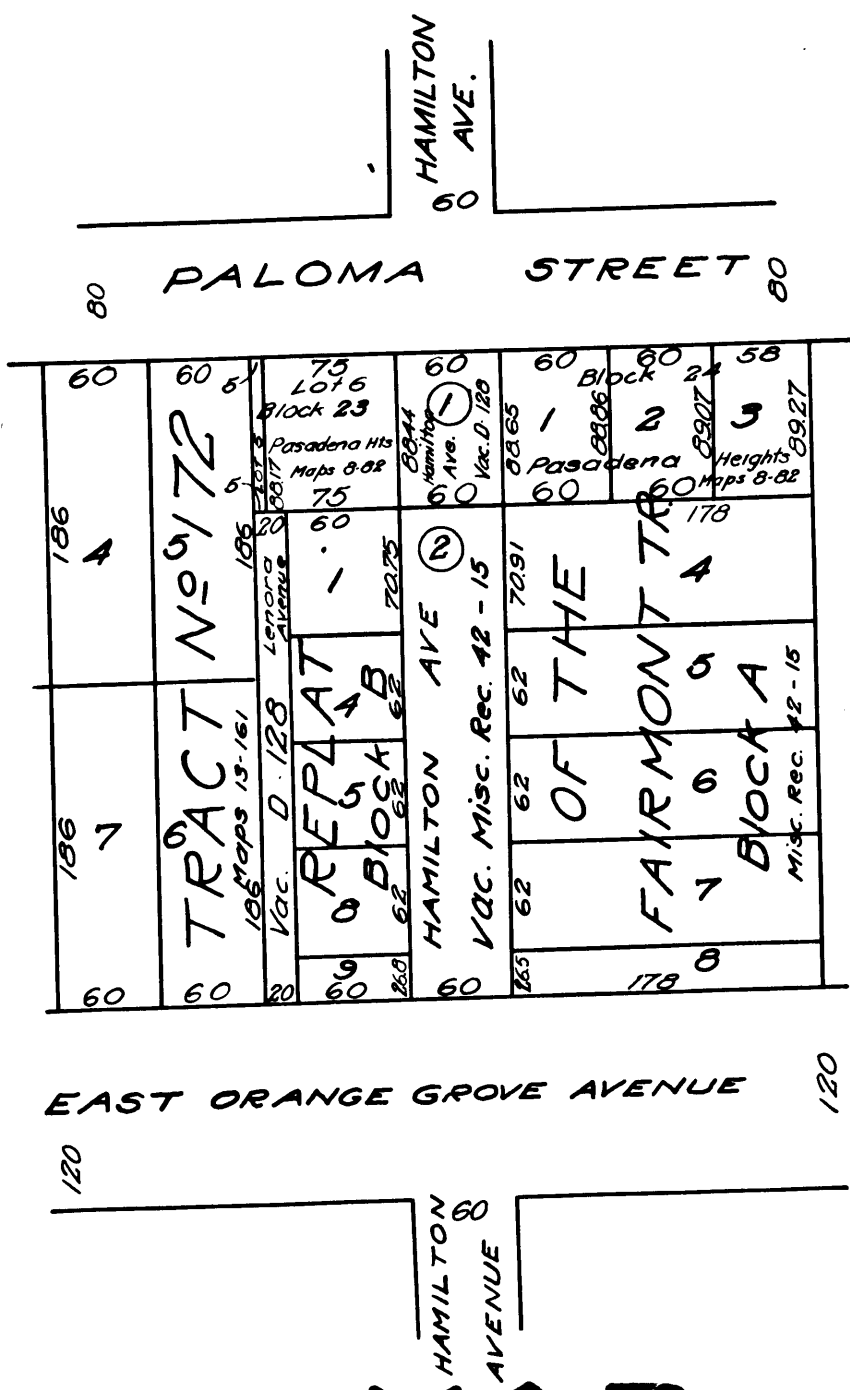

**- MAP -**

Showing land sought to be condemned for the opening of Hamilton Avenue from the north line of East Orange Grove Avenue to the south line of Paloma Street, in the City of Pasadena, County of Los Angeles, State of California

SCALE - 1 inch = 100 feet.  
 Pasadena, California, Edwin P. Dewey  
 February - 1921. City Engineer.

EXHIBIT 'C':

NOTE  
 shaded portion  
 shows land to be  
 taken.