

Superior Court Case No. B93511
 Suit for Condemnation
 Filed May, 13th 1921.
 City of Long Beach, Piff.
 vs.
 Carl W. Rose, et al Defendants.

Interlocutory decree rendered Aug. 18, 1921.
 Pending Jan. 21, 1922.

Final judgement in favor of Plaintiff, as per
 map, rendered April 26, 1922.
 D: 30-15 D.R. 1080-162
 OCEAN

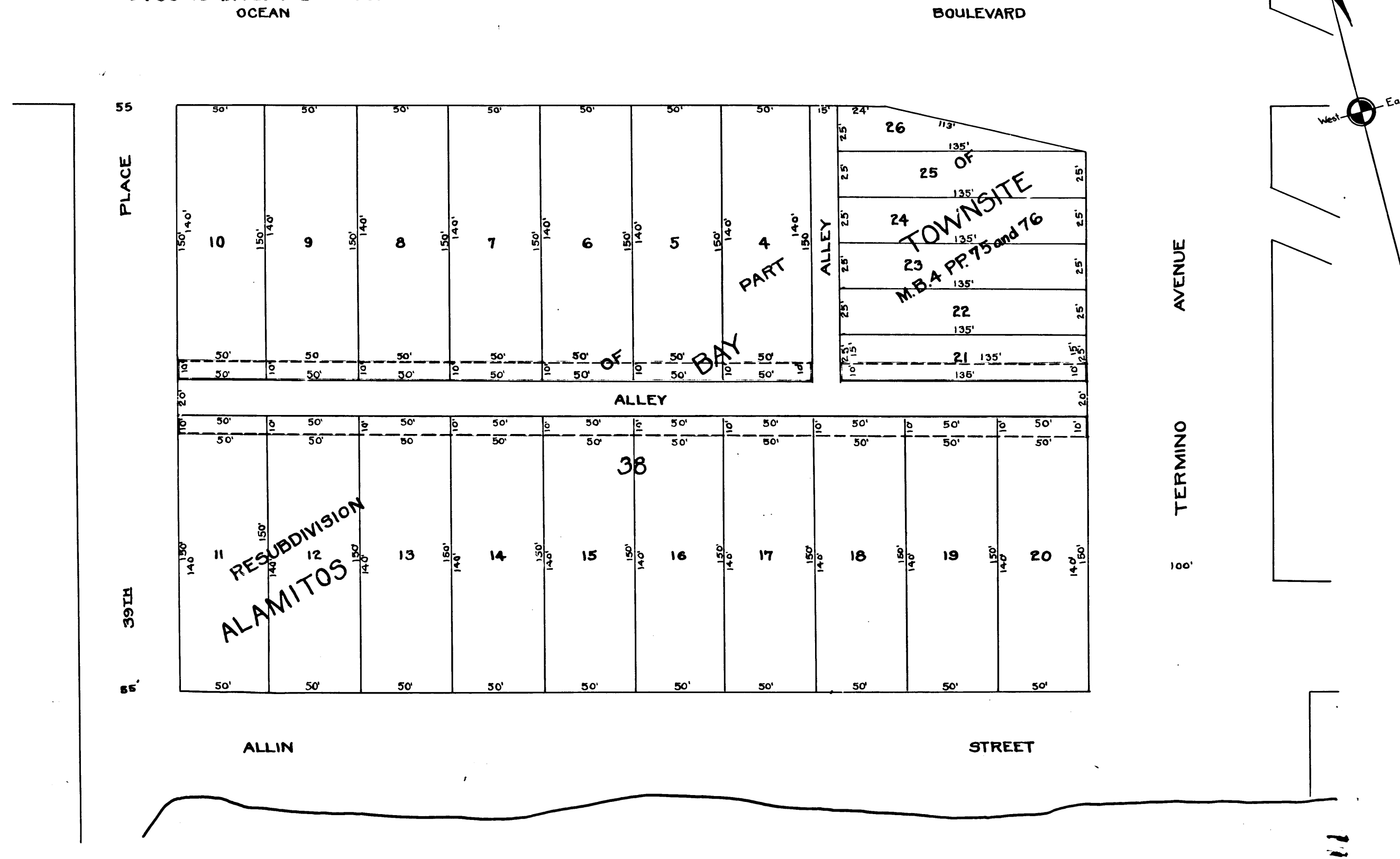

C.F. 989 -

(Sheet 3/)

