

**MAP**  
 SHOWING LAND TO BE CONDEMNED  
 FOR THE WIDENING OF  
**FORTY-FIRST DRIVE**  
 BETWEEN  
 HOOVER STREET AND MENLO AVENUE  
 IN THE  
**CITY OF LOS ANGELES, CALIFORNIA**

In accordance with Ordinances Nos 45,170 and 45,983 (New Series)  
 John A. Griffin, City Engineer

Scale - 1 inch = 100 feet.  
 Note - Land to be condemned shown colored Red.

*Superior Court Case No. 124023  
 Suit for Condemnation  
 Filed July 13, 1923.  
 City of Los Angeles - Pltff.  
 vs.  
 Carey et al. Def.  
 Interlocutory Judgment rendered  
 Mar. 24th 1924 - Pending May 10th 1924  
 Final Judgment in favor of Pltff. as per  
 map, rendered November 7, 1924.*

*D: 40-165 O.R. 4221-290*

*Sheet 24*

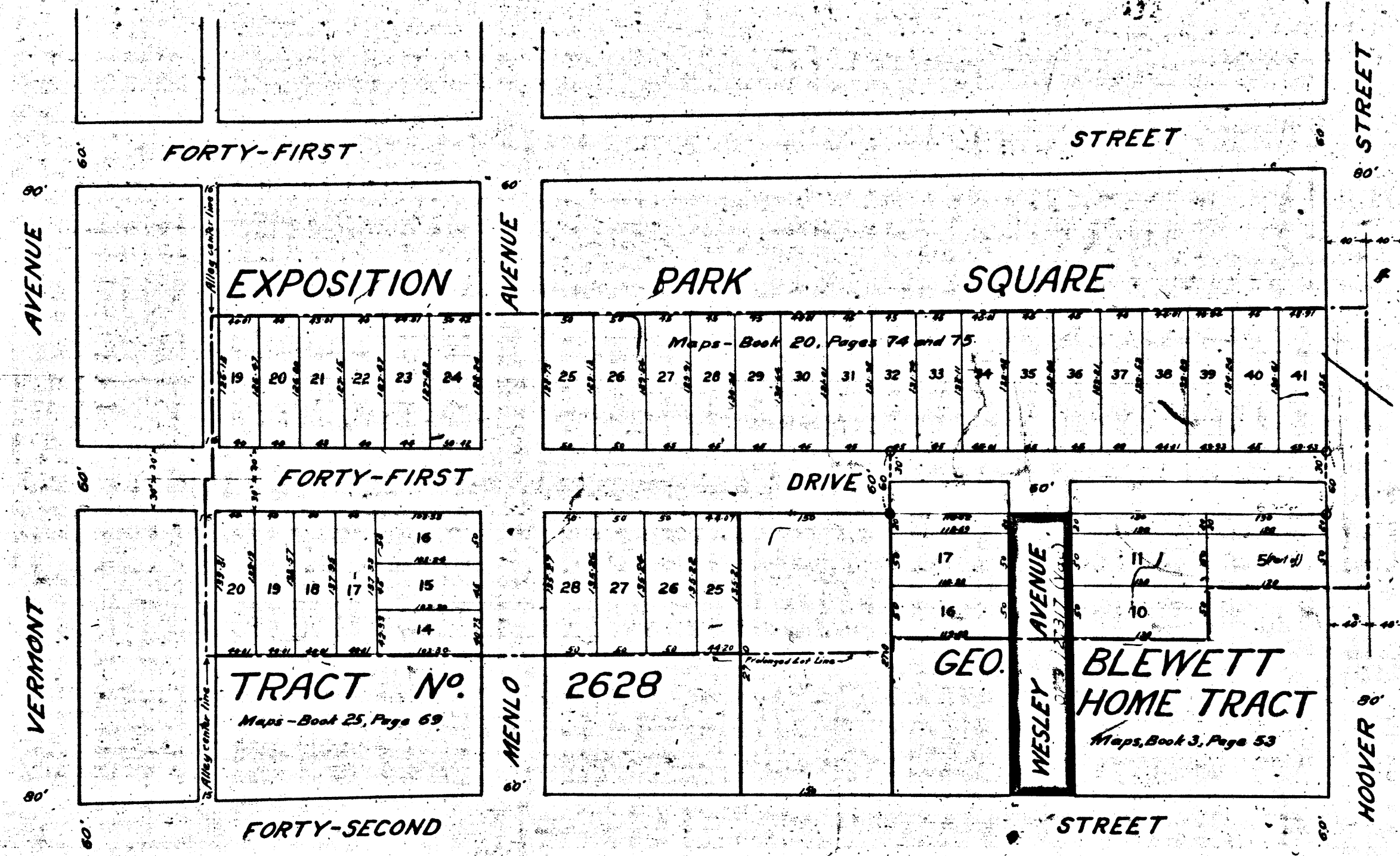
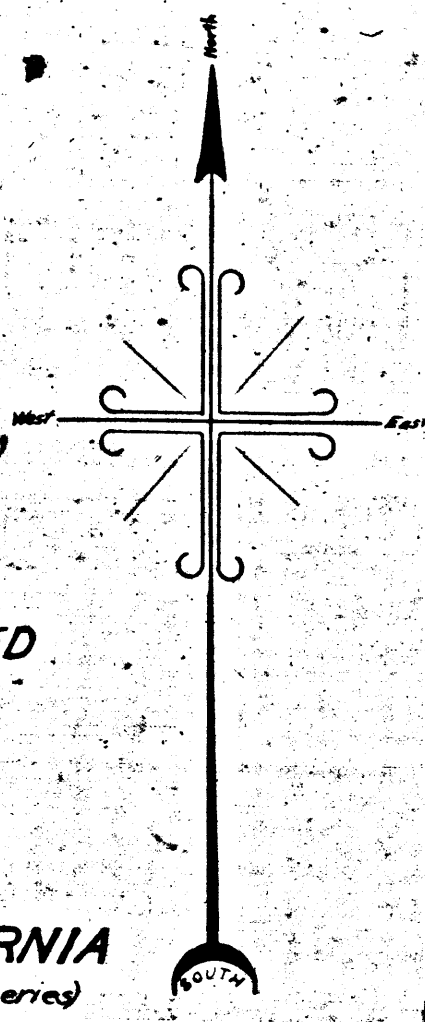

1924