

100M 2200 trued ror noque 2  
100M 2200 trued ror noque 2

100M 2200 trued ror noque 2  
100M 2200 trued ror noque 2

**\* Superior Court Case No. 131857**  
**Suit for Condemnation**  
**Filed Nov. 9, 1923**  
**City of Pasadena, Pettr.**  
**vs.**  
**Chas. J. Petteler, et al., Def.**  
**Pending Nov. 21, 1923**  
**Pending May 10<sup>th</sup> 1924**  
**Interlocutory Judgment 12-18-24**  
**Pending Feb. 18<sup>th</sup> 1925**  
**Dismissed Apr. 3, 1925**

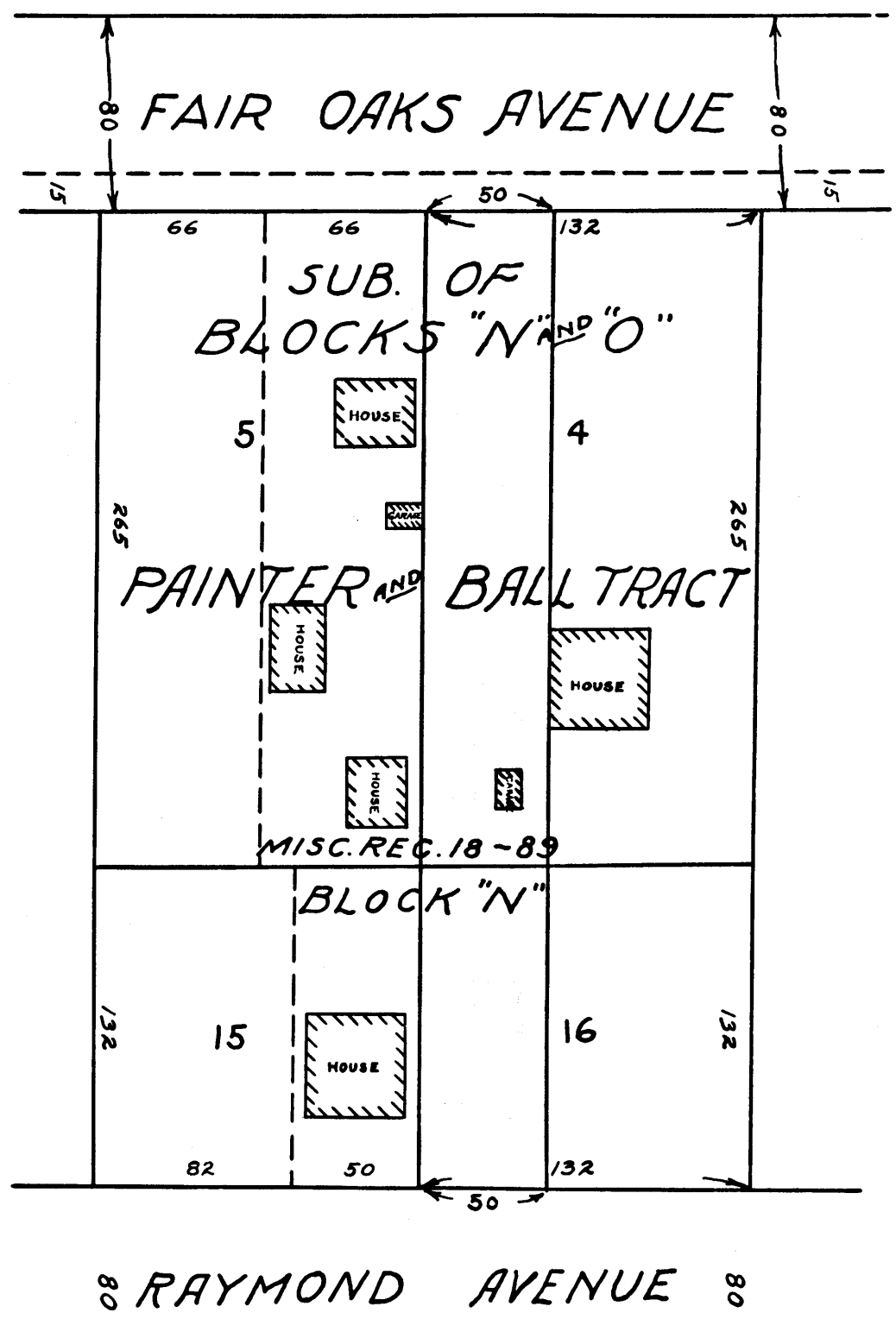

Note :-  
Shaded portion shows  
land sought to be condemned

EXHIBIT "C"

C.F. 1059 -

DRAWN BY B.S.F. CHECKED BY A.F.B. FIELD BOOKS 305-P57 <i>H. Allen</i> DEPUTY CITY ENGINEER APPROVED <i>W. C. Carle</i> CITY ENGR & SUPY OF STREETS	CITY OF PASADENA OFFICE OF CITY ENGINEER & SUPERINTENDENT OF STREETS OPENING AND EXTENDING OF GRAND VIEW STREET FROM RAYMOND AVE. TO FAIR OAKS AVE.	DATE JAN 1923. SCALE 1" = 60' DRAWING NUMBER <b>G 67</b>
--	--	---

Clerk's Filed Map No. 1023  
Superior Court Case No. 131857

100M 2200 trued ror noque 2  
100M 2200 trued ror noque 2