

MAP
 SHOWING LAND TO BE CONDEMNED
 FOR THE OPENING AND LAYING OUT OF
SAN JOSE AVENUE
 FROM THE NORTHERLY LINE OF TENTH ST.
 TO THE SOUTHERLY LINE OF SUNSET CANYON DRIVE
 ALL WITHIN THE CITY OF BURBANK

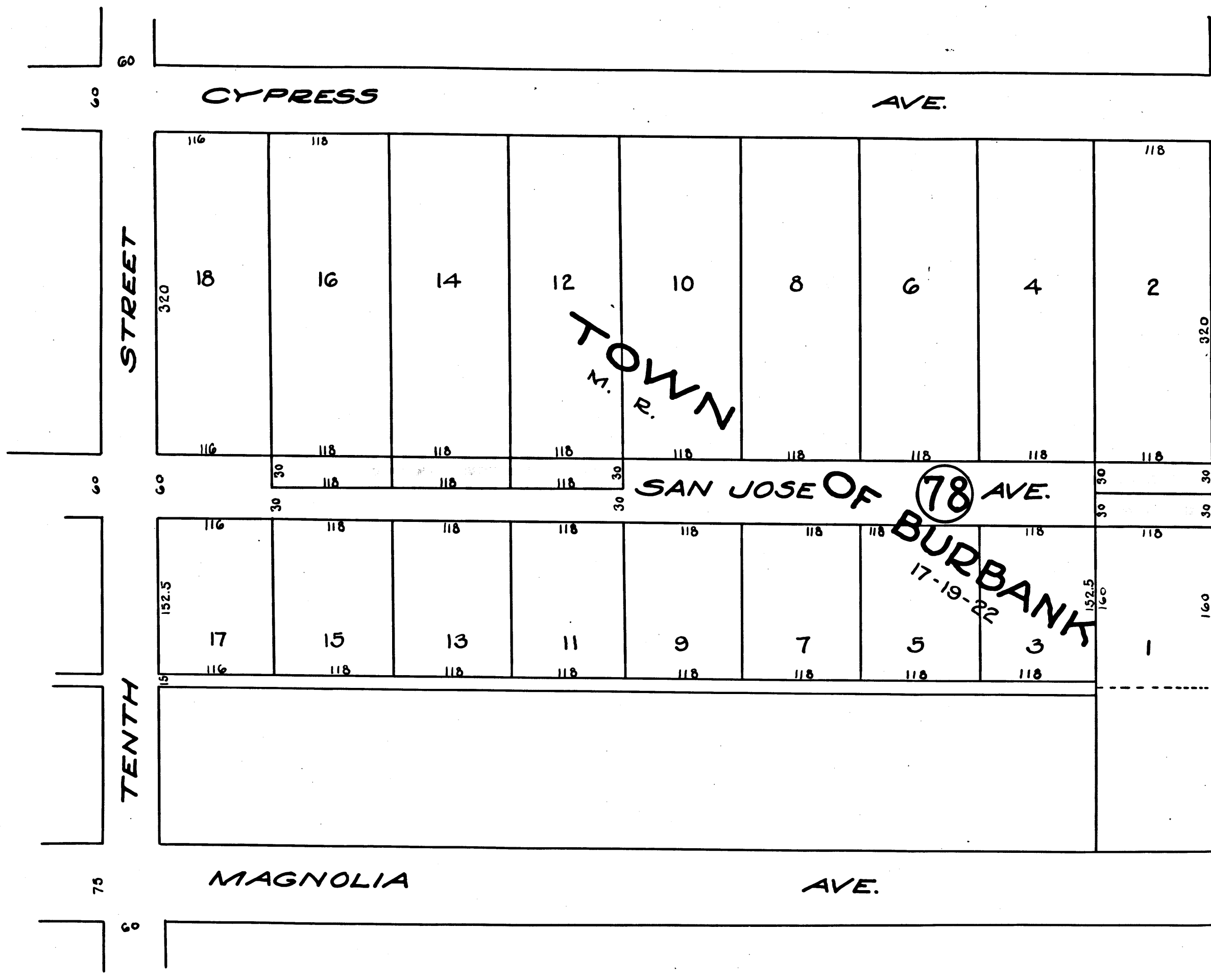
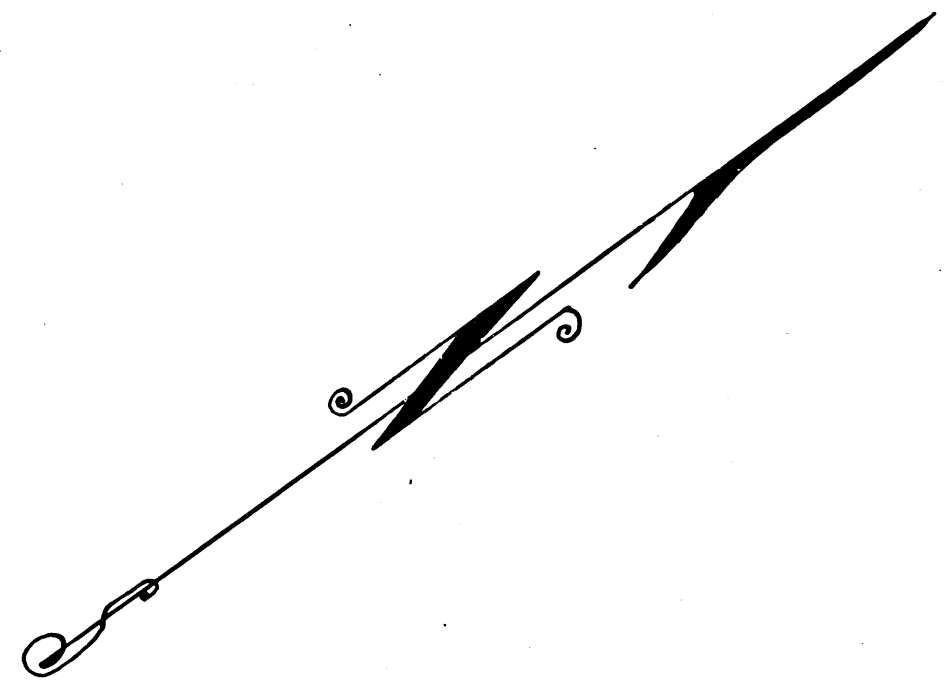

Superior Court Case No. 154978
 Filed Oct. 20th 1924
 Suit for Condemnation
 City of Burbank Plff.
 Vs.
 Felicia A. Ervin et al Def.
 Pending Oct. 28th 1924
 Dismissed Feb. 18th 1925
 Sht. 40

SCALE 1"=100'
 Vermilion tinting shows land to be condemned

C.F. 1160 -

