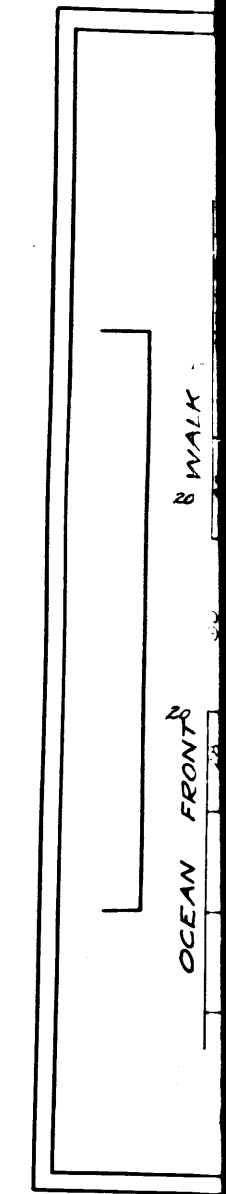
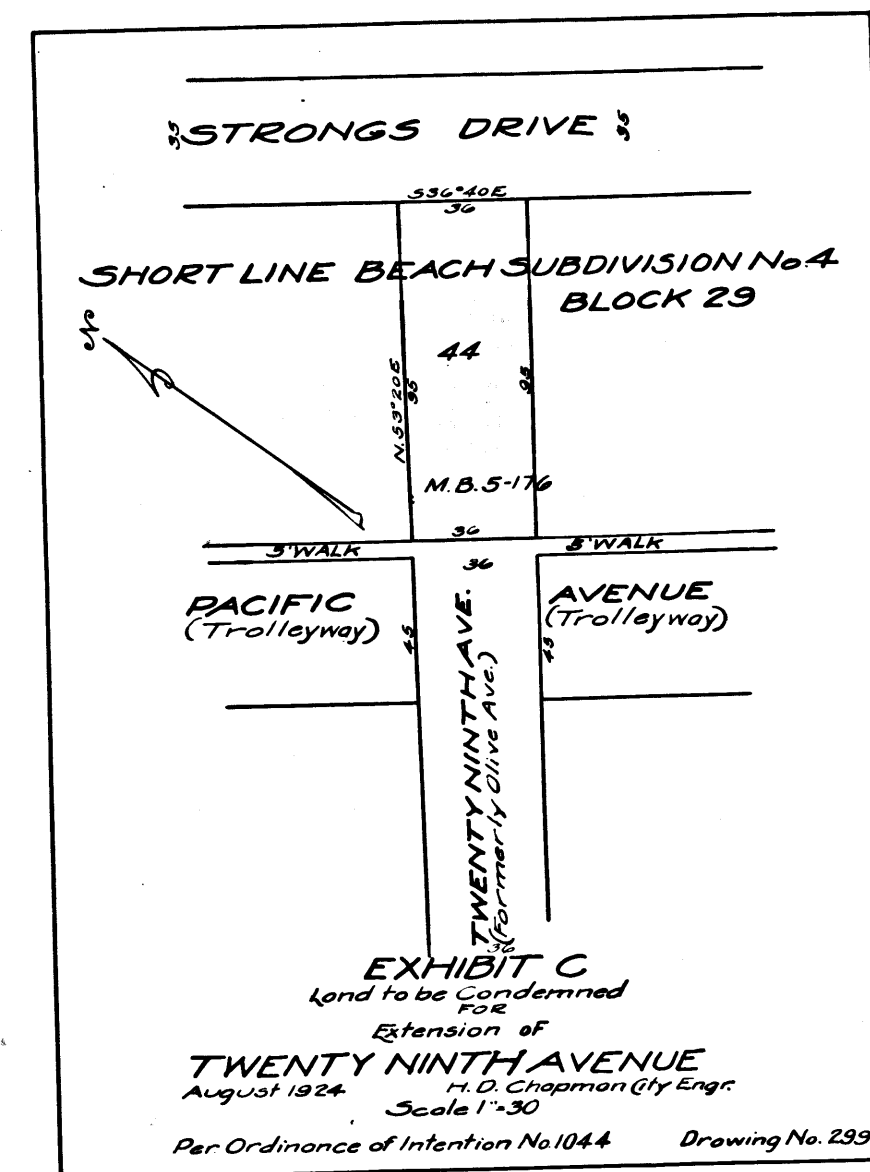
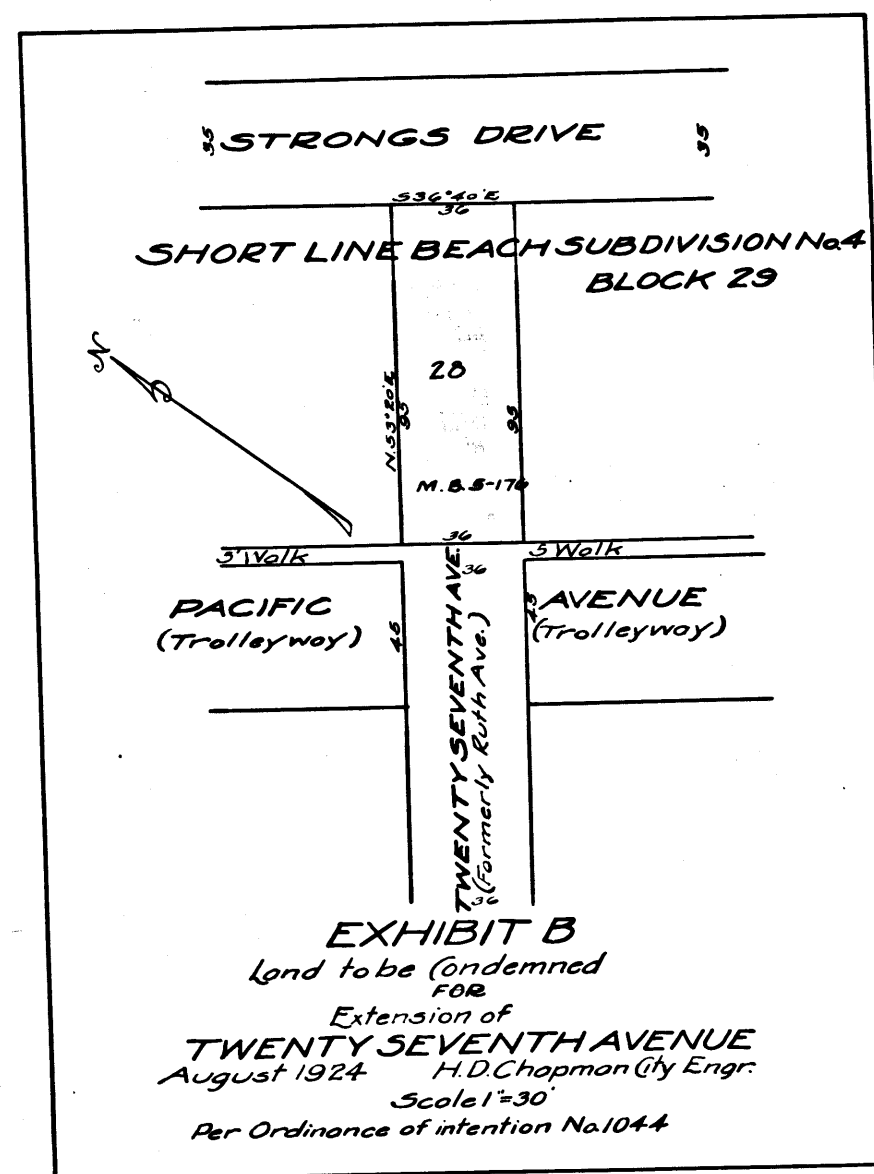
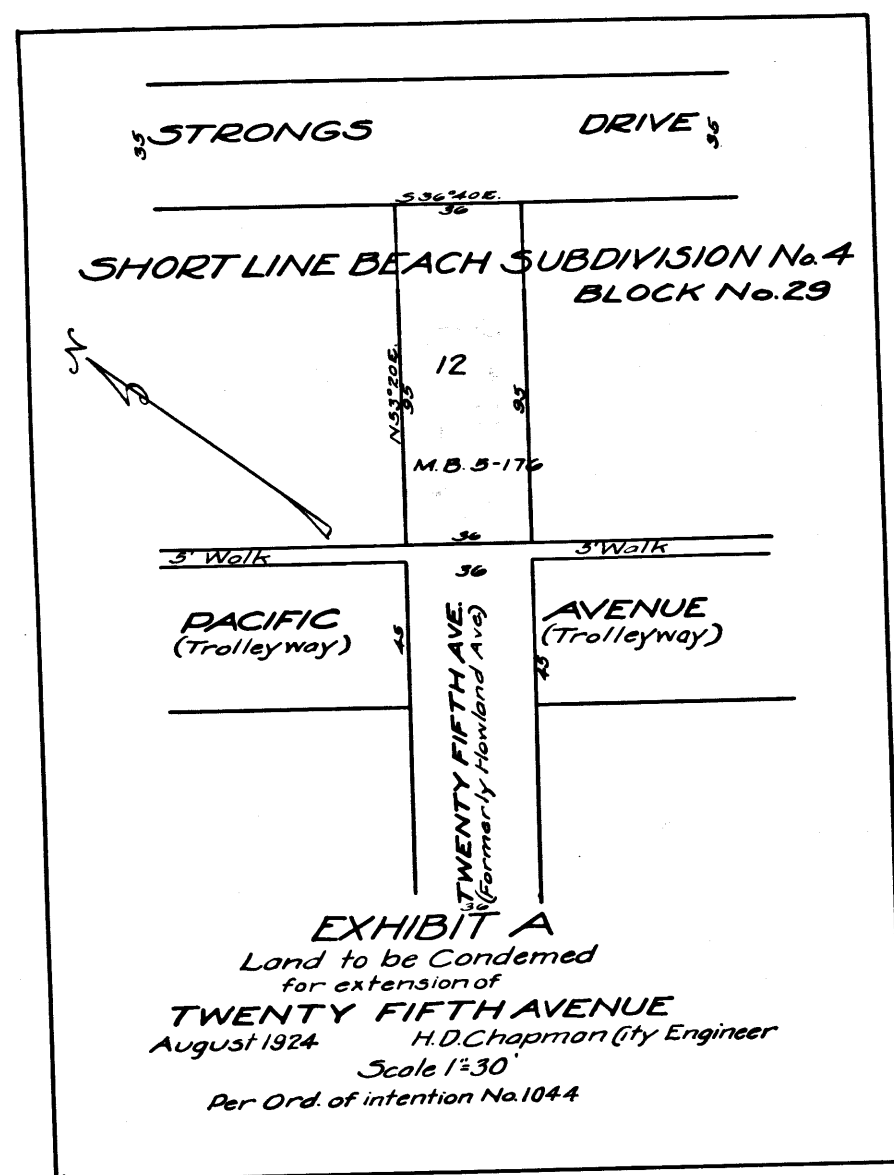
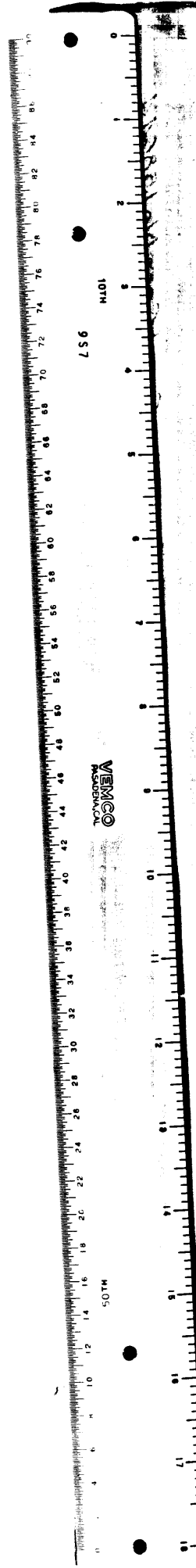

EXHIBIT "D"
 Land to be Condemned for the
 Widening of
 THIRTY FIRST AVENUE
 and the Extending of
 STRONGS DRIVE
 August 1924. H.D. Chapman City Eng.
 SCALE 1"=30'
 as Per Ord. of Intention No. 1044

Drawing No. 2992

1
 C.F. 1183



2

C.F. 1183 -