

MAP
*Showing the Land to be Condemned
for the Opening of*
SAN JOSE AVENUE
BETWEEN
Front Street and San Fernando Blvd.
all within the City of Burbank
Scale 1"=100'

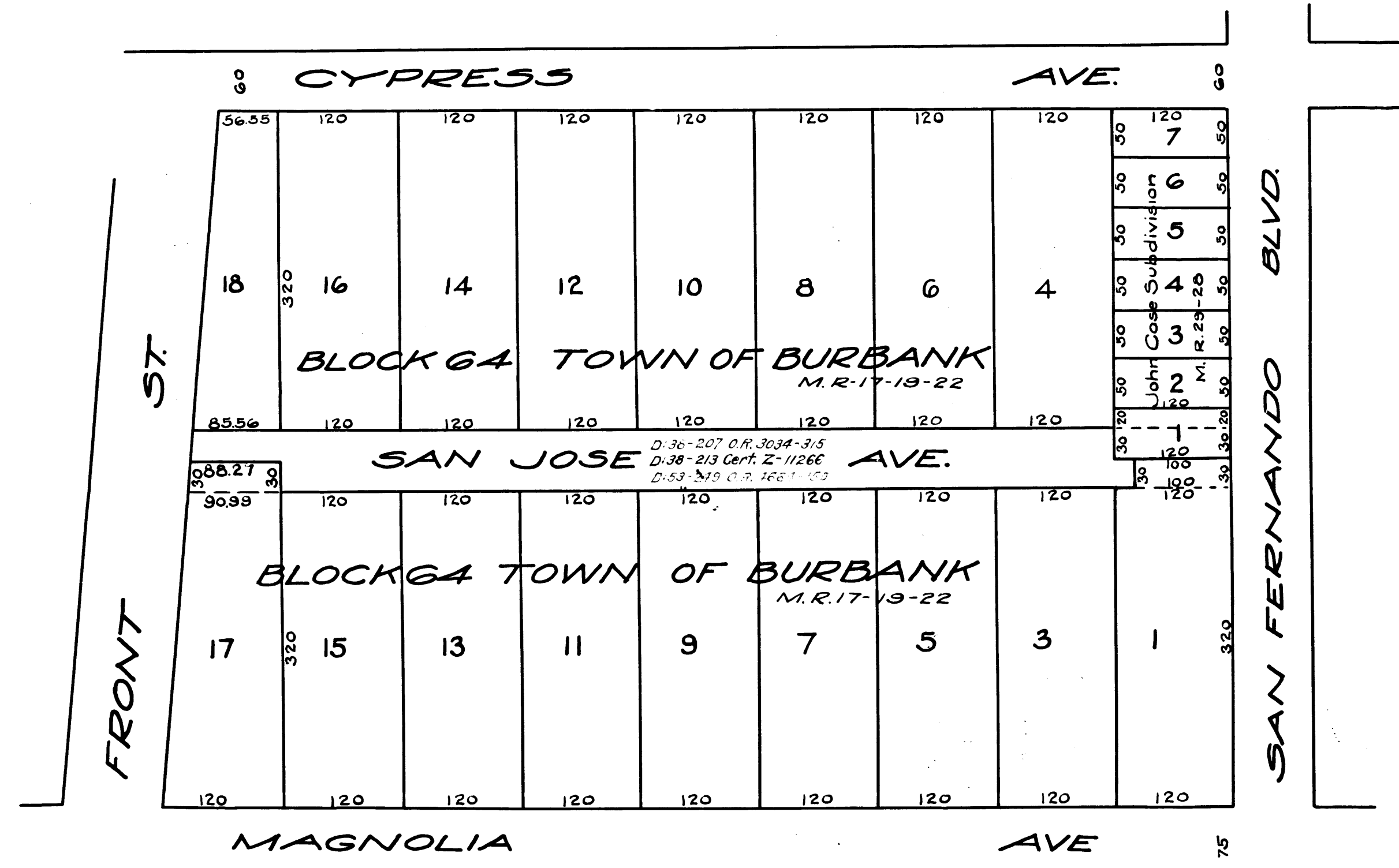

FRONT ST.

SAN FERNANDO BLVD.

MAGNOLIA AVE

Superior Court Case No. 161884
 Suit for Condemnation
 Filed Jan. 27th 1925
 City of Burbank Pltff.
 Vs.
 William H. Moses et al Def.
 Pending Feb. 10th 1925
 Interlocutory decree rendered 5-3-25
 Pending May 1st 1926
 Sht 40
 Final judgment in favor of Plaintiff
 as per map, rendered June 2nd 1926
 Judg. Bk. 608-212
 D:77-179 O.R. 9508-282
 Sht. 40

| | | |
|------|------|---|
| C.F. | 1205 | - |
|------|------|---|