

TRACT No. 288

M. B. 14-162 & 163

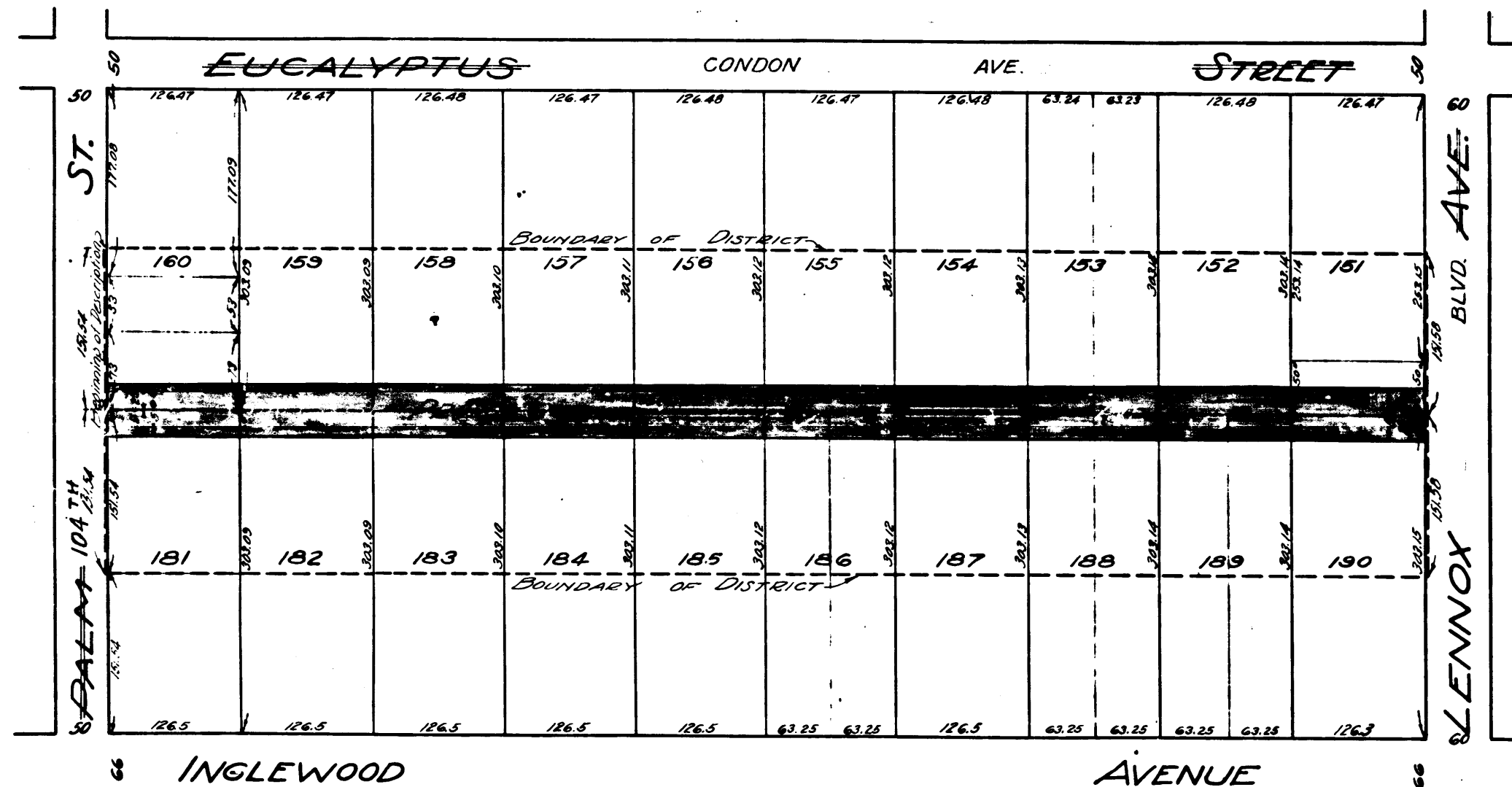

COUNTY  
STREET OPENING DISTRICT No. 22  
MAP OF  
**PROPOSED OPENING  
OF ROSEWOOD STREET**  
BETWEEN  
PALM STREET AND LENNOX AVENUE  
SHOWING

The exterior boundary of the District to be assessed therefor under the provision of the County Street Opening Act of 1923, Approved May 11th 1923.  
SCALE 1"=100' AUGUST 1924  
J.E. ROCKHOLD - COUNTY SURVEYOR

Submitted: *Alfred J. Jones*  
Chief Deputy

Approved: *J.E. Rockhold*  
County Surveyor

Approved as to form  
Edward T. Bishop  
County Counsel  
by *Conrad J. Quastrom*  
Chief Deputy

LEGEND  
District Boundary -----  
Land sought to be condemned colored red.

I hereby certify that the Board of Supervisors of Los Angeles County did on the day of 14th 1924 by resolution duly adopted, approve the accompanying map of the assessment of 22nd Street of County Street Opening District No. 22 of the County of Los Angeles for the opening of Rosewood Street.

CLERK OF THE BOARD OF SUPERVISORS  
OF SAID COUNTY OF LOS ANGELES.

By *Mame B. Beatty*  
Deputy  
Filed Oct. 14, 1924 in the office of the  
County Surveyor of Los Angeles County  
J.E. ROCKHOLD - COUNTY SURVEYOR Sht # 24  
By *W.F. Cook* Deputy.

Rosewood St. changed to Rosewood Ave. D: 49-113

Superior Court Case No. 163735  
Suit for Condemnation  
Filed Feb 21st 1925  
County of Los Angeles Plfff.  
Vs.

J.H. Brockman et al Def.

Pending Feb 28th 1925  
Interlocutory decree rendered 12-2-25

Pending May 1st 1926  
Judgment Book 600-81  
Final judgment in favor of Plfff. as per  
map, rendered August 21st 1926.

D: 58-90, OR. 6097-389.

C.F. 1211 -

OPENING AND WARNING No. 22	
PLATTED BY H.S. DUEY	AUG. 4th 1924
TRACED BY H.S. DUEY	AUG. 4th 1924
CHECKED BY Mearck	AUG. 6, 1924