

Superior Court Case No. 177547  
 Suit for Condemnation  
 Filed Aug. 27, 1925  
 City of Los Angeles, Plff.  
 Vs.  
 Walter W. Jone, et al. Def.  
 Pending Sep. 28, 1925  
 Interlocutory decree rendered 4-22-26  
 Pending May 1st 1926  
 Judgment Book L07-126  
 Final judgment in favor of Plff, as per  
 map, rendered March 3, 1927.  
 D-57-180 O.R. 6169-296

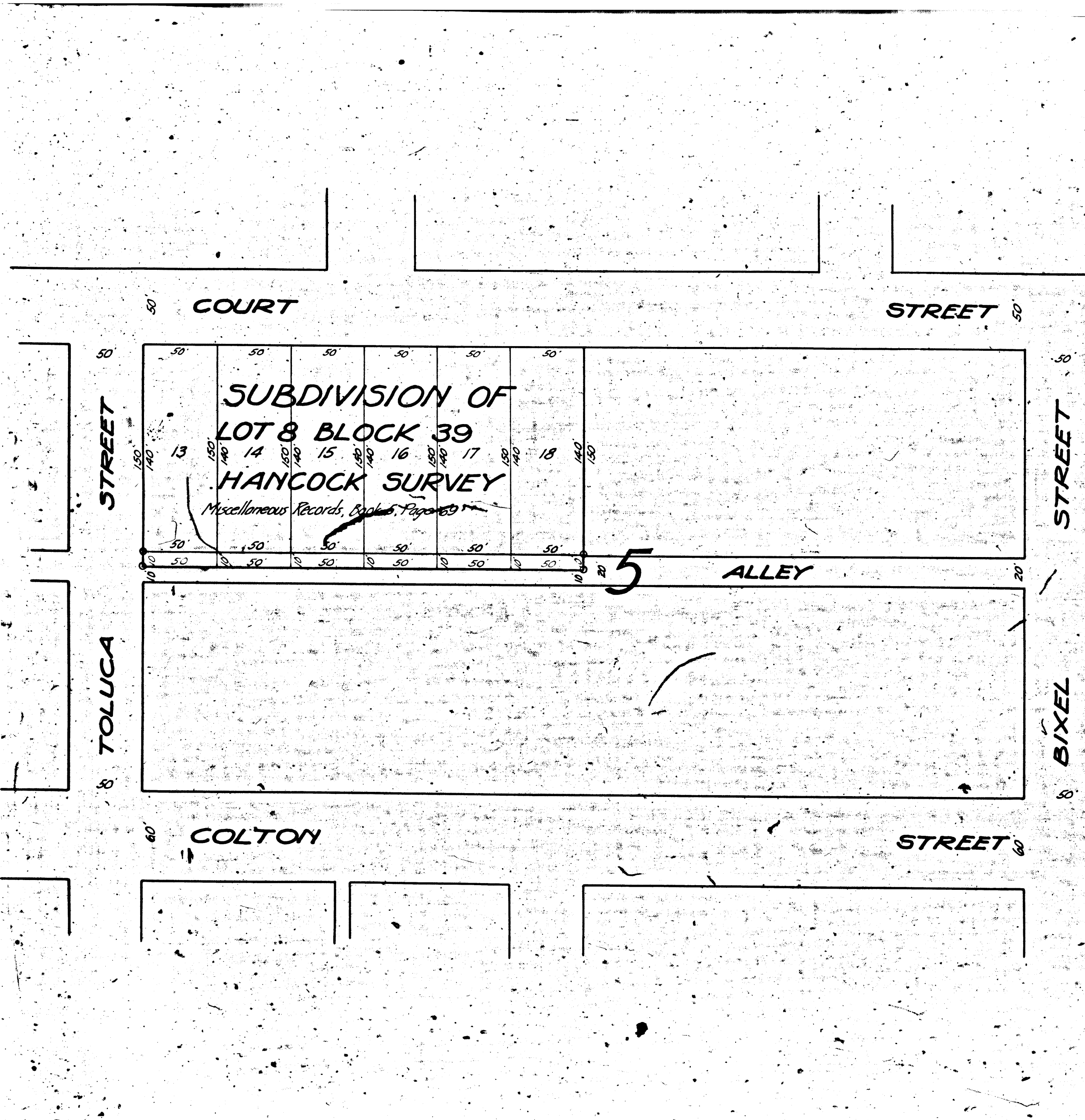

**MAP**  
 SHOWING THE LAND TO BE CONDEMNED  
 FOR THE WIDENING OF A PORTION  
 OF THE FIRST  
**ALLEY**  
 SOUTHWESTERLY OF COURT STREET  
 BETWEEN  
 BIXEL STREET AND TOLUCA STREET  
 IN THE  
 CITY OF LOS ANGELES, CAL.

IN ACCORDANCE WITH ORDINANCES NOS. 50875 AND 51956 (NEW SERIES)  
 H.A. VAN NORMAN CITY ENGINEER APRIL 1925  
 SCALE 1 INCH = 50 FEET  
 Note: Land to be condemned shown colored red.

1-3116

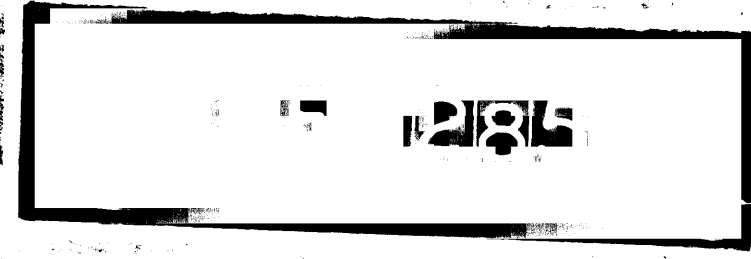

2100 A