

Superior Court Case No. 179-32
 Suit for Condemnation
 Filed Sept. 23, 1925
 City of Long Beach, Plff.
 Vs.
 Mae F. Judson et al. Def.
 Pending May 1, 1926.
 Pending Apr. 1, 1927
 Interlocutory decree rendered Oct. 25, 1927
 Judg. Bk. 672-101

Note: This map not copied in full
 Final Judgment in favor of Plaintiff, as per map,
 rendered Nov. 1, 1928
 D 69-119 02.7321-183

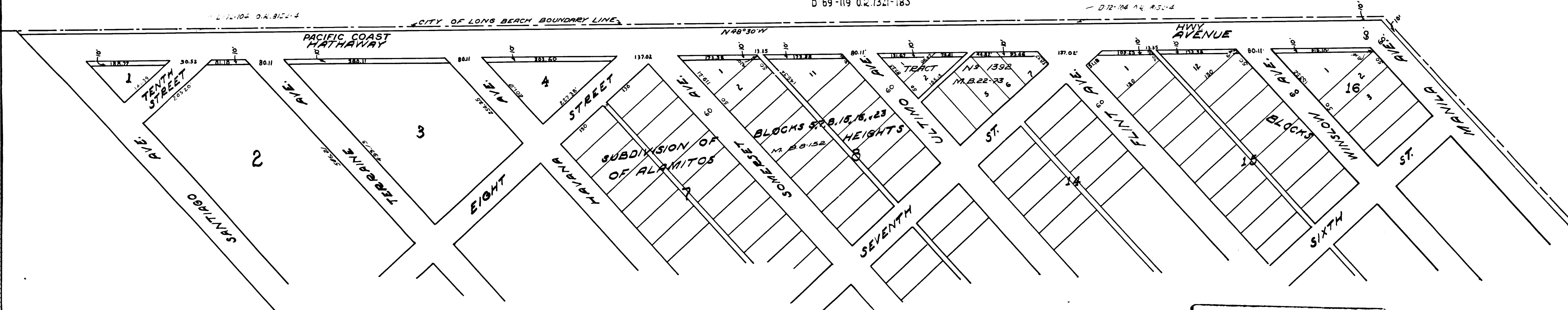

C.F. 1292 -