

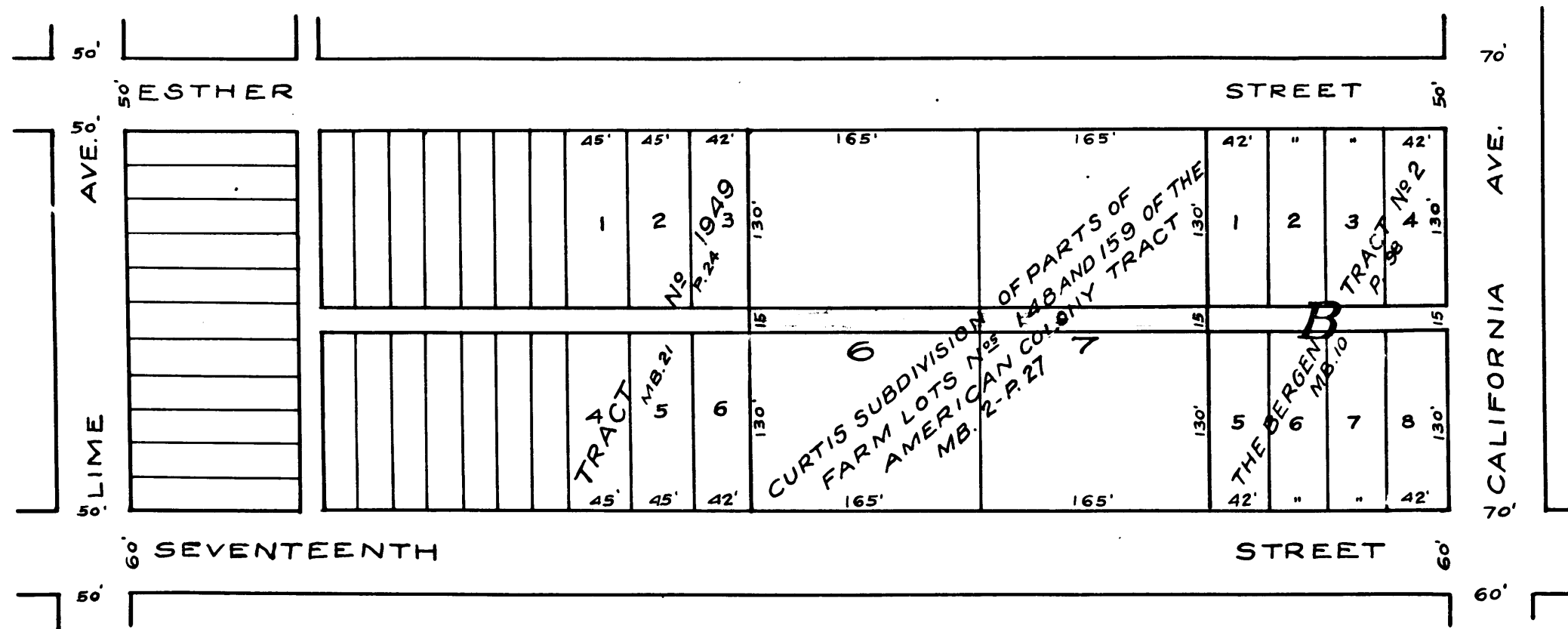

PROPERTY TO BE TAKEN SHOWN IN RED



Superior Court Case No. 183891  
 Suit for Condemnation  
 Filed Nov. 20<sup>th</sup> 1925  
 City of Long Beach, Plaintiff.  
 Vs.  
 Thomas O. Ashby et al. Defendants.  
 Pending May 1, 1926.  
 Interlocutory judgment as per  
 map, rendered Feb. 11<sup>th</sup> 1927  
 Judg. Bk. 637-13  
 Pending Apr. 7<sup>th</sup> 1927  
 Final judgment in favor of Plt'ff. as  
 per map, rendered Dec. 7<sup>th</sup> 1927.

D: 62-141, O.R. 6793-390

Sh. 30

C.F. 1314 -