

COUNTY  
STREET OPENING DISTRICT No 71  
MAP OF  
PROPOSED OPENING  
OF AN  
**ALLEY**  
BETWEEN CORONA AVENUE AND GIFFORD AVENUE  
SHOWING

The exterior boundary of the district to be assessed therefor under the provisions of the County Street Opening Act of 1923, Approved May 11, 1923.  
Scale 1"=80'. Dec. 1925.

J.E. ROCKHOLD, COUNTY SURVEYOR

Submitted: *Alfred Jones*  
Chief Deputy

Approved: *J.E. Rockhold*  
County Surveyor

Approved as to form  
EDWARD T. BISHOP, COUNTY COUNSEL  
By *Edward T. Bishop*  
Chief Deputy.

LEGEND:-  
District Boundary Line - - - - -  
Land sought to be condemned colored red

I hereby certify that the Board of Supervisors of Los Angeles County did, on the 21st day of Dec. 1925, by resolution duly adopted, approve the accompanying map of the assessment district of County Street Opening District No 71 of the County of Los Angeles for the opening of the alley shown on said map.

Filed Dec. 21<sup>st</sup> 1925, in the office of the County Surveyor of Los Angeles County.  
J.E. ROCKHOLD, COUNTY SURVEYOR.  
by *R. Heuer*  
Deputy.

L.E. LAMPTON, County Clerk and Ex-Officio Clerk of the Board of Supervisors of said County of Los Angeles.  
by *Wm. B. Beatty*  
Deputy.

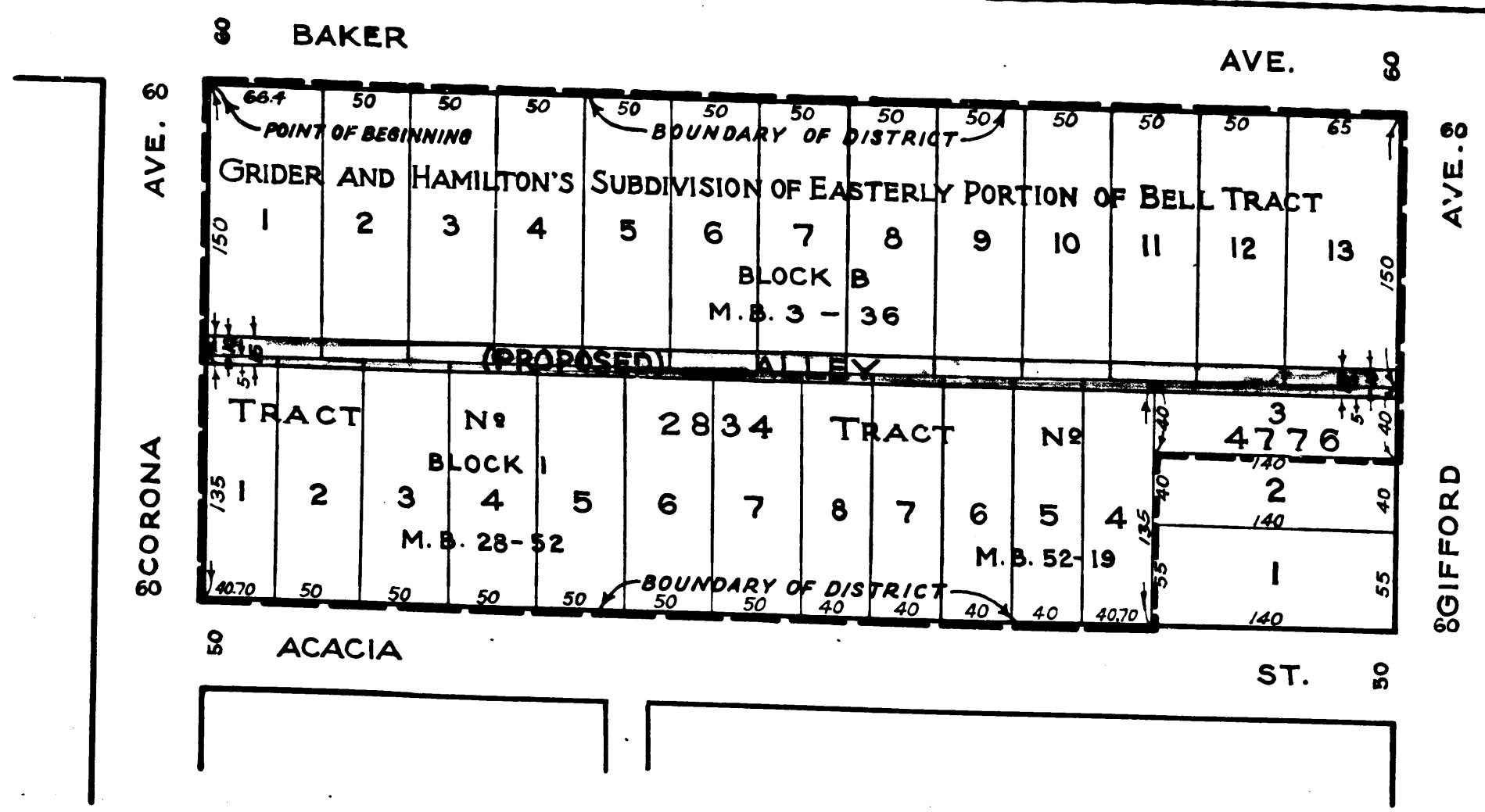

Superior Court Case No. 191359  
Suit for Condemnation  
Filed March 8<sup>th</sup> 1926  
County of Los Angeles, Pl'tff.  
Vs.  
Walter M. Avis et al., Def.  
Pending May 1, 1926.  
Dismissed January 6, 1928.

C.F. 1343-

S.O.D. No 71	
Drawn by R.B. Heuer	Dec. '25
Traced by R.B. Heuer	Dec. '25
Checked by R.F. Flickwir	Dec. '25

VENICO PASADENA, CAL.

VENICO PASADENA, CAL.