

V-4221

REMIEN AV GILA PUNTINGO VECINE
CITY OF LOS ANGELES
ENGINEER OF THE

U-4-A

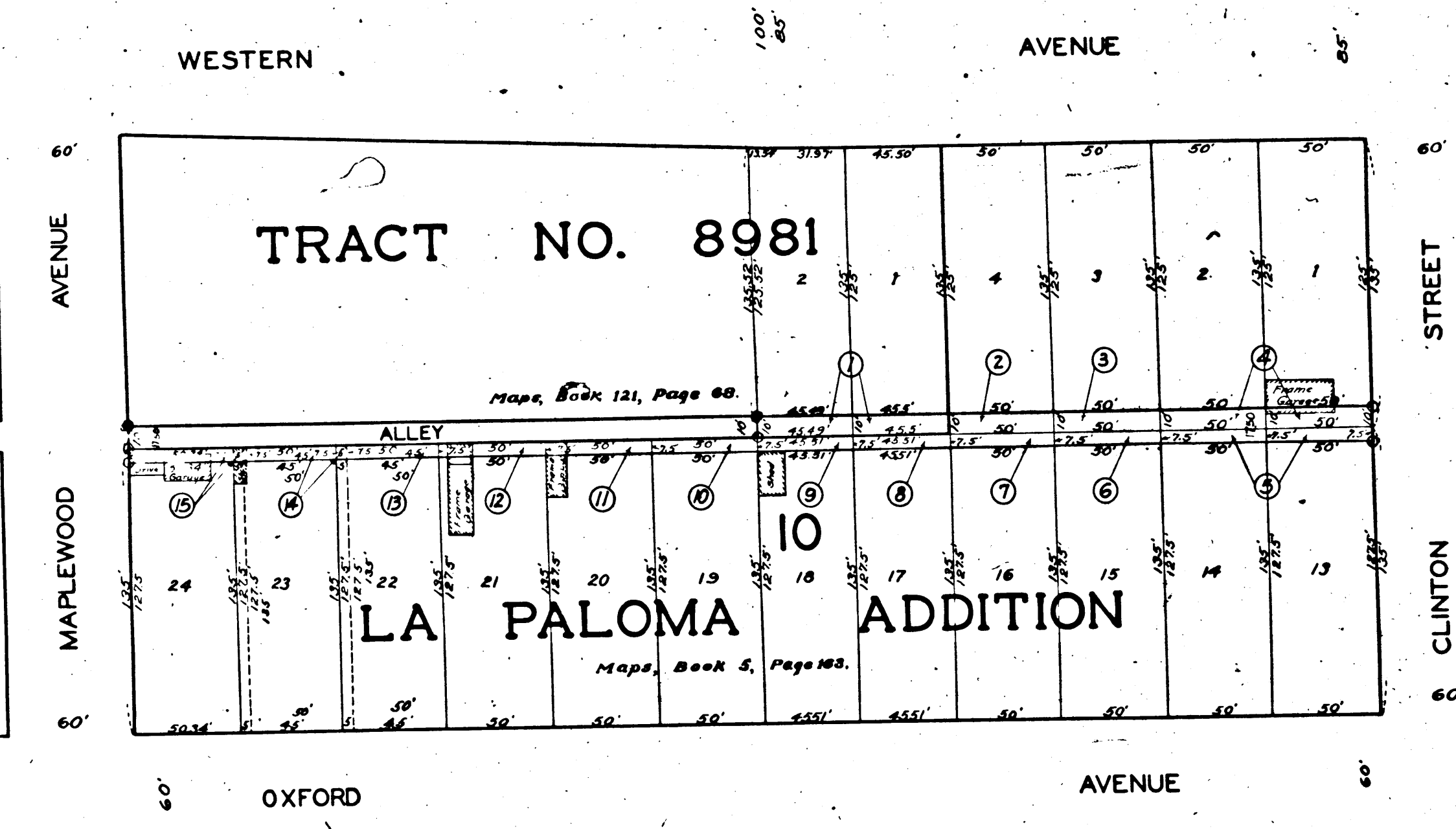
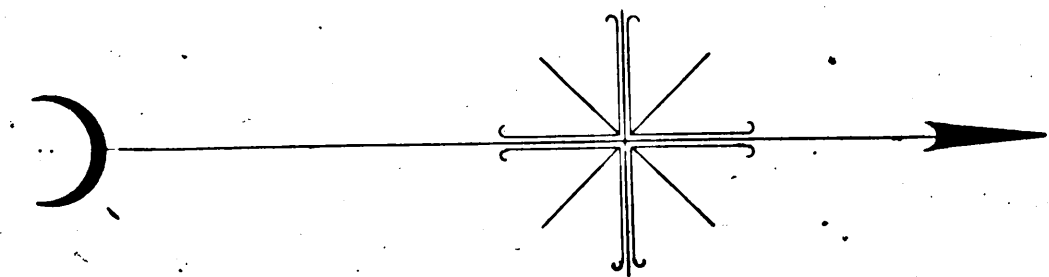

MAP
 SHOWING THE LAND
 TO BE CONDEMNED
 FOR THE
 OPENING WIDENING AND EXTENDING
 OF
THE ALLEY
 BETWEEN
 OXFORD AVENUE AND WESTERN AVENUE
 FROM
 CLINTON STREET TO MAPLEWOOD AVENUE
 IN THE CITY OF LOS ANGELES, CALIFORNIA
 IN ACCORDANCE WITH ORDINANCES NOS. 56066 AND 57736
 JOHN C. SHAW CITY ENGINEER MAY 1927
 SCALE 1 INCH = 50 FEET

NOTES

*Land to be condemned shown colored red.
 Dotted lines with dimensions show properly holdings
 in those cases where they differ from recorded subdivisions.
 Figures in circles indicate the parcel numbers as set forth
 in paragraph VIII of the complaint.*

Superior Court Case No. 232249
 Suit for Condemnation
 Filed Aug. 24, 1927
 City of Los Angeles, Plff.
 vs.
 Mae Rice et al. Def.

*Interlocutory decree rendered May
 25th 1928 - Judg. Bk. 687-235*
 Final judgment in favor of Plff. as
 per map, rendered July 2, 1928.

D: 75-101, O.R. 8260-1-3
 Sheet 5