

Superior Court Case No. 7805-27
City of Los Angeles, Plaintiff
Vs
Pacific Electric Railway Co., Def.
Interlocutory judgment as per
map, rendered Dec. 19th 1929.
Judg. Bk. 746-110.

Final judgment in favor of Plaintiff
as per map, rendered Jan. 31, 1930.

D:79-39, Jdg. Bk. 746-337

Sht. 28

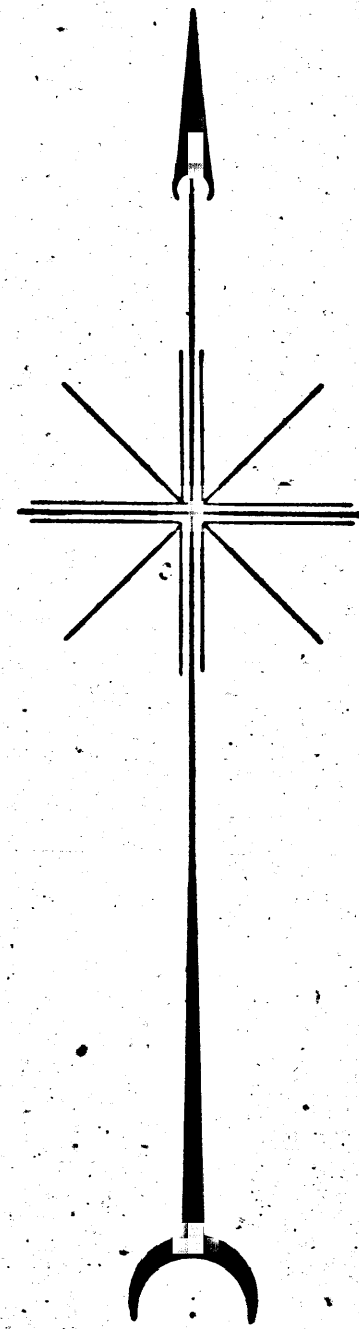
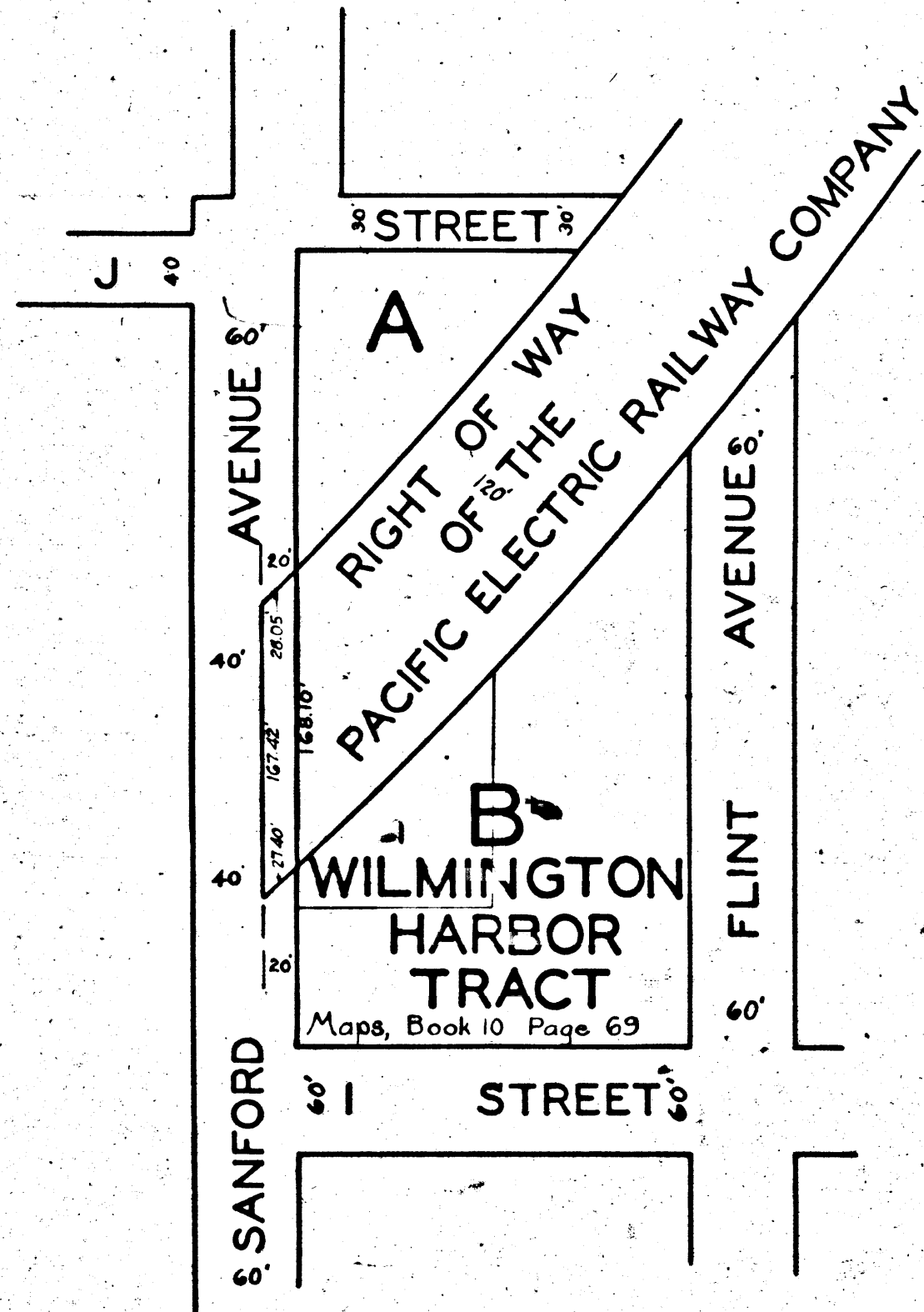

MAP
 SHOWING THE LAND
 TO BE CONDEMNED
 FOR THE WIDENING OF
SANFORD AVENUE
 BETWEEN
 A POINT APPROXIMATELY
 TWO HUNDRED AND SEVENTY-FIVE (275) FEET
 NORTHERLY OF I STREET
 AND
 A POINT APPROXIMATELY
 EIGHTY (80) FEET NORTHERLY OF I STREET
 (WILMINGTON DISTRICT)
 IN THE CITY OF LOS ANGELES CALIFORNIA
 IN ACCORDANCE WITH ORDINANCE NO. 59797
 JOHN C. SHAW CITY ENGINEER JANUARY 1928
 SCALE 1 INCH = 100 FEET

Land to be condemned shown colored red.

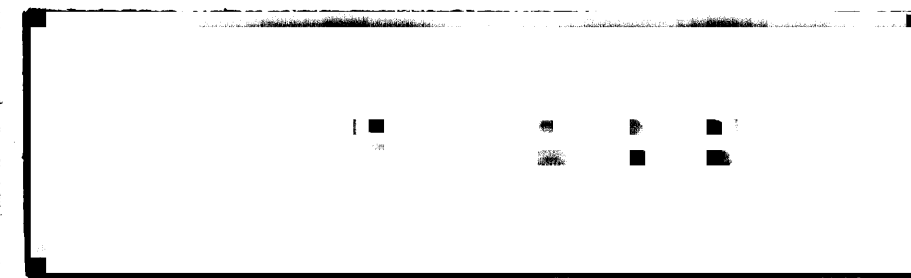

7805-27

PLATE 30

-A-