

MAP
SHOWING THE LAND TO BE CONDEMNED
FOR PUBLIC STREET PURPOSES
EXTENDING FROM THE SOUTHERLY
LINE OF THE NORTHERLY ROADWAY OF
SAN VICENTE BOULEVARD

TO THE
NORTHERLY LINE OF THE SOUTHERLY ROADWAY OF
SAN VICENTE BOULEVARD
AND LYING BETWEEN THE
SOUTHEASTERLY PROLONGATIONS OF THE NORTHEASTERLY
AND SOUTHWESTERLY LINES OF THAT PORTION OF
WESTGATE AVENUE
EXTENDING NORTHWESTERLY FROM
MONTANA AVENUE
IN THE CITY OF LOS ANGELES, CALIFORNIA,
IN ACCORDANCE WITH ORDINANCE NO. 59840
JOHN C SHAW-CITY ENGINEER JANUARY 1928

SCALE 1"=40'

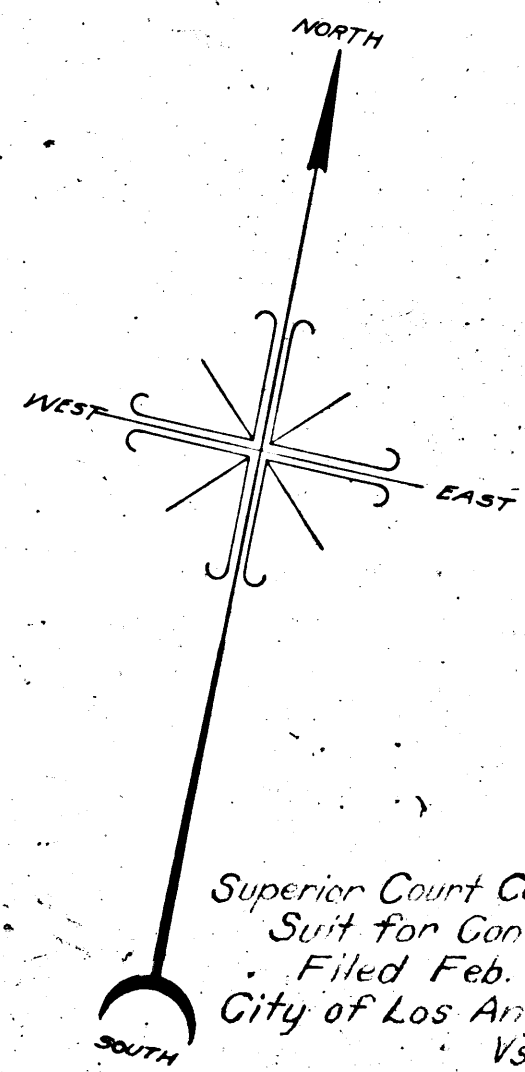
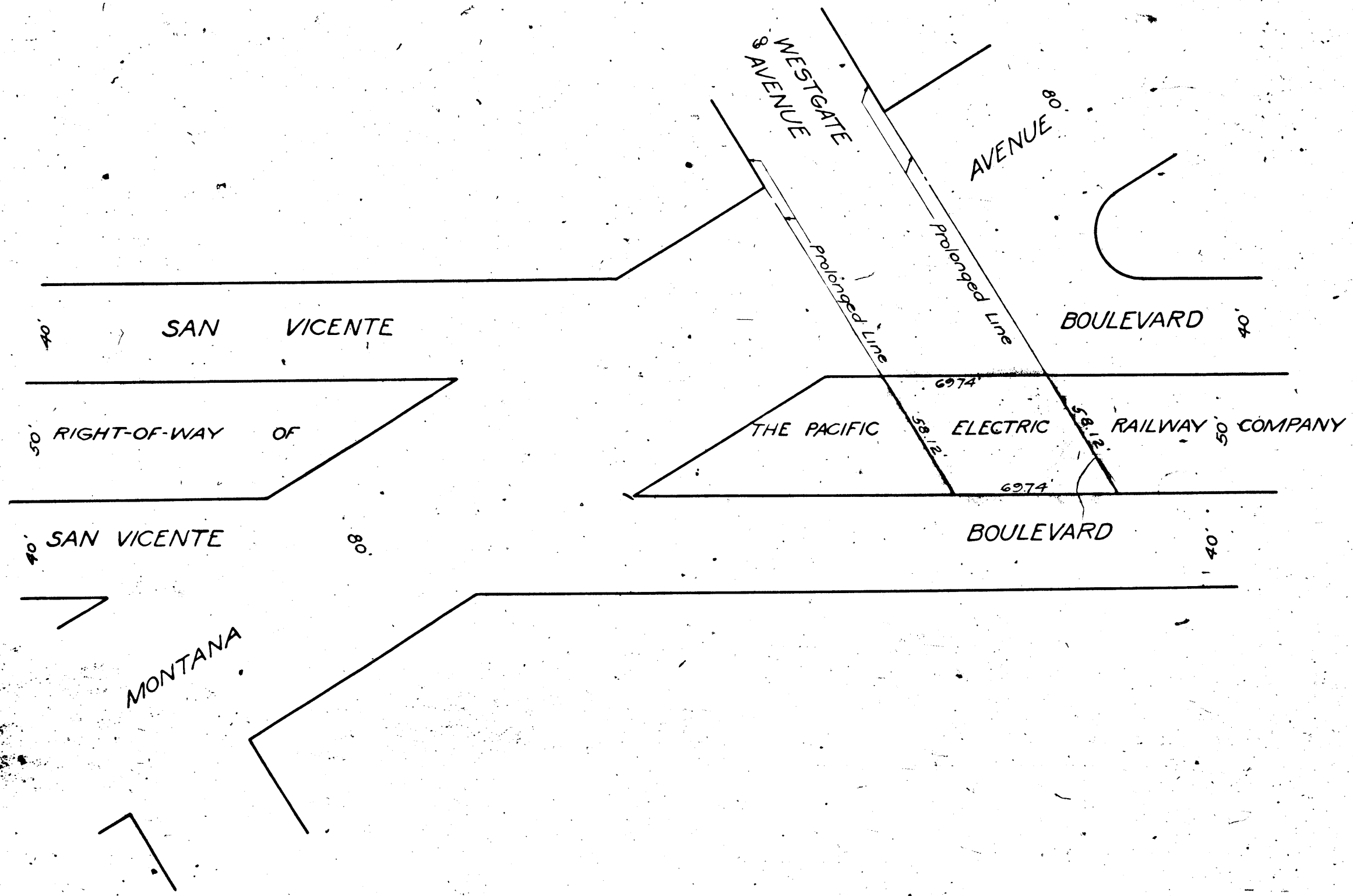

Superior Court Case No. 244496
Suit for Condemnation
Filed Feb. 7th 1928.
City of Los Angeles, Plaintiff
VS
Pacific Electric Railway Co., Def.
Final judgment in favor of Plt'ff. as
per map, rendered Nov. 27, 1928.

Note - Land to be condemned shown colored red.

D: 70-130, O.R. 7340-43
Sht 21

7025-A

6413 MAP 11

7025-A

7025-A

6413 MAP 11

7025-A