

Superior Court Case No. LBC-2013  
Suit for Condemnation  
Filed Sept. 7<sup>th</sup> 1928  
City of Long Beach, Pltff.  
Vs.  
Mary Petersen et. al., Def.

Interlocutory decree rendered 2-28-29  
Final judgment in favor of Pltff, as per  
map, rendered March 17, 1930  
D:80-81 O.R. 9813-234

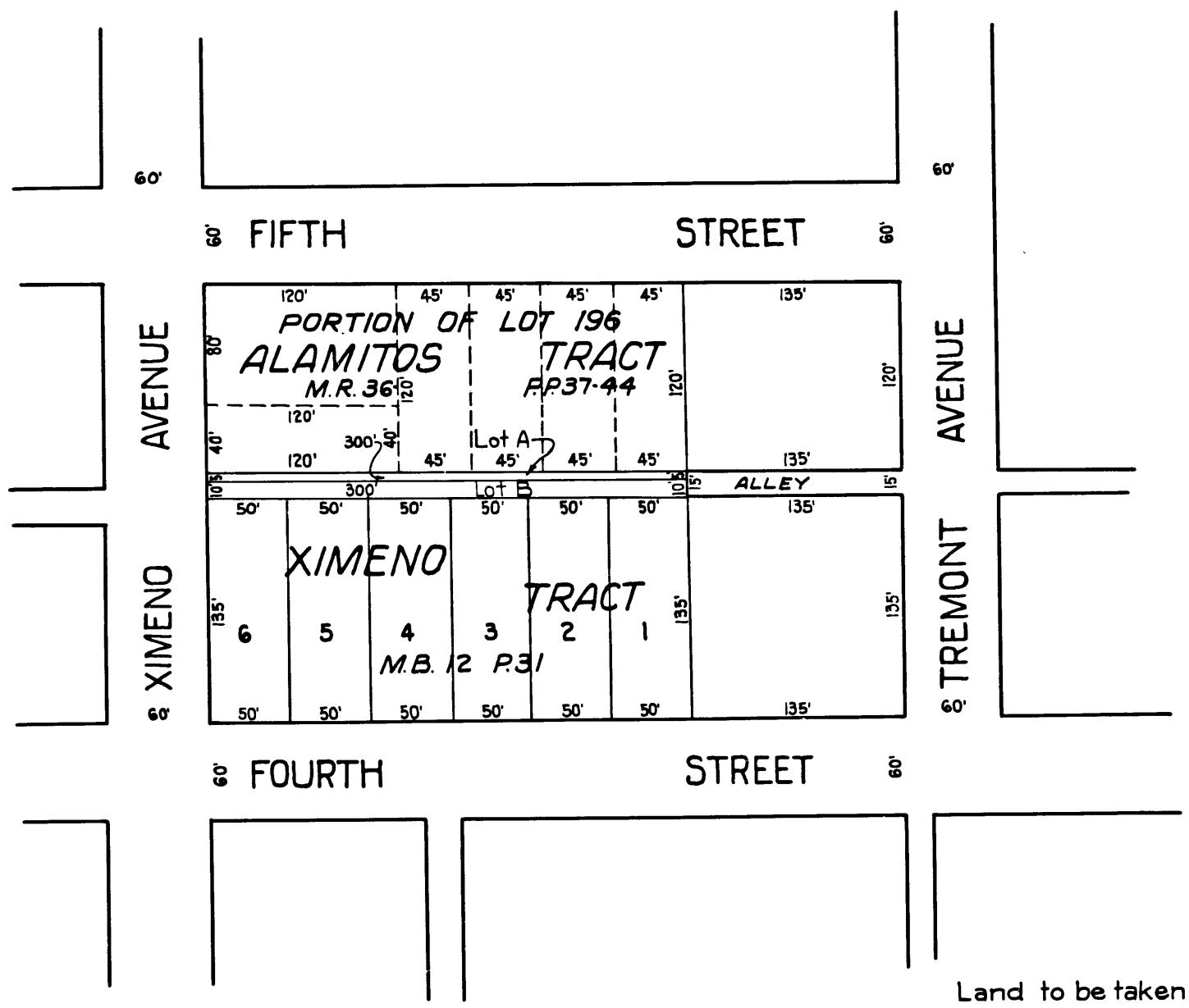

Land to be taken shown in red.

Sht. 31  
A-66

EXHIBIT 'C'

C.F. 1656-

VEMCO  
PASADENA, CAL.

VEMCO  
PASADENA, CAL.

7 5 7

7 5 7

1011

1011