

Superior Court Case No. 295348
Suit for Condemnation
Filed Jan. 24, 1930
City of Beverly Hills, Plff.
Vs
Pacific Electric Railway Company, et al. Def.
*Interlocutory judgment as per
map, rendered Dec. 17th 1930.
Judg. Bk. 770-25.
Final Judgment in favor of Pltff. as
per map rendered June 1, 1933.
D:93-160, Judg. Bk. 845-303*

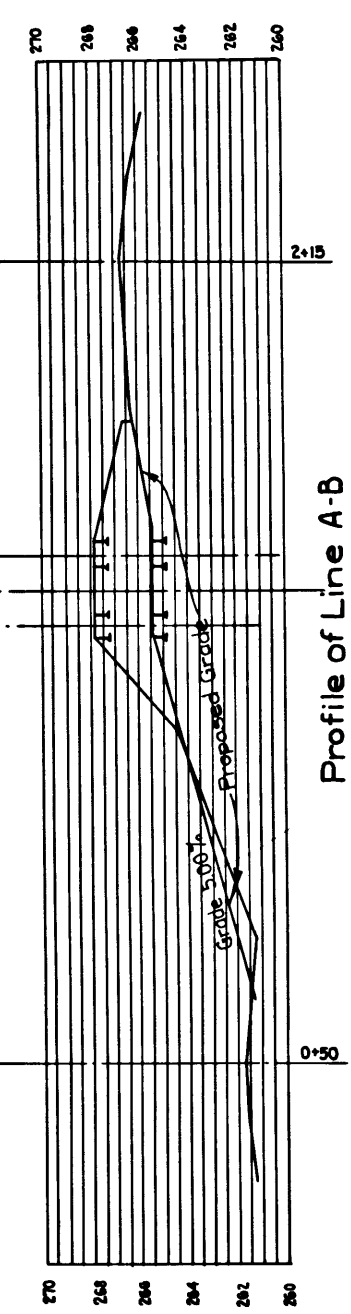
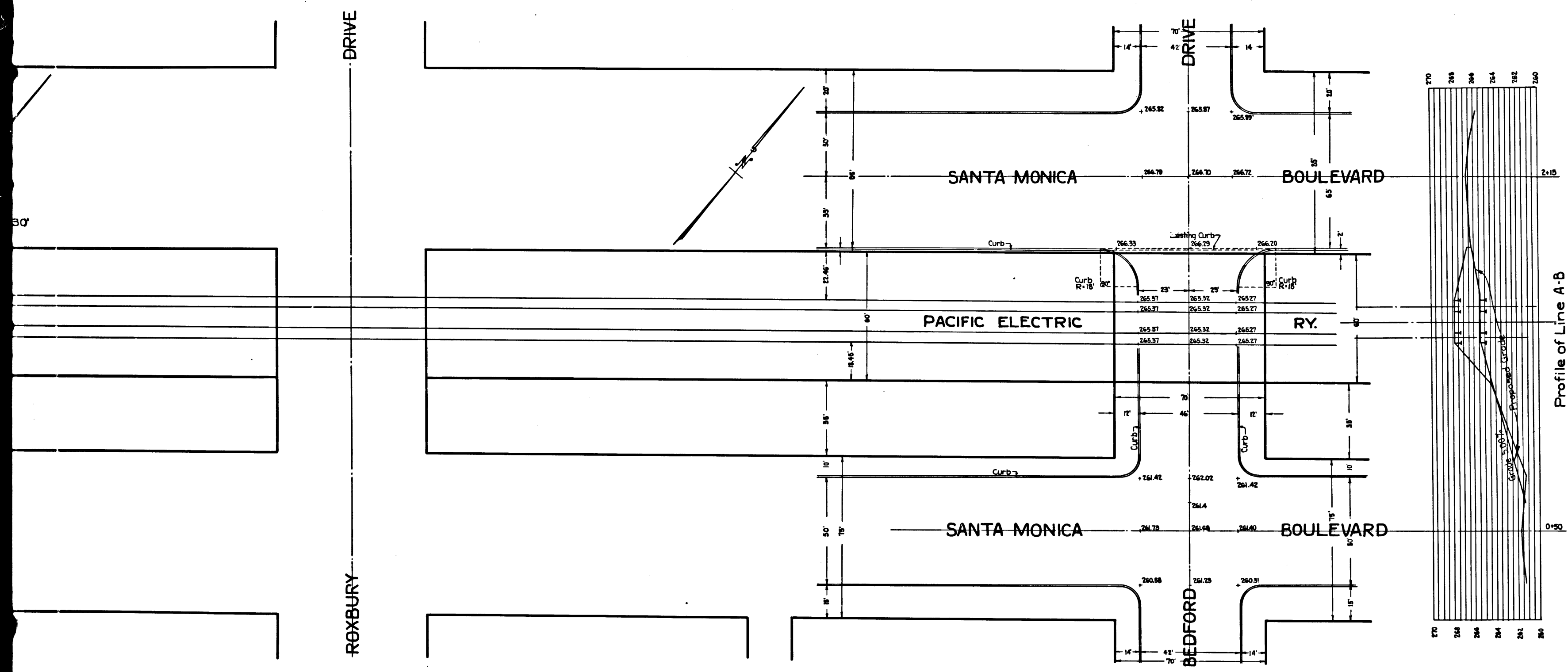

**PROPOSED RAILROAD CROSSINGS
OVER AND ACROSS PACIFIC ELECTRIC RAILWAY (RIGHT OF WAY)
at
LINDEN DRIVE
and
BEDFORD DRIVE
WITHIN THE CITY OF
BEVERLY HILLS. - CALIFORNIA -**

AUGUST, 1929 Sheet 22 WM. R. METZ
CITY ENGINEER

October 1st 1929
William R. Metz Plan and Profile

October 1st 1929
William R. Metz Sheet 2

October 1st 1929
W. R. Metz 806

LEGEND

— Indicates land to be acquired.
- - - proposed grade of the improvement.

C.F. 1766 -

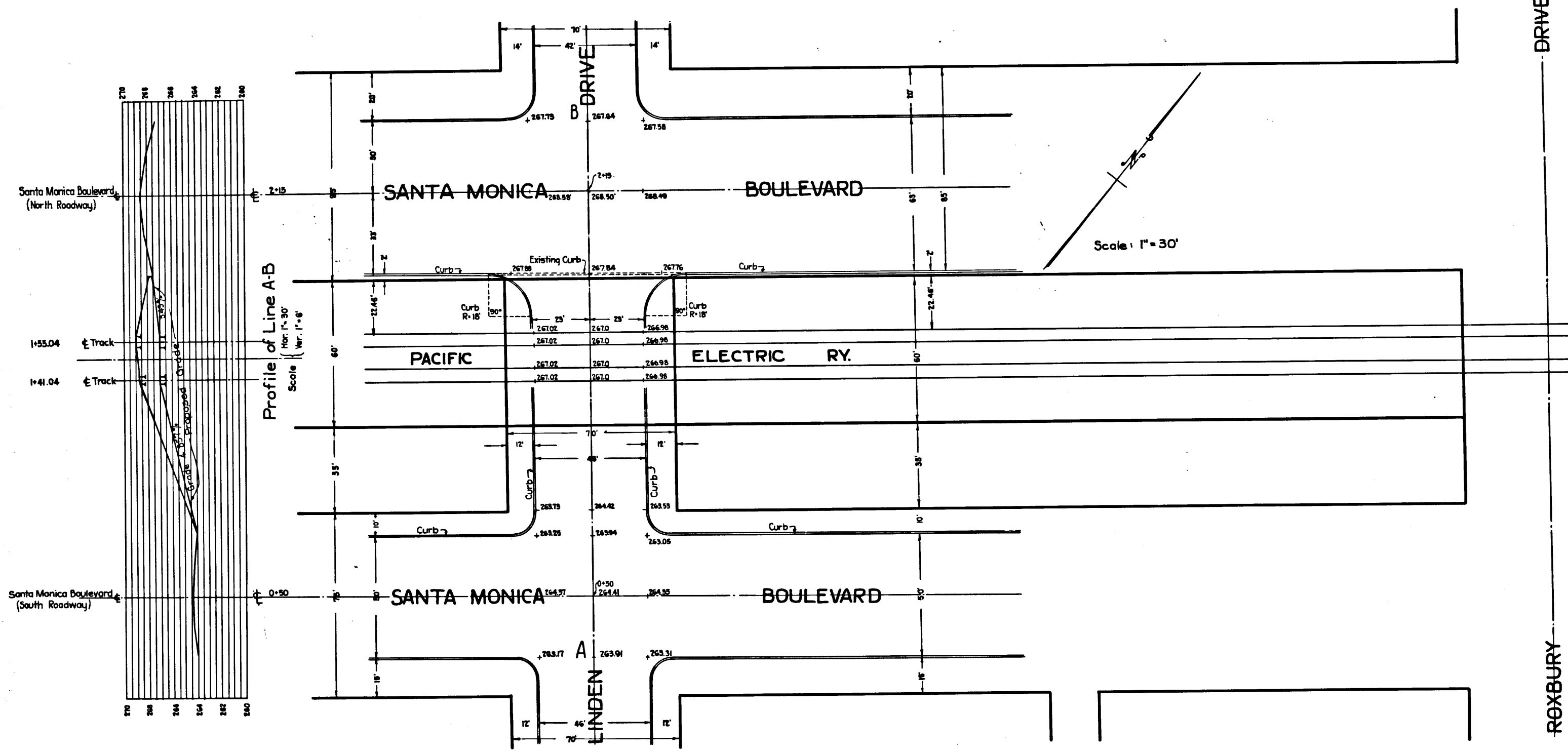
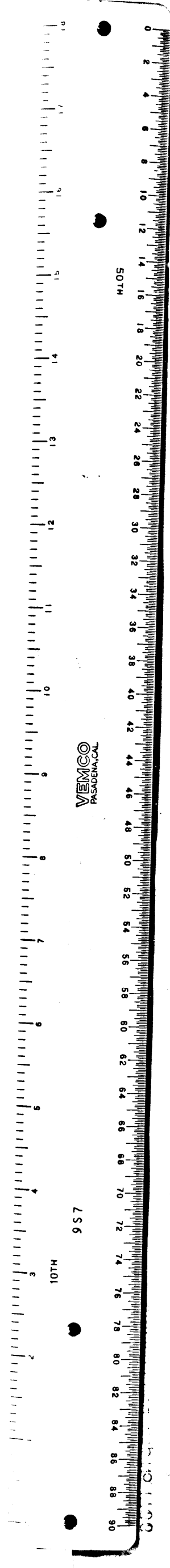

C.F. 1766 - 2