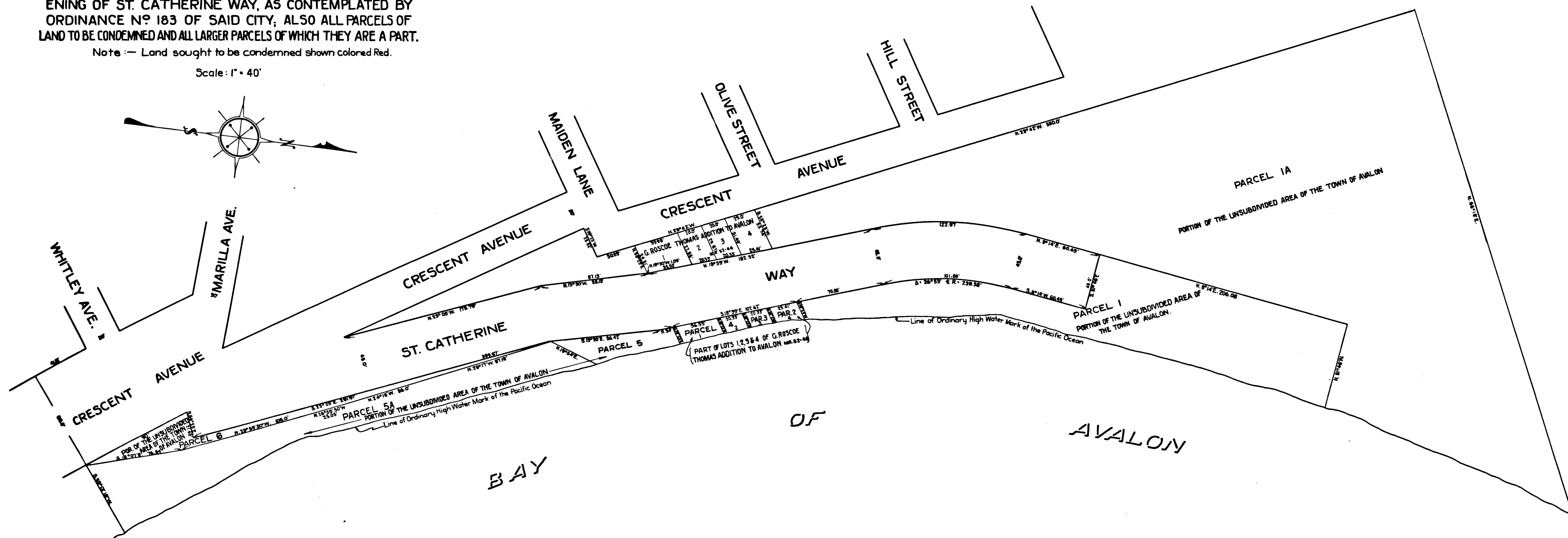
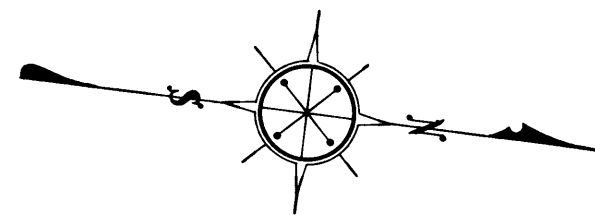

**EXHIBIT 'C'**  
**MAP SHOWING**

LOCATION, GENERAL ROUTE AND TERMINI OF THE RIGHT OF WAY SOUGHT TO BE CONDEMNED IN THE ABOVE ENTITLED ACTION BY THE CITY OF AVALON, CALIFORNIA, FOR THE LAYING OUT, OPENING, EXTENDING AND WIDENING OF ST. CATHERINE WAY, AS CONTEMPLATED BY ORDINANCE N<sup>o</sup> 183 OF SAID CITY; ALSO ALL PARCELS OF LAND TO BE CONDEMNED AND ALL LARGER PARCELS OF WHICH THEY ARE A PART.

Note: — Land sought to be condemned shown colored Red.

Scale: 1" = 40'



Sheet 19  
 Superior Court Case No. 296650  
 Suit for Condemnation  
 Filed Feb. 13, 1930  
 City of Avalon, — Pltff.  
 Vs.  
 Santa Catalina Island Co. et al. Def.  
 Case dismissed Dec. 5, 1934

C.F. 1767 -