

Sht 36.7  
 Superior Court Case No. 302611  
 Suit for Condemnation  
 Filed May, 15, 1930  
 City of Bell, - Plff.

Vs.  
 Louise E. Williams, et al, Def.

Interlocutory judgment as per  
 map, rendered 7<sup>th</sup> 1931. J.J.G.  
 Bk. 792-1.  
 Final judgment in favor of Plff.,  
 as per map, rendered Oct. 13, 1931.  
 D.21-90 C.X. 11217-104

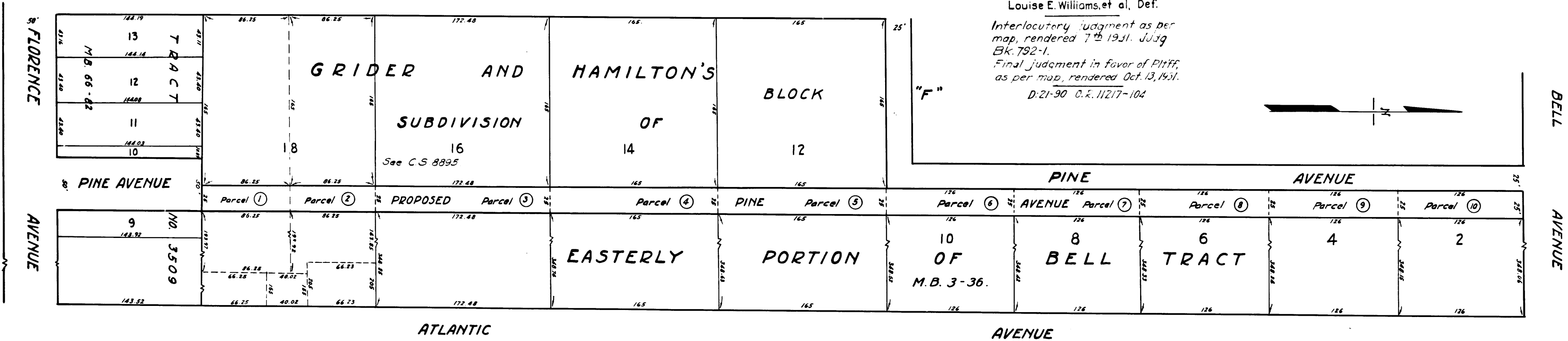

ACQUISITION AND IMPROVEMENT DISTRICT NO. 10,  
 OF THE  
**CITY OF BELL, CALIFORNIA.**  
 FOR THE OPENING OF PINE AVENUE BETWEEN BELL AVENUE  
 AND FLORENCE AVENUE AS PROPOSED HEREIN.

**MAP**

SHOWING THE PROPERTY TO BE ACQUIRED IN ACCORDANCE  
 WITH THE PROVISIONS OF THE "ACQUISITION AND IMPROVEMENT  
 ACT OF 1925" APPROVED MAY 23, 1925, AND  
 AS AMENDED.

**PLAN NO. 1**  
 SCALE 1"=40'

THIS MAP SHOWS THE LOCATION, GENERAL ROUTE AND TER-  
 MINUS OF SAID PUBLIC IMPROVEMENT AND OF ALL PARCELS  
 OF LAND TOUGHT TO BE CONDEMNED AND ALL LARGER PAR-  
 CELS OF WHICH THEY ARE A PART. THIS DRAWING AND  
 THE DATA HEREON ARE HEREBY MADE A PART OF THE  
 SPECIFICATIONS. PORTIONS OF LAND TO BE ACQUIRED  
 FOR STREET PURPOSES ARE SHOWN THUS.

C.F. 1801 -