

10TH 9 5 7

MEMCO PASADENA CAL

50TH

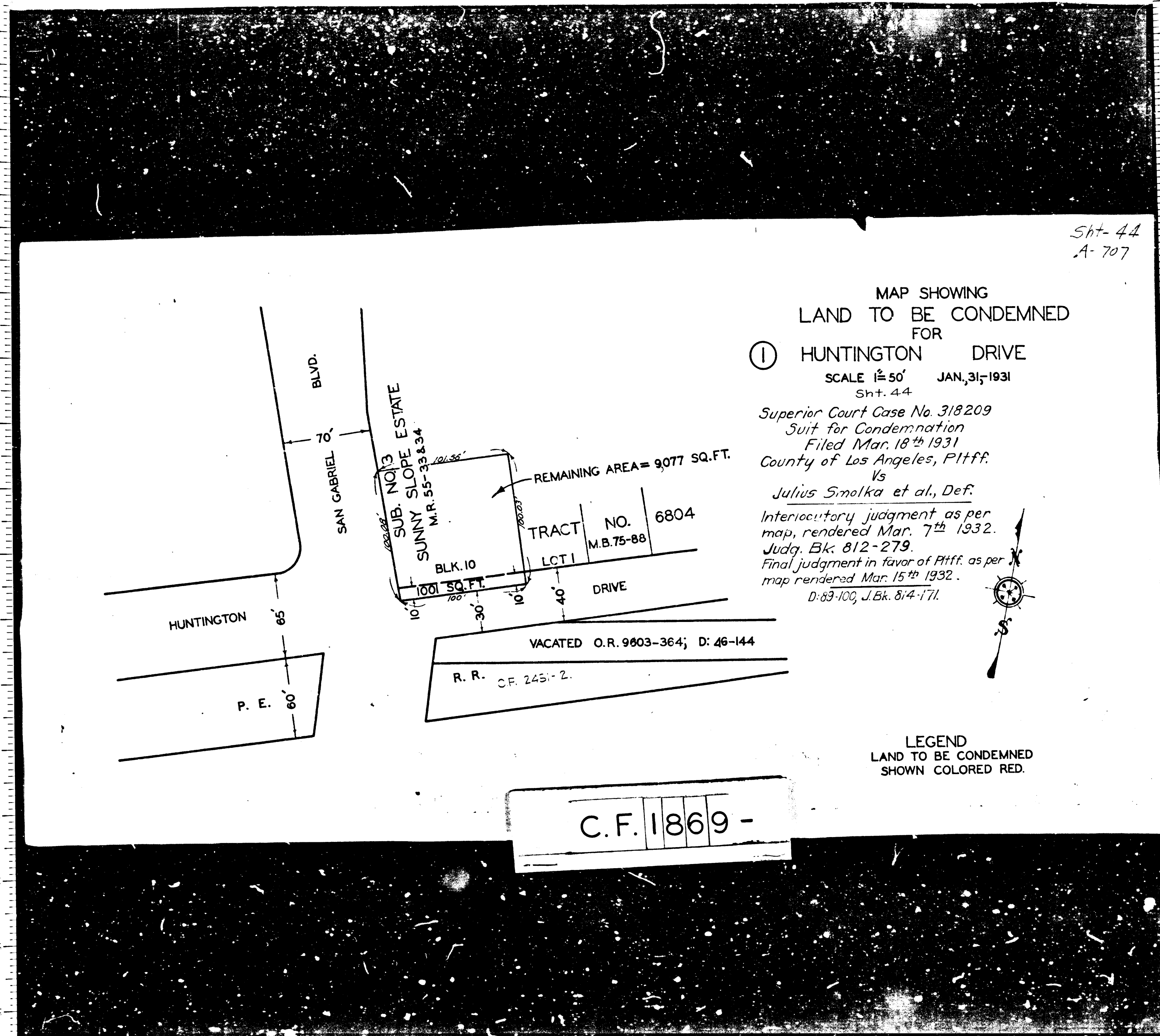

Sht-44
A-707

MAP SHOWING
LAND TO BE CONDEMNED
FOR

① HUNTINGTON DRIVE

SCALE 1" = 50' JAN, 31, 1931
Sht. 44

Superior Court Case No. 318209
Suit for Condemnation
Filed Mar. 18th 1931
County of Los Angeles, Pltff.

Vs
Julius Smolka et al., Def.
Interlocutory judgment as per
map, rendered Mar. 7th 1932.
Judg. Bk. 812-279.
Final judgment in favor of Pltff. as per
map rendered Mar. 15th 1932.
D: 89-100, J. Bk. 814-171.

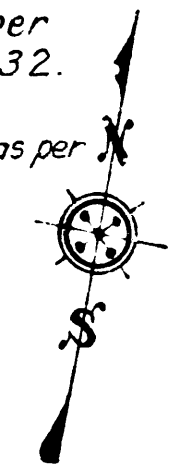

LEGEND
LAND TO BE CONDEMNED
SHOWN COLORED RED.

C.F. 1869 -

10TH 9 5 7

MEMCO PASADENA CAL

50TH