

CHAUTAQUA BLVD W. CHANNEL RD  
& CHANNEL OVER S. P. R/W AT MALIBU ROAD  
FILE NO. 4014-(30) CHARGE NO 12068

V-6120

OS10-A

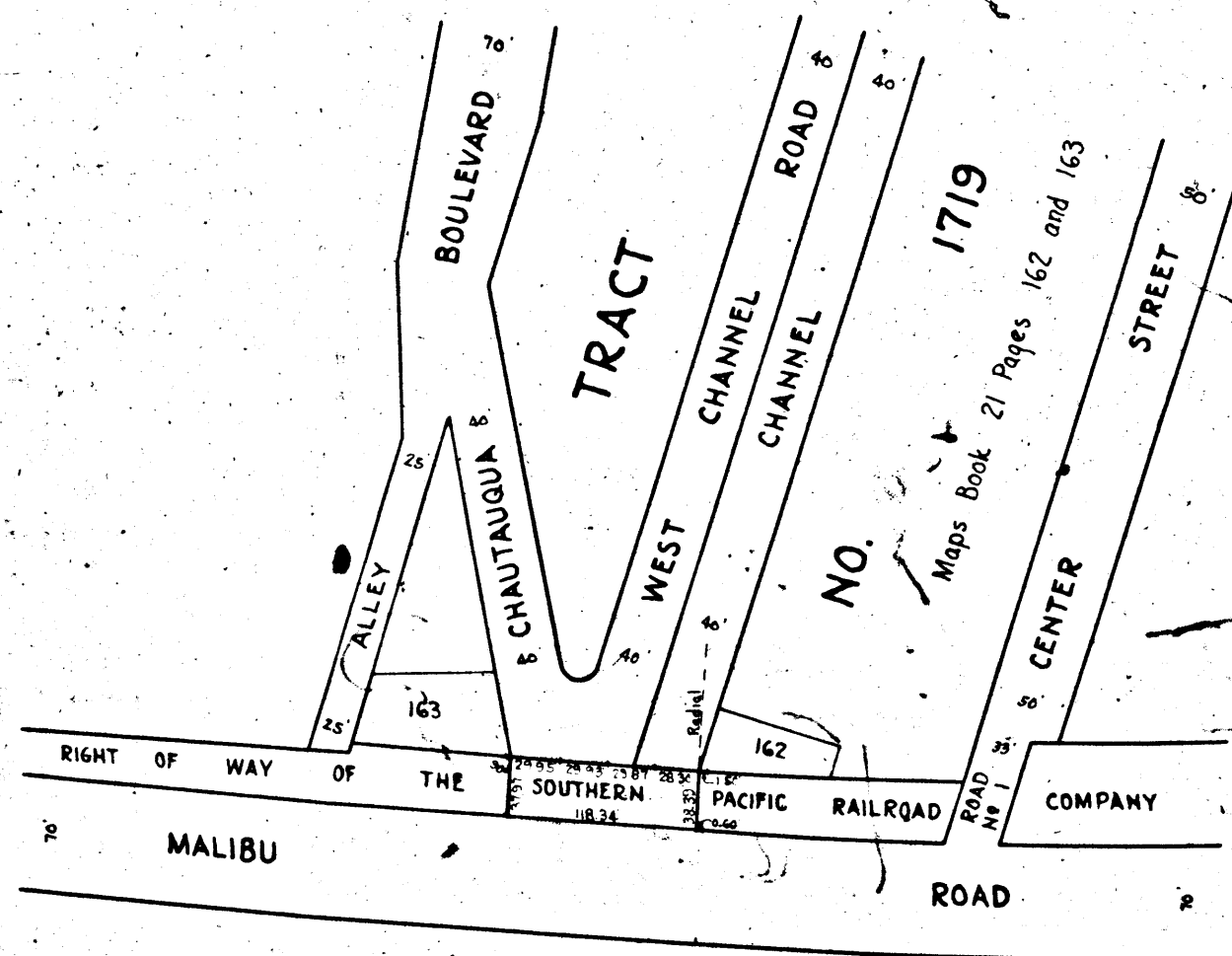

**MAP**  
SHOWING THE LAND TO BE CONDEMNED  
FOR THE  
**OPENING OF A  
PUBLIC STREET**  
ACROSS THE RIGHT OF WAY  
OF THE  
SOUTHERN PACIFIC RAILROAD COMPANY  
LYING  
NORTHEASTERLY OF AND CONTIGUOUS TO  
**MALIBU ROAD**

FROM A POINT  
APPROXIMATELY ONE HUNDRED TWENTY (120) FEET SOUTHEASTERLY  
OF THE NORTHWESTERLY LINE OF CHAUTAUQUA BOULEVARD  
TO SAID  
NORTHWESTERLY LINE OF CHAUTAUQUA BOULEVARD  
IN THE

CITY OF LOS ANGELES, CALIF.  
IN ACCORDANCE WITH ORDINANCE NO. 89402  
J J JESSUP - CITY ENGINEER

SCALE - 1 INCH = 100 FEET MAY, 1931

NOTE:  
LAND TO BE CONDEMNED SHOWN COLORED RED

PACIFIC

OCEAN

*Sht. 58*  
*Superior Court Case No. 324988*  
*Suit for Condemnation*  
*Filed July 20<sup>th</sup> 1931*  
*City of Los Angeles, Plaintiff*  
*Vs.*  
*Southern Pacific R.R. Co., Def.*  
*Case dismissed July 15<sup>th</sup> 1932.*

See C.F. 1937

A-6120

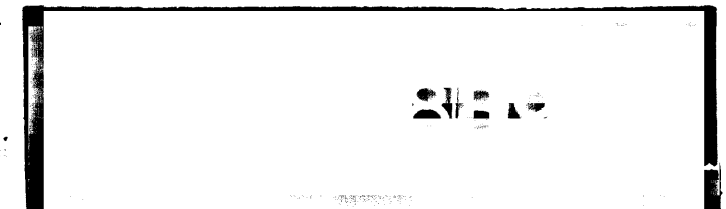

OS10-A