

BOREL ST. & R/W N. OF RAYNOL. ST. SWR. DIST.
FILE NO. 9065-29 CHARGE NO. 94371

Y-0155

SS10-A

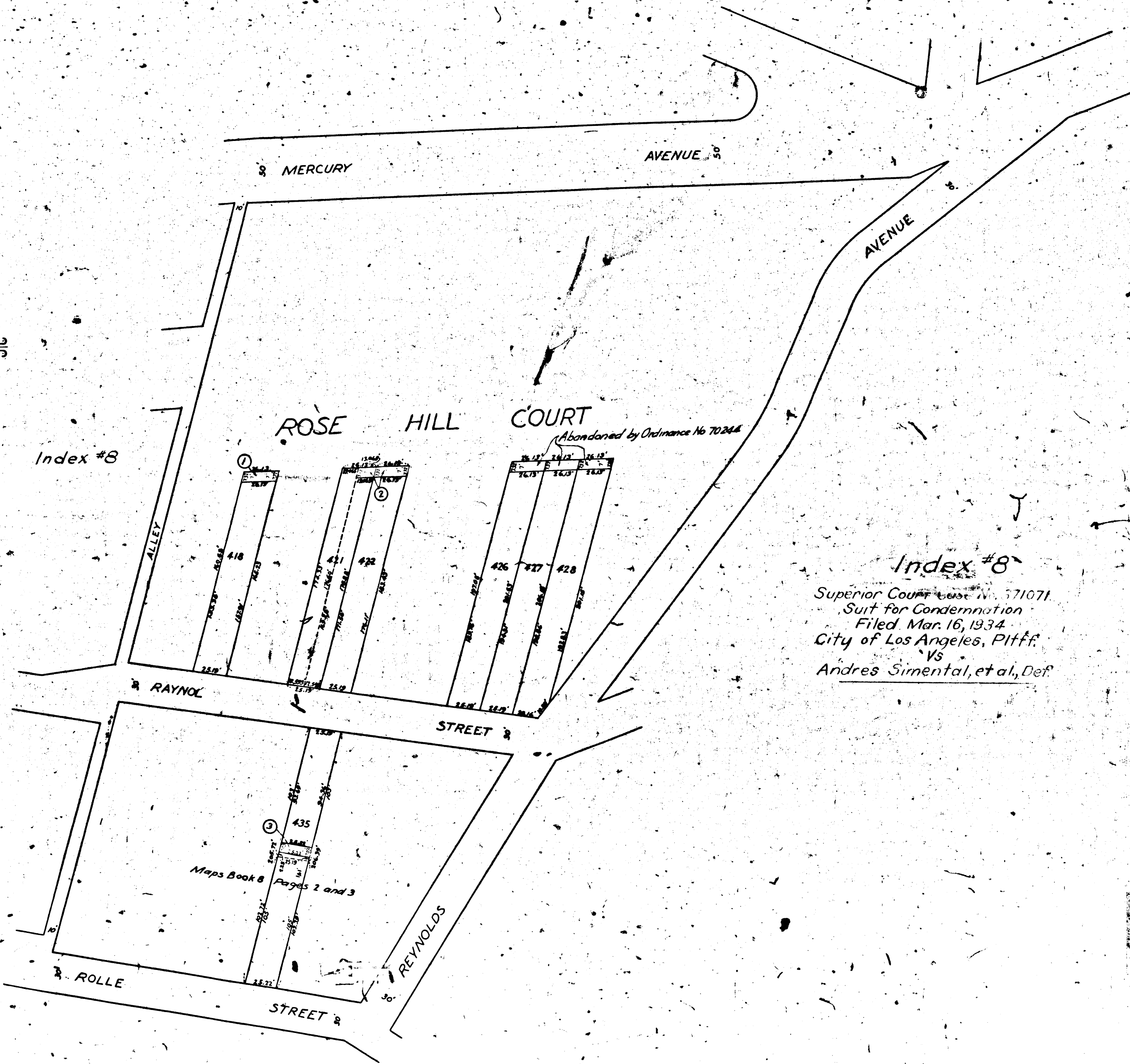
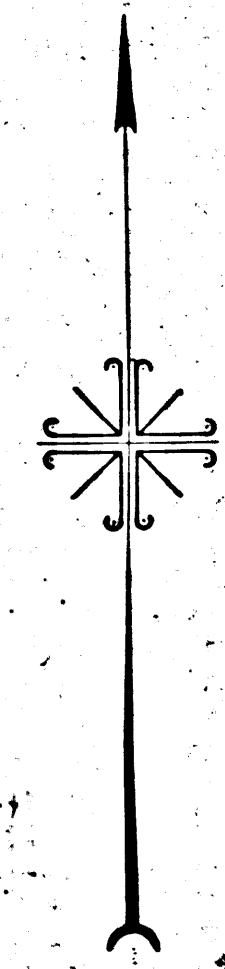

MAP
SHOWING EASEMENTS AND RIGHTS OF WAY
TO BE CONDEMNED FOR
PUBLIC SANITARY SEWER PURPOSES
IN OVER ALONG UPON AND ACROSS
CERTAIN REAL PROPERTY LYING NORTHWESTERLY
OF
REYNOLDS AVENUE
BETWEEN
MERCURY AVENUE
AND
ROLLE STREET
IN THE CITY OF LOS ANGELES CAL.
IN ACCORDANCE WITH ORDINANCES NOS 84114 AND 702
J.J. JESSUP CITY ENGINEER OCTOBER 1931
SCALE 1" = 50'

Index #8
Superior Court Case No. 571071
Suit for Condemnation
Filed Mar. 16, 1934
City of Los Angeles, Plff.
Vs
Andres Simental, et al., Def.

NOTES
Easements and Rights of Way to be condemned shown colored red.
Dotted lines and dimensions show property holdings in those cases where
they differ from the recorded subdivision.
Figures in Circles indicate parcel numbers as set forth in paragraph IX
of the complaint.

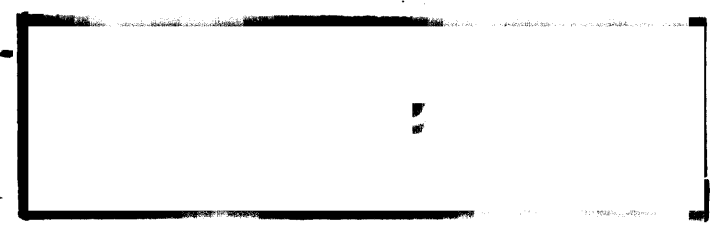

A-C

SS10-A