

Sepulveda Blvd (W.S.) bet. Ohio Ave & Pico Blvd
File No. 937 (1931) Order No. 79234

INDEX 21.
Superior Court Case No. 396648
Suit for Condemnation
Filed Dec. 23, 1931
City of Los Angeles, Plaintiff.
A.M. Free, et al. Defendants.
Case Dismissed 1/25/1932

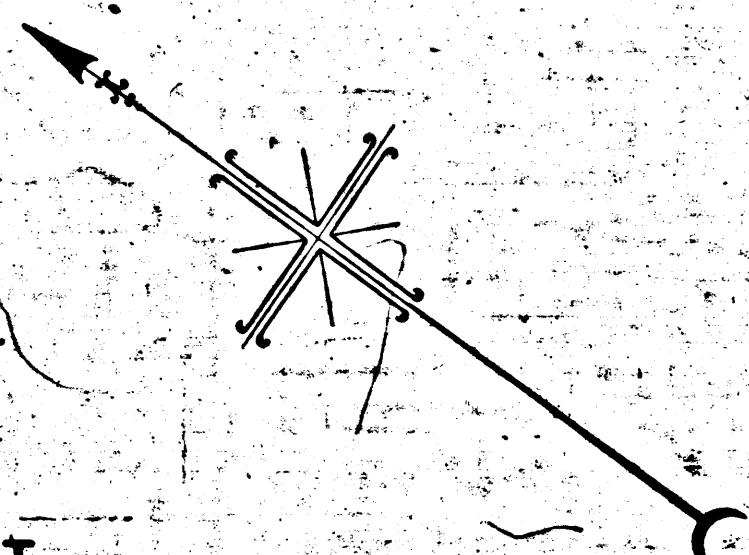

TRACT NO. 5609

SHEETS 1, 2 AND 3
Maps, Book 60, Pages 34, 35 and 36.

Patents, Book 3, Page 30

Condemnation Proceedings pending under
Ordinance Nos. 635171 and 64197

MAP
SHOWING LAND TO BE CONDEMNED FOR
THE WIDENING OF
SEPULVEDA BOULEVARD
ALONG THE SOUTHWESTERLY LINE THEREOF
FROM THE NORTHWESTERLY BOUNDARY OF THE
CITY OF LOS ANGELES
AT
OHIO AVENUE
TO
PICO BOULEVARD
IN THE CITY OF LOS ANGELES CALIF
IN ACCORDANCE WITH ORDINANCE NO 69984
J. J. JESSUP CITY ENGINEER AUGUST 1931
SCALE 1 INCH = 100 FEET

Note: Land to be condemned shown colored red.
Figures in circles indicate the parcel numbers as set forth
in Paragraph V of the complaint.

A-6168

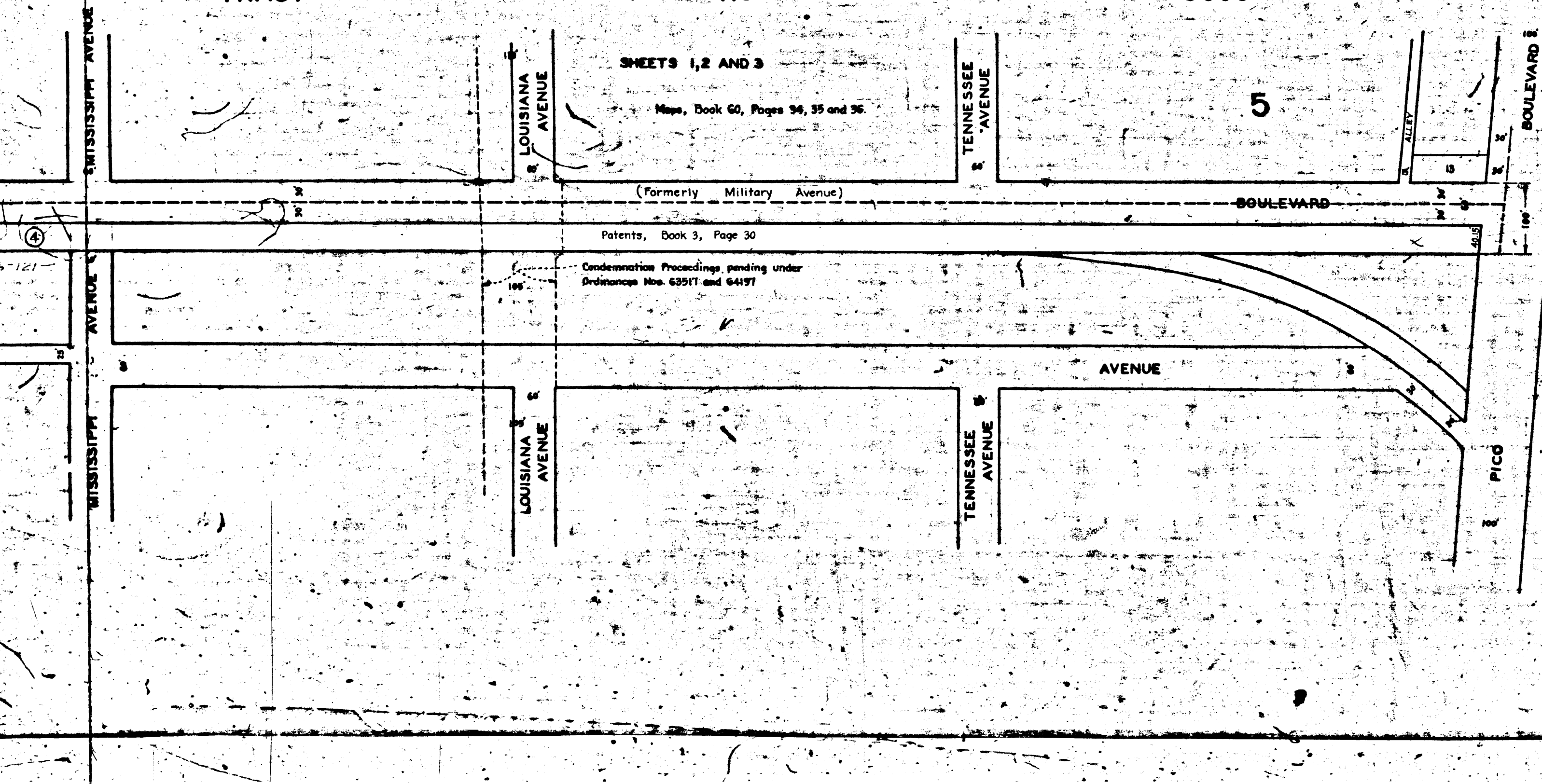

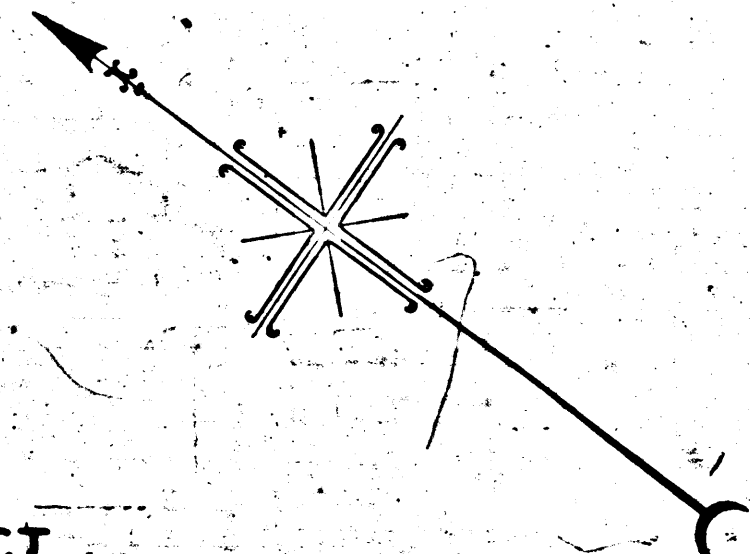

TRACT

NO

SHEETS 1, 2 AND 3

Maps, Book 60, Pages 34, 35

(Formerly Military Avenue)

Patents, Book 3, Page 30

Condemnation Proceedings, pending under Ordinances Nos. 63517 and 64157

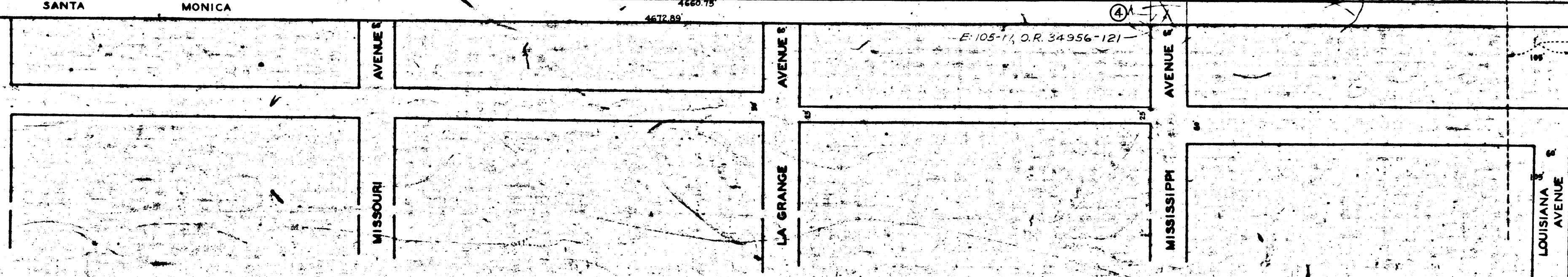
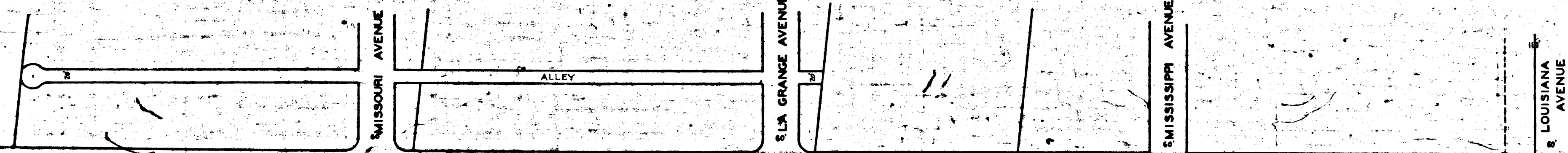

VICENTE Y SANTA MONICA

4680.75
4672.89

E: 105-11, O.R. 34956-121

A-6168



8010-A

8010-A

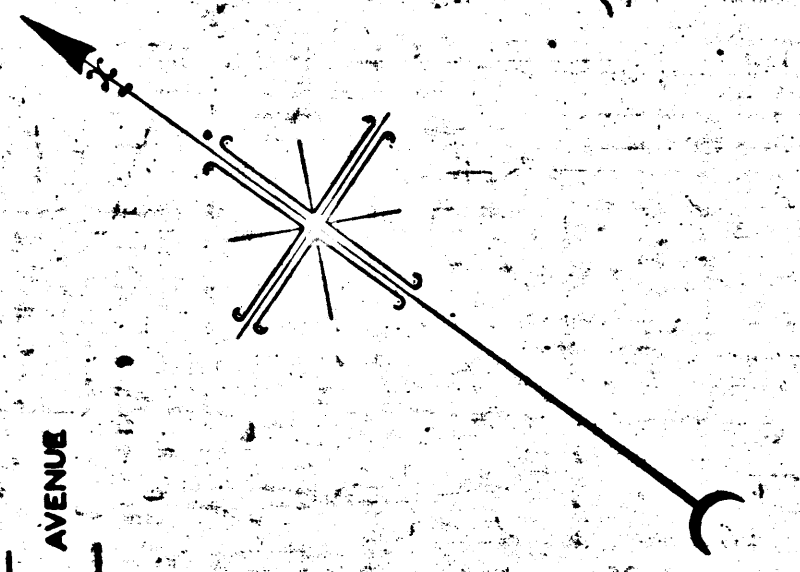

OHIO AVENUE

MASSACHUSETTS AVENUE

ALLEY

SANTA MONICA BOULEVARD

SANTA MONICA BOULEVARD

ALLEY

MISSOURI AVENUE

SEPULVEDA

Prolonged Line

PART ① OF

RANCHO

SAN VICENTE Y

SANTA MONICA

BARRETT VILLA

TRACT

Right to construct and maintain a highway granted to the city of Los Angeles by Southern Pacific Co., Southern Pacific Railroad Co. and Pacific Electric Railway Co. by indenture recorded in Book 4819 Page 76, Official Records of Los Angeles County. Other interests to be acquired.

PONTIUS

AVENUE

PONTIUS

Miscellaneous Records, Book 70,

Pages 32, 33, 34 and 35

SANTA MONICA BOULEVARD

See Highway Commission of Los Angeles Report Page Book 5 Page 120

AVENUE

AVENUE

Boundary of the City of Los Angeles

NEBRASKA

MISSOURI

