

V-0405

S040-A

ALLESANDRO ST. AT RIVERSIDE DR. (S.E. CORNER)
COM. NO. 425-1936 CHARGE AC-60530

S040-A

RETURN TO CITY ENGINEER'S OFFICE
CITY OF LOS ANGELES
PROPERTY OF THE

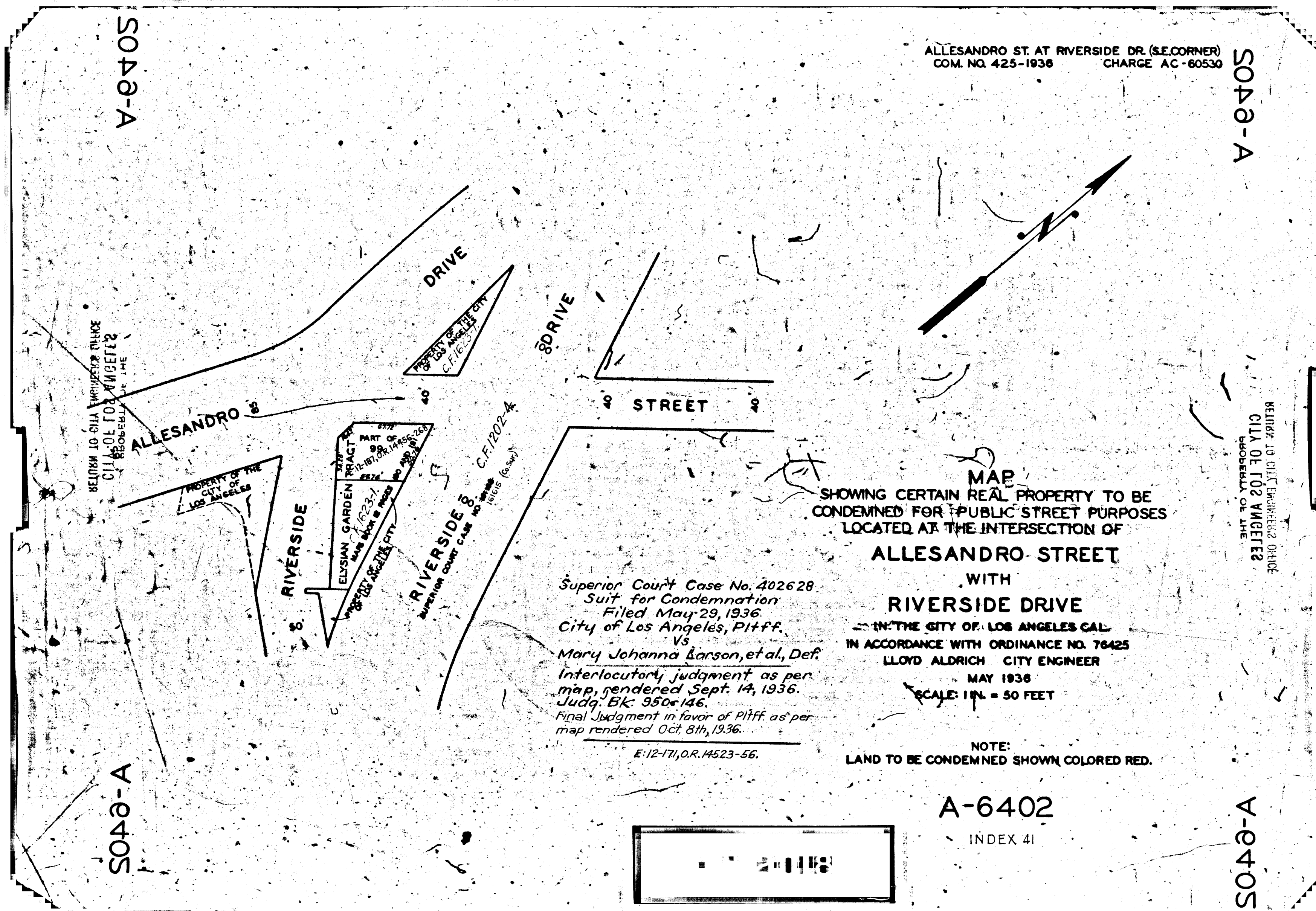

RETURN TO CITY ENGINEER'S OFFICE
CITY OF LOS ANGELES
PROPERTY OF THE

PROPERTY OF THE
CITY OF
Los Angeles

RIVERSIDE

ELYSIAN GARDEN TRACT
PART OF
L. 12-171, O.R. 14523-56
CITY OF LOS ANGELES

RIVERSIDE
SUPERIOR COURT CASE NO. C.F. 1202-A
VERSUS (vs. Sup.)

PROPERTY OF THE CITY
OF LOS ANGELES
C.F. 1623-7

8 DRIVE

STREET

Superior Court Case No. 402628
Suit for Condemnation
Filed May 29, 1936
City of Los Angeles, Plff.
Vs
Mary Johanna Larson, et al., Def.
Interlocutory judgment as per
map, rendered Sept. 14, 1936.
Judg. Bk. 950-146.
Final Judgment in favor of Plff. as per
map rendered Oct. 8th, 1936.

E-12-171, O.R. 14523-56.

MAP
SHOWING CERTAIN REAL PROPERTY TO BE
CONDEMNED FOR PUBLIC STREET PURPOSES
LOCATED AT THE INTERSECTION OF

ALLESANDRO STREET
WITH
RIVERSIDE DRIVE

IN THE CITY OF LOS ANGELES CAL.
IN ACCORDANCE WITH ORDINANCE NO. 76425
LLOYD ALDRICH CITY ENGINEER

MAY 1936

SCALE: 1 IN. = 50 FEET

NOTE:
LAND TO BE CONDEMNED SHOWN COLORED RED.

A-6402

INDEX 41

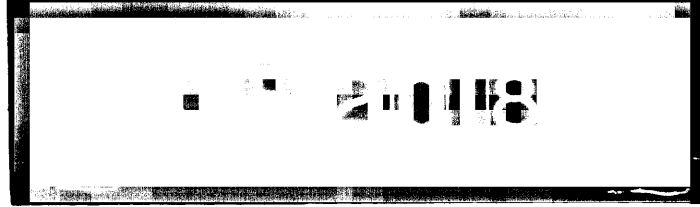

S040-A