

Changes in the location of inlet from the Pacific Ocean into Alamitos Bay of the Rancho Los Alamitos as first surveyed about 1858, the inlet shore of the Ocean Inlet and Bay as shown upon the U.S. Coast and Geodetic Survey charts, the yellow lines indicate the shore of the inlet etc. as it was in 1888 as the inlet being designated by the letters C, C2, the pink lines indicate the shore of the Inlet Bay etc. as surveyed in 1902-3 as surveyed by C.T. Healy, the inlet being designated by the letters D1, D2, the point 'E' representing the more recent shore line of the Inlet at low tide.

Charles T. Healy, July 20, 1903.

Superior Court Case No. 42158
Filed August 14, 1903

Petition of Palos Verdes Company, a Corp., and Alamitos Land Company, a Corp., for order to perpetuate testimony relating to the location of the inlet from the ocean and through the sandspit to Alamitos Bay, at different periods of time.

Depositions of Charles T. Healy, Edward Bouton, George H. Bixby and Jotham Bixby were taken October 28, 1902 by W. J. Variel, Notary Public, on Court order dated August 14, 1903.

On Exhibit A, Healy testified that the red lines (A1 and A2), blue lines, yellow lines and pink lines are lines of high water mark and mark the inlet to the bay at the respective periods; that the inlet shifted from West to East by steady, almost imperceptible action of the sea; that the movement may have been accelerated by the change of the San Gabriel River Channel in 1868.

On Exhibit B, Healy testified that the patent boundary description follows the line of high water mark along the margin and shore of the bay, being the line of high tide; that the actual shore line and line of high water mark are shown by the yellow lines; that Parcels A, B, C, D & E are and were at the time of patent, high land or mesa above line of ordinary high tide.

The other deponents verified the above to the extent of their observation.

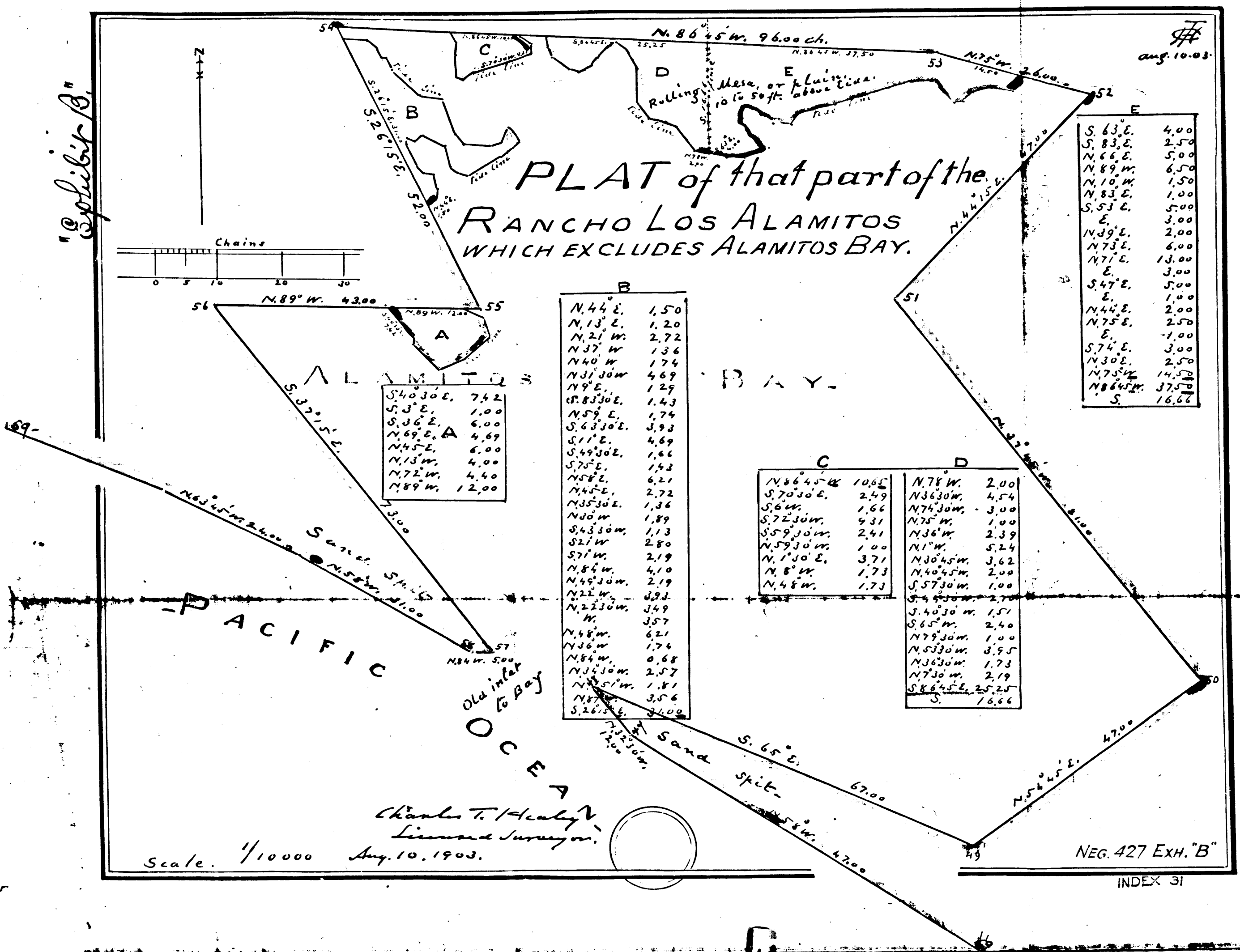

S. 63° E.	4.00
S. 83° E.	2.50
N. 66° E.	5.00
N. 89° W.	6.50
N. 10° W.	1.50
N. 83° E.	1.00
S. 53° E.	5.00
E.	3.00
N. 39° E.	2.00
N. 73° E.	6.00
N. 77° E.	13.00
E.	3.00
S. 47° E.	5.00
E.	1.00
N. 44° E.	2.00
N. 75° E.	2.50
E.	1.00
S. 74° E.	3.00
N. 30° E.	2.50
N. 75° W.	14.50
N. 84° W.	37.50
S.	16.66

N. 44° E.	1.50
N. 13° E.	1.20
N. 21° W.	2.72
N. 37° W.	1.36
N. 40° W.	1.74
N. 31° 30' W.	4.69
N. 9° E.	1.29
S. 83° 30' E.	1.43
N. 59° E.	1.74
S. 63° 30' E.	3.93
S. 11° E.	4.69
S. 49° 30' E.	1.46
S. 70° E.	1.43
N. 58° E.	6.21
N. 45° E.	2.72
N. 35° 30' E.	1.36
N. 30° W.	1.89
S. 43° 30' W.	1.13
S. 21° W.	2.80
S. 71° W.	2.19
N. 84° W.	4.10
N. 49° 30' W.	2.19
N. 22° W.	4.92
N. 21° 30' W.	3.49
W.	3.57
N. 48° W.	6.21
N. 36° W.	1.74
N. 84° W.	0.68
N. 35° 30' W.	2.57
N. 15° 51' W.	1.81
N. 57° W.	3.54
S. 26° 30' E.	3.00

N. 56° 45' W.	10.62
S. 70° 30' E.	2.49
S. 6° W.	1.66
S. 72° 30' W.	4.31
S. 59° 30' W.	2.41
N. 59° 30' W.	1.00
N. 1° 30' E.	3.71
N. 8° W.	1.73
N. 48° W.	1.73

N. 78° W.	2.00
N. 36° 30' W.	4.54
N. 74° 30' W.	3.00
N. 75° W.	1.00
N. 36° W.	2.39
N. 1° W.	5.24
N. 30° 45' W.	3.62
N. 40° 45' W.	2.00
S. 57° 30' W.	1.00
S. 4° 30' W.	2.70
S. 40° 30' W.	1.51
S. 65° W.	2.40
N. 79° 30' W.	1.00
N. 53° 30' W.	3.55
N. 36° 30' W.	1.73
N. 73° 30' W.	2.19
S. 86° 45' E.	25.25
S.	16.66

C.F. 2046-

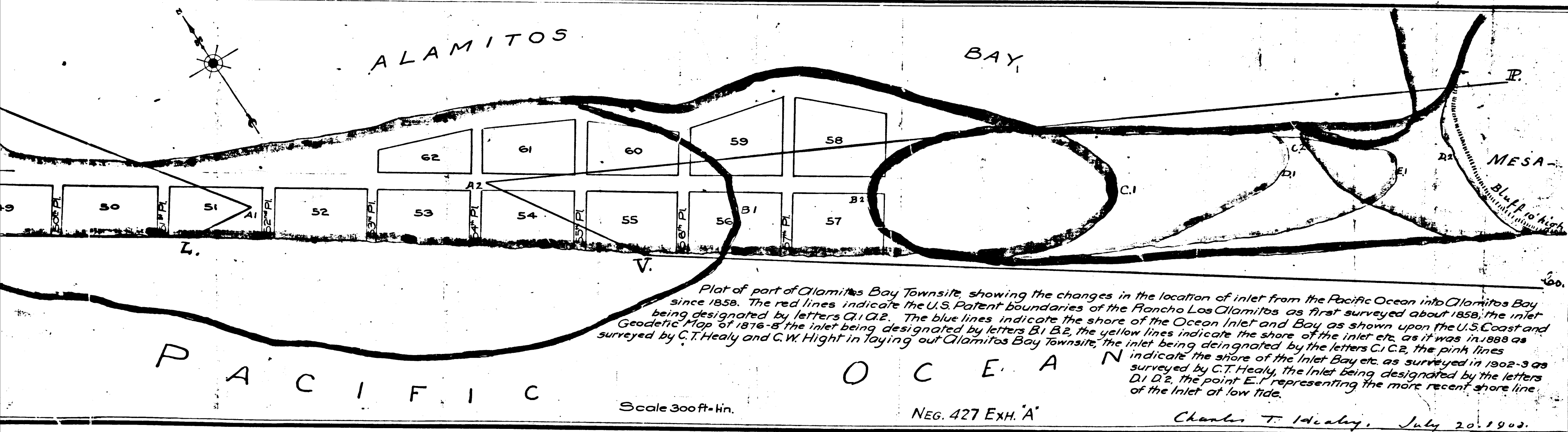

"Exhibit B"

Superior Court Case No. 42158
 Filed August 14, 1903
 Petition of Palos Verdes Company, a Corp., and Alamitos Land Company, a Corp.,
 for order to perpetuate testimony relating to the location of the inlet from the
 ocean and through the sandspit to Alamitos Bay, at different periods of time.

Depositions of Charles T. Healy, Edward Bouton, George H. Bixby and Jotham Bixby were taken October
 28, 1903 by W. J. Variel, Notary Public, on Court order dated August 14, 1903.

On Exhibit A, Healy testified that the red lines (A1 and A2), blue lines, yellow lines and pink lines are lines of high
 water mark and mark the inlet to the bay at the respective periods; that the inlet shifted from West to East by
 steady, almost imperceptible action of the sea; that the movement may have been accelerated by the change of
 the San Gabriel River Channel in 1868.

On Exhibit B, Healy testified that the patent boundary description follows the line of high water mark along the
 margin and shore of the bay, being the line of high tide; that the actual shore line and line of high water
 mark are shown by the yellow lines; that Parcels A, B, C, D & E are and were at the time of patent,
 high land or mesa above line of ordinary high tide.

The other deponents verified the above to the extent of their observation.

2

C.F. 2046-

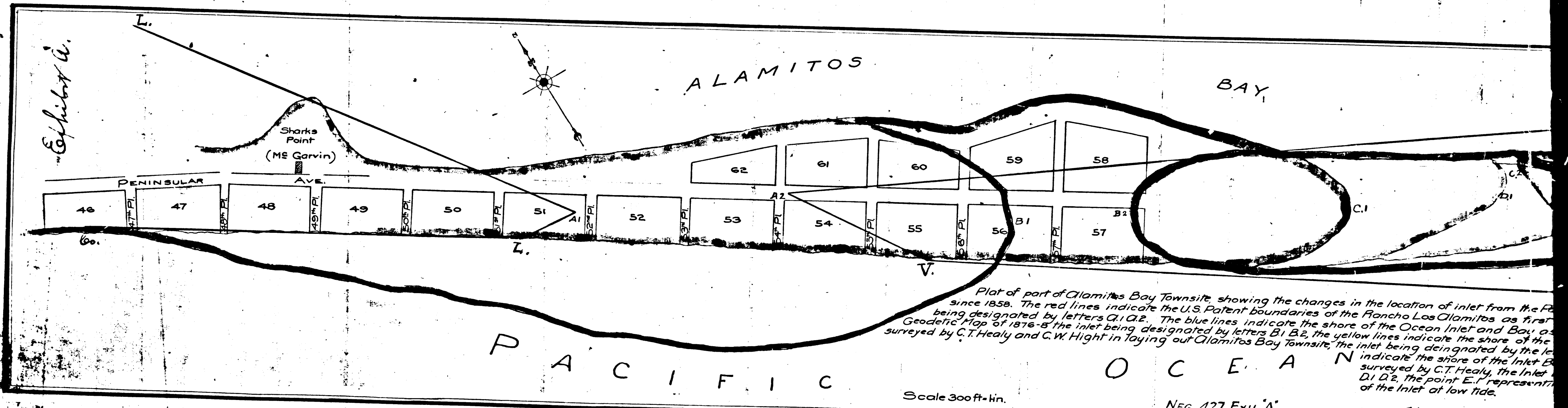

Plat of part of Alamitos Bay Townsite, showing the changes in the location of inlet from the Pacific since 1858. The red lines indicate the U.S. Patent boundaries of the Rancho Los Alamitos as first being designated by letters A1 A2. The blue lines indicate the shore of the Ocean Inlet and Bay as shown on the Geodetic Map of 1876-8 the inlet being designated by letters B1 B2, the yellow lines indicate the shore of the Inlet as surveyed by C.T. Healy and C.W. Hight in laying out Alamitos Bay Townsite, the inlet being designated by the letters C1 D1 D2. The point E1 represents the point of the inlet at low tide.

Scale 300ft. = in.

NEG. 427 EXH. A

Charles T. Healy

Petition of Palos Verass
 for order to perpetuate
 ocean and through the sea

Depositions of Charles T. Healy, Esq.
 28, 1903 by W. J. Variel, Notary Public

On Exhibit A, Healy testified that the red
 water mark and mark the inlet to the
 steady, almost imperceptible action of
 the San Gabriel River Channel in 1868.

On Exhibit B, Healy testified that the
 margin and shores of the bay, basin
 mark are shown by the yellow line
 high land or mesa above line of
 The other deponents verified the

3

C.F. 2046-