

10TH 9 5 7 10TH 9 5 7

Leads 2" old survey map

JM-11

11-ML 9

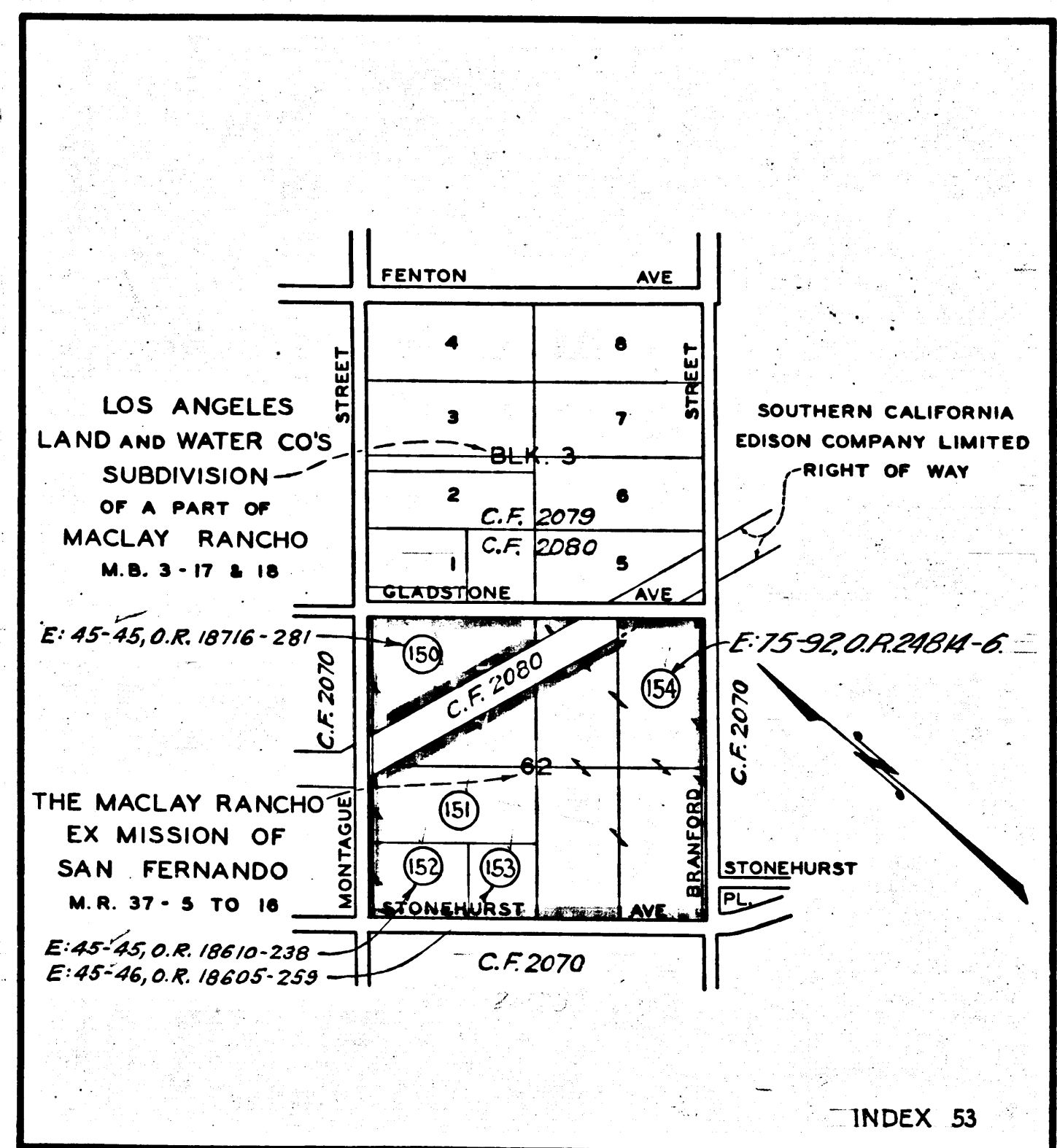

Superior Court Case No. 432797  
 Suit for Condemnation  
 Filed Oct. 10, 1938  
 L.A. Co. Flood Control Dist., Pltff.  
 Vs  
 Harriet Thatcher, et al, Def.  
 Order authorizing Plaintiff to take  
 immediate possession, rendered Oct.  
 26, 1938.  
 Int. judg. as to parcel 150, rendered  
 Oct. 26, 1938. J.B. 1008-311.  
 Partial Int. Judg. as to parcels 150 to  
 154, rendered May 12, 1939. J.B. 1024-122.  
 Int. judg. as to parcels 150, 151 and  
 154, rendered Oct. 5, 1939. J.B. 1041-373.  
 Int. judg. as to parcel 154, rendered  
 July 28, 1939. J.B. 1038-72.  
 Int. judg. as to parcel 152, rendered  
 Oct. 25, 1939. J.B. 1045-29.  
 Int. judg. as to parcel 153, rendered  
 Nov. 15, 1939. J.B. 1047-114.  
 Int. judg. as to parcels 151 and 154,  
 rendered Feb. 15, 1940. J.B. 1060-285.  
 Final judgment in favor of Pltff. as per map  
 rendered - March 26, 1940  
 E: 34-156, O.R. 17381-234  
 Final judgment in favor of Pltff. as to  
 parcels 151, 154 rendered Jan. 26, 1942  
 E: 45-113, O.R. 19106-157

REFERENCES		REVISIONS		LOS ANGELES COUNTY FLOOD CONTROL DISTRICT	
		DATE	DESCRIPTION		
C.I. 53				CONDEMNATION MAP TUJUNGA WASH HANSEN FLOOD CONTROL BASIN SECOND ACQUISITION APPROVED BY: <i>[Signature]</i> CHIEF ENGINEER	
II - RW 7.1 (INDEX)					
II - RW 7.7					
II - RW 7.10					
II - ML 7 (COND)				RECOMMENDED BY: <i>[Signature]</i> SENIOR ASSISTANT CHIEF ENGINEER	SCALE: 1" = 600' DATE: 9-7-38 NO. 11-ML 9

JM-11

11-ML 9

C.F. 2071-