

2222-A

2222-A

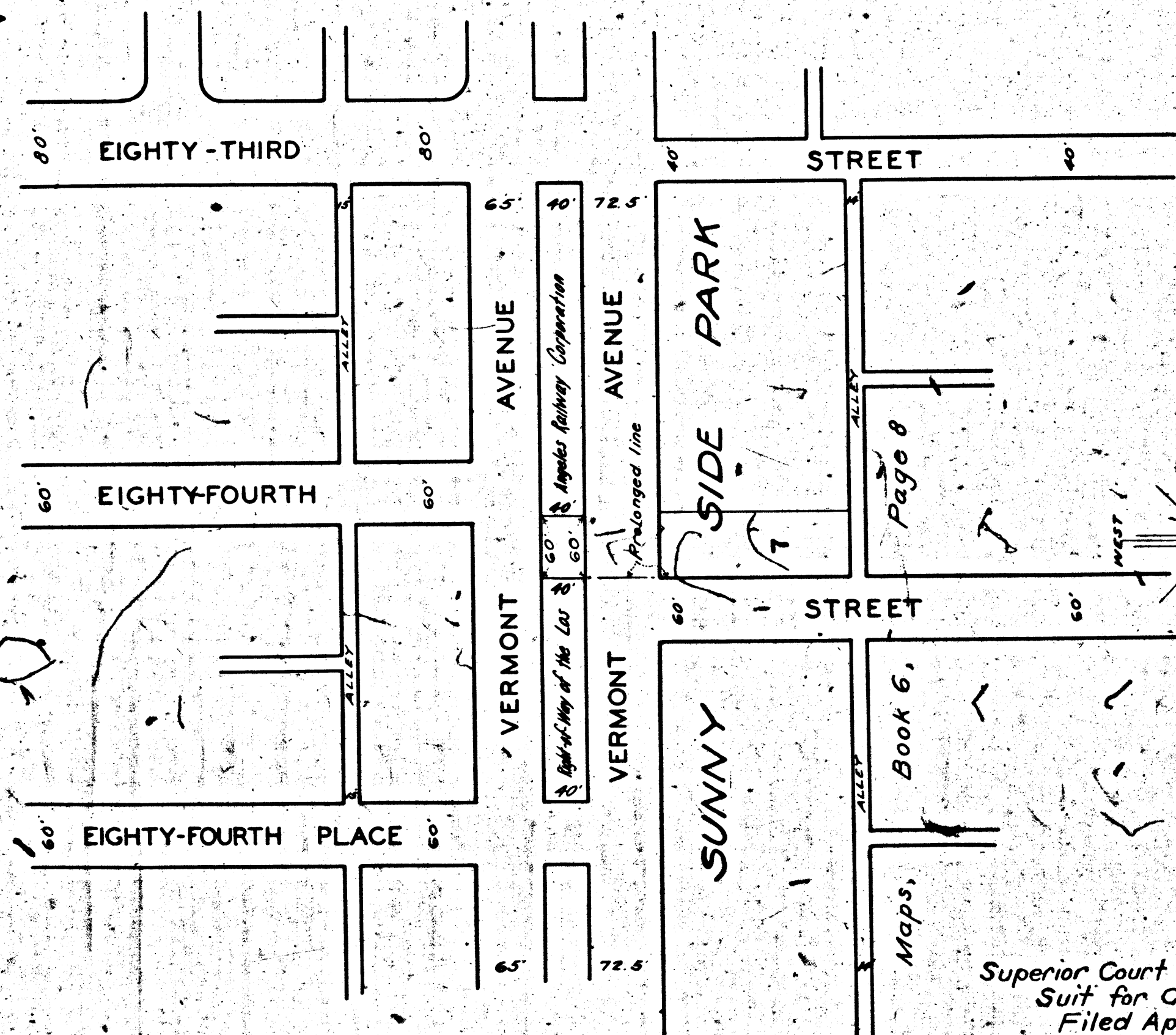

MAP.  
 SHOWING CERTAIN REAL PROPERTY TO BE  
 CONDEMNED FOR PUBLIC STREET PURPOSES  
 ACROSS THE RIGHT-OF-WAY OF THE  
 LOS ANGELES RAILWAY CORPORATION  
 BETWEEN THE EASTERLY AND WESTERLY ROADWAYS OF  
 VERMONT AVENUE  
 AT EIGHTY-FOURTH STREET  
 IN THE CITY OF LOS ANGELES CALIFORNIA  
 IN ACCORDANCE WITH ORDINANCE NO. 80825  
 LLOYD ALDRICH-CITY ENGINEER FEBRUARY 1939

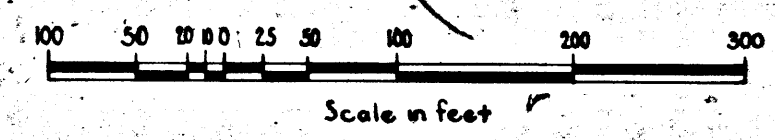

NOTE:  
 Real property to be condemned shown colored red.

RETURN TO CITY ENGINEER'S OFFICE  
 CITY OF LOS ANGELES  
 DEPARTMENT OF PUBLIC WORKS

RETURN TO CITY ENGINEER'S OFFICE  
 CITY OF LOS ANGELES  
 DEPARTMENT OF PUBLIC WORKS

Superior Court Case No. 439654  
 Suit for Condemnation  
 Filed Apr. 18, 1939  
 City of Los Angeles, Plaintiff  
 Vs.  
 Anna M. Wagner, et al., Def.

Interlocutory judgment as per  
 map, rendered July 2, 1940.  
 J.B. 1065-1.  
 Final Judgment in favor of Plaintiff.  
 E-37-229, OR 17798-368

Right of Way No.	4918	Improvement of
84' x 51' across L.R. R.W. in Vermont Ave		
Order No. 83235		
Clerk's File	3561-30	Dist. Map 4842 Div. Index 228-6
Sewers/Storm Drains	Required	19 By
Calc.	Traced	Drawn Ckd
Submitted	Feb. 7 1939	Div. Dist. Engr. E. H. [Signature]
Submitted	Feb. 10 1939	Deputy Engr. [Signature]
Approved	Feb. 19 1939	City Engineer [Signature]

A-6555

A-0222

A-0222

