

Superior Court Case No. 595106
 Suit for Condemnation
 Filed Jan. 25, 1952
 County of Los Angeles Pltff.
 v. S.
 Blanche T. Miller et al Defts
 FOR CURRENT STATUS
 SEE INDIVIDUAL PARCELS

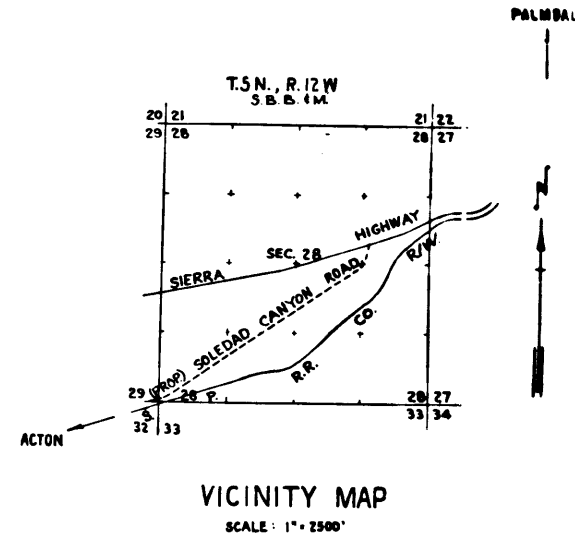

C.F. 2440 -

EXHIBIT "A"
 MAP SHOWING PROPERTY TO BE ACQUIRED
 FOR THE OPENING
 OF
 SOLEDAD CANYON ROAD
 AND FOR
 STORM DRAIN

C. E. ARNOLD COUNTY SURVEYOR
 MARCH 1951

LEGEND

NUMBERS IN CIRCLES REPRESENT PARCELS SOUGHT TO BE ACQUIRED
 PORTIONS COLORED RED SHOW EASEMENTS SOUGHT TO BE ACQUIRED
 FOR HIGHWAY PURPOSES.
 PORTION COLORED GREEN SHOWS EASEMENT SOUGHT TO BE ACQUIRED
 FOR STORM DRAIN PURPOSES.

AREAS OF PARCELS SOUGHT TO BE ACQUIRED SHOWN
 THUS: 1. 20000 ± AREA OF HOLDING IN ACRES

DRAWN BY	DATE	CHECKED BY	DATE	CHECKED BY	DATE
FLENNING	1-51	BREEDEN	3-51	FORD	3-51

REFERENCES
 ALIGNMENT DEED MAP SOLEDAD
 CANYON ROAD SHEET NO. 15A
 TOPOGRAPHY: NONE PER APPRAISERS-1951

J.N. R-120
 INDEX MAP 65 (A-5, B)
 ASSESSOR BOOK 123-2
 SOLEDAD CANYON ROAD 33 STORM DRAIN 51
 ONE SHEET