

Map
of the
Rancho "La Ballona"

Situate in the County of Los Angeles State of California
containing 139 1/4 acres of land according to a
Survey made under instructions from the U.S. Surveyor
General by Henry Hancock DeR Sur in July 1858

showing
The partition made by J.J. Warner H. Thomas &
E.H. Boyd Referees of partition appointed by
order of the District Court of date December 14th 1867

Surveyed under the directions of said
Referees by
G. Hanson
County Sur.
I. Seibold
Dep. County Sur.

Scale of 1 inch to 20 ch^s

COUNTY SURVEYORS MAP NO. 94

In the District Court of the First Judicial District State of
California for Los Angeles County

John D. Young et al
Plaintiffs
vs
Ignacio Machado et al
Defendants

The Referees appointed to make
Partition in the above said County Court this do both
My referend to in our Report of Partition of the date
Los Angeles May 1868

E.H. Boyd
J.J. Warner

See also D.C.C. #2000 - C.F. Map No. 62 - Sh's 1, 2, & 3

No.	Chances	Dist.	Ac.	Cont'd	Dist.
1	3.215	187.2	20	5.64	800
2	5.037	186.0	21	5.59	900
3	5.037	186.0	22	5.59	1000
4	5.763	34.01	23	5.59	1100
5	5.763	34.01	24	5.59	1200
6	5.763	34.01	25	5.59	1300
7	5.763	34.01	26	5.59	1400
8	5.763	34.01	27	5.59	1500
9	5.763	34.01	28	5.59	1600
10	5.763	34.01	29	5.59	1700
11	5.763	34.01	30	5.59	1800
12	5.763	34.01	31	5.59	1900
13	5.763	34.01	32	5.59	2000
14	5.763	34.01	33	5.59	2100
15	5.763	34.01	34	5.59	2200
16	5.763	34.01	35	5.59	2300
17	5.763	34.01	36	5.59	2400
18	5.763	34.01	37	5.59	2500
19	5.763	34.01	38	5.59	2600
20	5.763	34.01	39	5.59	2700
21	5.763	34.01	40	5.59	2800
22	5.763	34.01	41	5.59	2900
23	5.763	34.01	42	5.59	3000
24	5.763	34.01	43	5.59	3100
25	5.763	34.01	44	5.59	3200
26	5.763	34.01	45	5.59	3300
27	5.763	34.01	46	5.59	3400
28	5.763	34.01	47	5.59	3500
29	5.763	34.01	48	5.59	3600
30	5.763	34.01	49	5.59	3700
31	5.763	34.01	50	5.59	3800
32	5.763	34.01	51	5.59	3900
33	5.763	34.01	52	5.59	4000
34	5.763	34.01	53	5.59	4100
35	5.763	34.01	54	5.59	4200
36	5.763	34.01	55	5.59	4300
37	5.763	34.01	56	5.59	4400
38	5.763	34.01	57	5.59	4500
39	5.763	34.01	58	5.59	4600
40	5.763	34.01	59	5.59	4700
41	5.763	34.01	60	5.59	4800
42	5.763	34.01	61	5.59	4900
43	5.763	34.01	62	5.59	5000
44	5.763	34.01	63	5.59	5100
45	5.763	34.01	64	5.59	5200
46	5.763	34.01	65	5.59	5300
47	5.763	34.01	66	5.59	5400
48	5.763	34.01	67	5.59	5500
49	5.763	34.01	68	5.59	5600
50	5.763	34.01	69	5.59	5700
51	5.763	34.01	70	5.59	5800
52	5.763	34.01	71	5.59	5900
53	5.763	34.01	72	5.59	6000
54	5.763	34.01	73	5.59	6100
55	5.763	34.01	74	5.59	6200
56	5.763	34.01	75	5.59	6300
57	5.763	34.01	76	5.59	6400
58	5.763	34.01	77	5.59	6500
59	5.763	34.01	78	5.59	6600
60	5.763	34.01	79	5.59	6700
61	5.763	34.01	80	5.59	6800
62	5.763	34.01	81	5.59	6900
63	5.763	34.01	82	5.59	7000
64	5.763	34.01	83	5.59	7100
65	5.763	34.01	84	5.59	7200
66	5.763	34.01	85	5.59	7300
67	5.763	34.01	86	5.59	7400
68	5.763	34.01	87	5.59	7500
69	5.763	34.01	88	5.59	7600
70	5.763	34.01	89	5.59	7700
71	5.763	34.01	90	5.59	7800
72	5.763	34.01	91	5.59	7900
73	5.763	34.01	92	5.59	8000
74	5.763	34.01	93	5.59	8100
75	5.763	34.01	94	5.59	8200
76	5.763	34.01	95	5.59	8300
77	5.763	34.01	96	5.59	8400
78	5.763	34.01	97	5.59	8500
79	5.763	34.01	98	5.59	8600
80	5.763	34.01	99	5.59	8700
81	5.763	34.01	100	5.59	8800
82	5.763	34.01	101	5.59	8900
83	5.763	34.01	102	5.59	9000
84	5.763	34.01	103	5.59	9100
85	5.763	34.01	104	5.59	9200
86	5.763	34.01	105	5.59	9300
87	5.763	34.01	106	5.59	9400
88	5.763	34.01	107	5.59	9500
89	5.763	34.01	108	5.59	9600
90	5.763	34.01	109	5.59	9700
91	5.763	34.01	110	5.59	9800
92	5.763	34.01	111	5.59	9900
93	5.763	34.01	112	5.59	10000

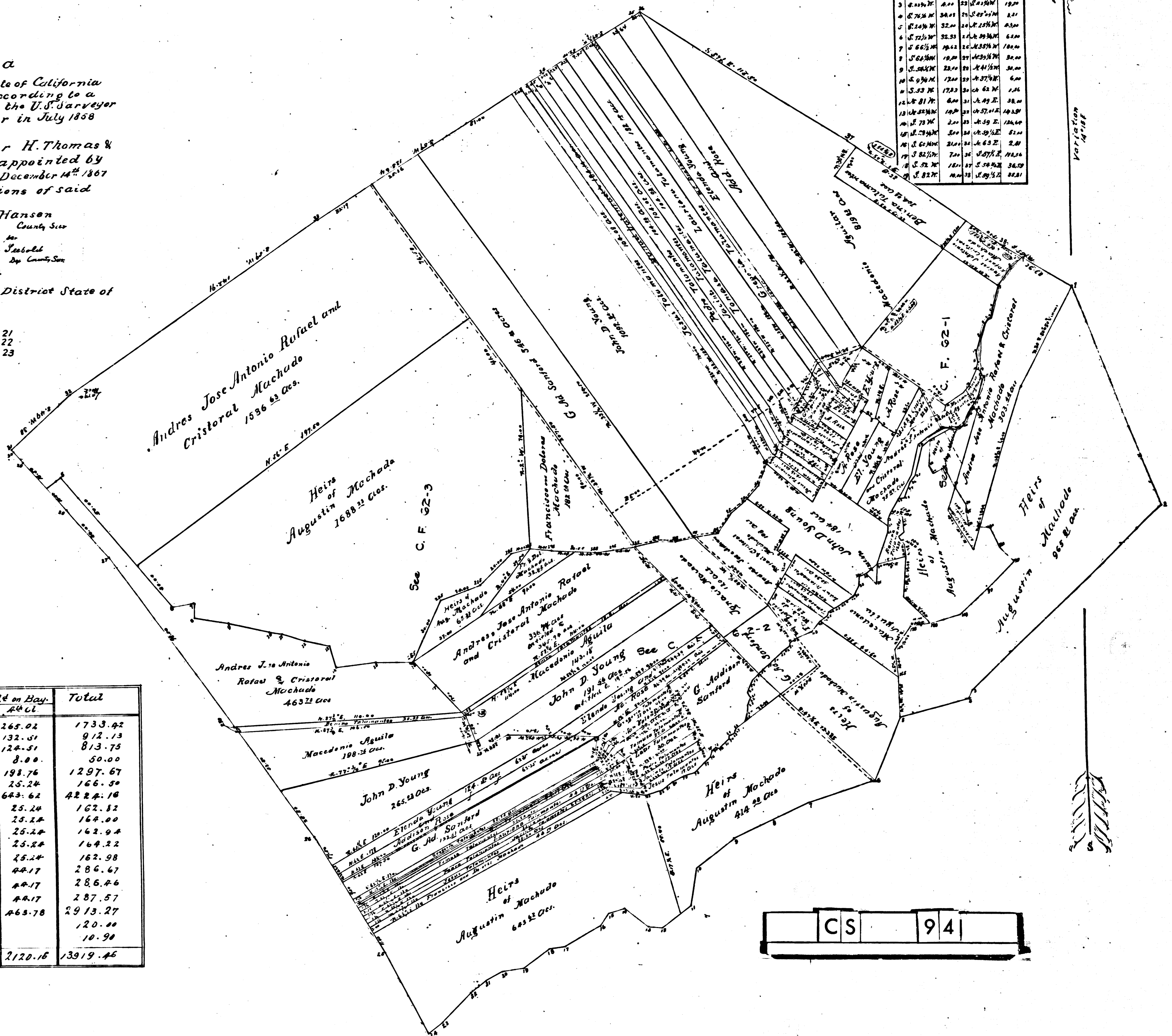

Names	Inters 672 ⁹	Irreparable 1 st cl.	Restored 2 nd cl.	Let on Day 3 rd cl.	Total	
John D. Young	84	124.00	191.56	1092.14	265.02	1733.42
Geo. Ad. Sanford	42	92.00	141.11	546.42	132.51	912.13
Elan Young & A. Rose	42	87.00	92.78	509.46	124.51	813.75
W. G. Prather		5.00	-	37.00	8.00	50.00
Macedo Aguilera	63	136.10	143.18	819.63	198.76	1297.67
Penina Talamante	8	18.37	13.31	104.08	25.24	166.99
Estate of Aug. Machado	204	446.70	479.30	2634.04	643.62	4224.16
Gregorio Talamante	8	16.50	17.00	104.08	25.24	162.82
Tomasa Talamante	8	17.68	17.00	104.08	25.24	164.00
Pedro Talamante	8	16.62	17.00	104.08	25.24	162.94
Jacinto Talamante	8	17.90	17.00	104.08	25.24	164.22
Jesús Talamante	8	16.66	17.00	104.08	25.24	162.98
Luisiano Talamante	14	30.36	30.00	182.14	44.17	286.67
Manuel Valenzuela	14	28.15	30.00	182.14	44.17	286.46
F. & Dol. Machado	14	28.34	32.92	182.14	44.17	287.57
H. J. A. P. U. Machado	147	200.71	336.38	1912.40	465.78	2913.27
Ignacio Machado Road		120.00	-	-	-	120.00
		10.90	-	-	-	10.90
		1473.08	1581.54	8744.69	2120.15	13919.46

CS 94