

Vernon Avenue
 Vermont Ave. to Western Ave.

Oct. 1898, E. T. Wright, Co. Sur.
 Scale E and W 200'-1", N and S 40'-1"
 F.B. 18-37

Sec. 12, T. 2 S. R. 14 W.
 County Surveyors Map No. 3530

I. M. 24

Widening Vernon Ave. to 70' D: 2639-129, D: 10-2

For deeds to L. A. City for Vernon Ave. See:

- D: 31-144 D: 1378-108
- D: 31-145 D: 1374-237
- D: 31-145 D: 1380-166
- D: 31-146 D: 1391-3
- D: 31-146 D: 1391-5

*Retraced from the white bond paper
 original map which has been discarded.*

*Traced by T. Kardos, July, 1957
 Checked by R.J.B.*

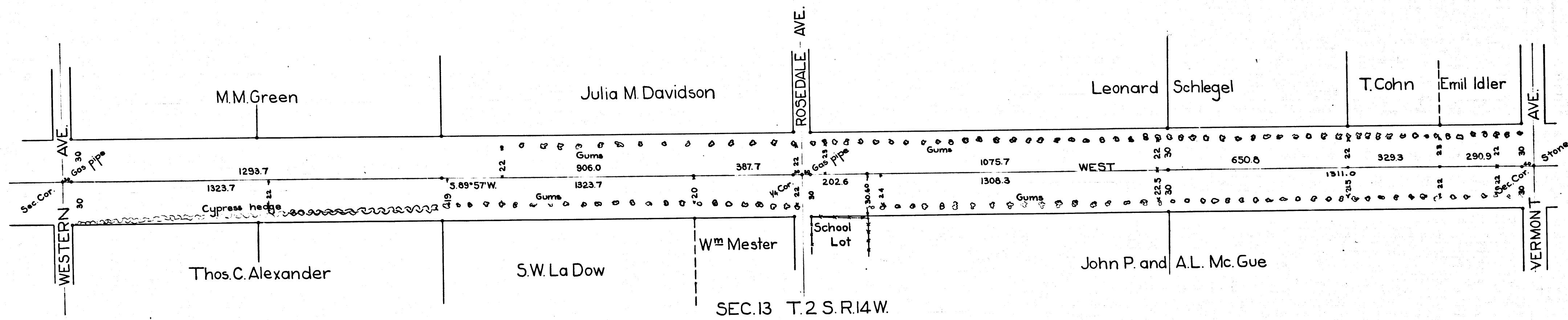

CS 3530