

CS 6664

A1 OF A2

FRANCHO
Nemhall

Land
SAN

Nemhall and Pico Canon Road

St 3 SR

Sec 4

Milling

Capital

Company

Company

FRANCISCO
FORMING

Devendorf
NOW
Seth M.

Seth M.

Dwelling

Old Trampled Road

Ranch Line

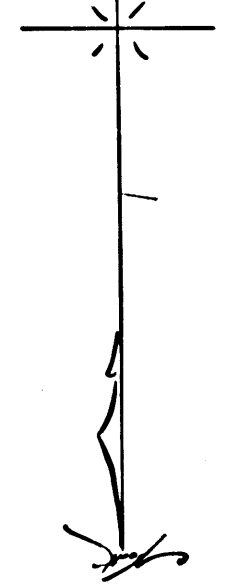

STAINLESS
DIETZEN
No. 80578

WILEY CANYON ROAD.

Declared a public highway 40' wide from Sta. 170 to Sta. 68

by Board of Supervisors, Feb. 15, 1892.

Minutes in Road Book 4, page 53.

by Harry F. Stafford

County Surveyor.

June 1891

width of Road 40 feet. Scale 6 chs. to 1'

Road Book 15 page 13.

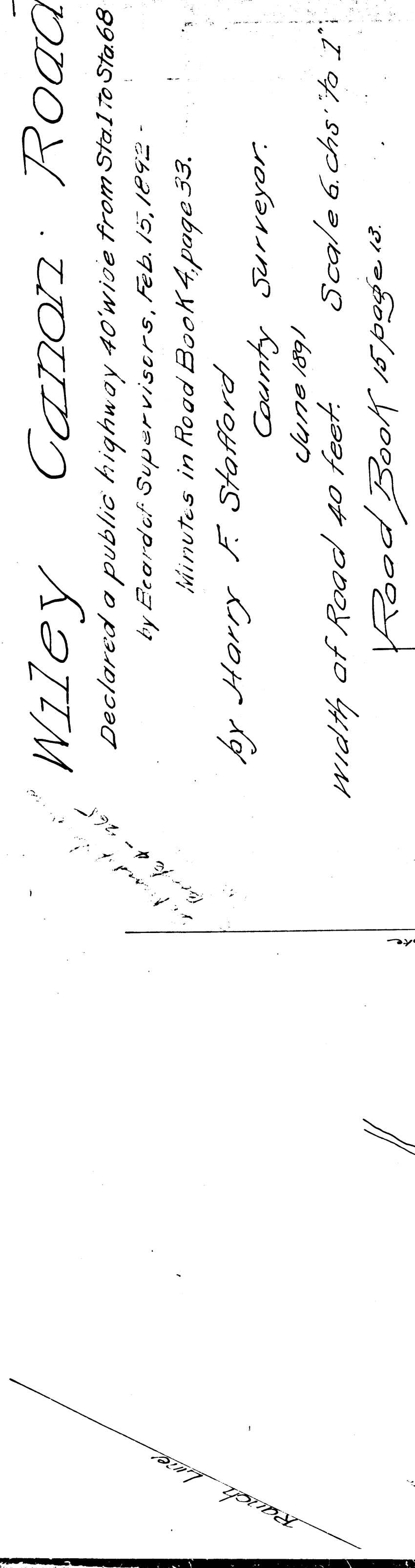

T 3 N R 16 W S B M

761-503 D:2-14 Tom Walt, Chas. Deverndorf
 res. 1-12-92 } 40' strip - being of our mt. in
 Wiley Canyon Road, sec. 16 Jan. 1891 by H.F.S.

133.90	1	133.90
140.84	2	139.84
215.55	3	137.84
211.10	4	135.84
202.62	5	133.84
110.65	6	131.84
113.62	7	129.84
146.50	8	127.84
157.90	9	125.84
129.74	10	123.84
133.79	11	121.84
235.62	12	119.84
175	13	117.84
210.69	14	115.84
520.71	15	113.84
311.20	16	111.84
175.41	17	109.84
242	18	107.84
478.50	19	105.84
147.8	20	103.84
375	21	101.84
511.5	22	99.84
14.06	23	97.84
335.12	24	95.84
249.94	25	93.84
182.18	26	91.84
174.11	27	89.84
146.50	28	87.84
141.50	29	85.84
	30	83.84
	31	81.84
	32	79.84
	33	77.84
	34	75.84
	35	73.84
	36	71.84
	37	69.84
	38	67.84
	39	65.84
	40	63.84
	41	61.84
	42	59.84
	43	57.84
	44	55.84
	45	53.84
	46	51.84
	47	49.84
	48	47.84
	49	45.84
	50	43.84
	51	41.84
	52	39.84
	53	37.84
	54	35.84
	55	33.84
	56	31.84
	57	29.84
	58	27.84
	59	25.84
	60	23.84
	61	21.84
	62	19.84
	63	17.84
	64	15.84
	65	13.84
	66	11.84
	67	9.84
	68	7.84
	69	5.84
	70	3.84
	71	1.84
	72	0.84

A 2 OF A 2
 CS 6964

Sec 9

Sec 16

with a view of the ranch line
 from Sta. 4 - 267

63
 64
 65
 66
 67
 68

CREEK

TOM WALT

Donwling

SEC. 16

Sta. 68
 Sta. 69
 Sta. 70

Ranch Line