

Pacific Ocean.

Proposed Public Road
 Commencing at the corporate limits of Santa Monica on the westerly side of Mantana Ave. just above high tide and running thence in a westerly direction following the contour of the ocean shore to the corner of the Tapango Malibu Signes Ranch

Scale 800 ft. to 1 inch
 Surveyed by S. R. Langworthy in 1887 and 1889
 C. S. 6735
 I. M. 58
 Road Book 10 Pages 16 & 17.
 Field Notes in Road Papers 37
 D. 626-232 D. 1. 250
 See C. S. No 9004
 Pat. Quitclaimed by County D 87-150, DR 11594-185
 For State Highway see F.M. 18489 Sht. No's. 1 & 2

C	S	6	7	3	5
A	1	OF	A	2	

Township 15. Range 16 W. S.B.M.

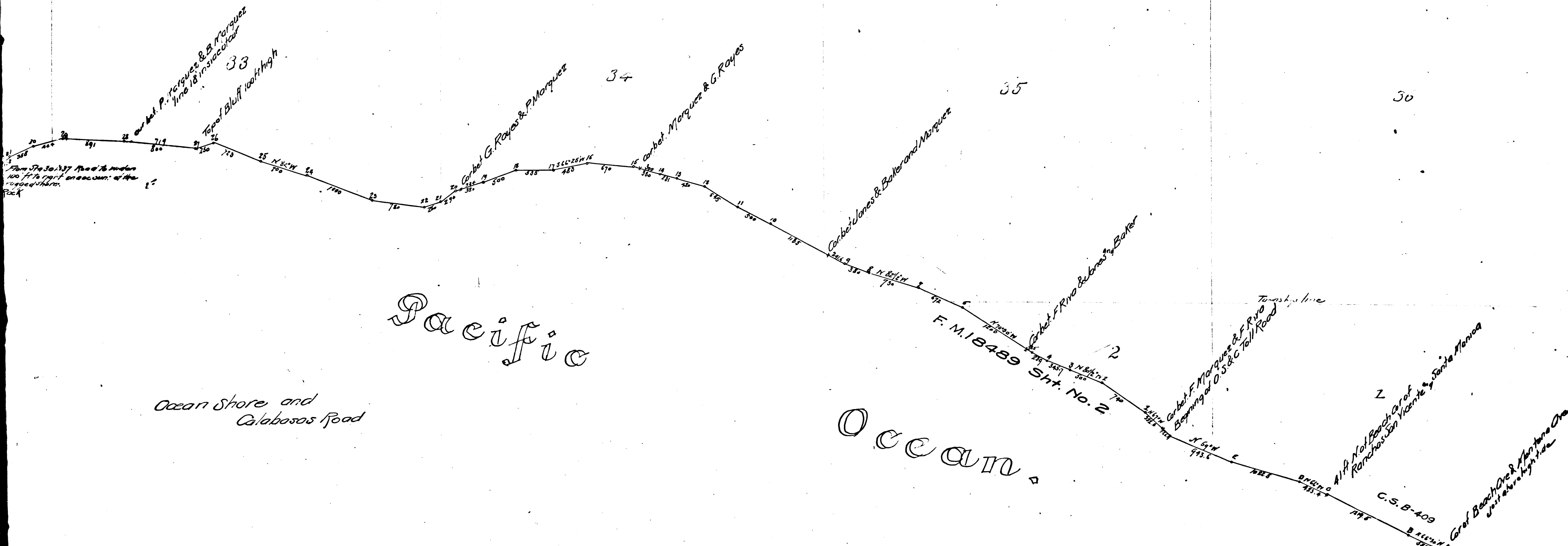

From Sta 30.137 Road to median
100 ft to right and across at the
road where
Rock

Pacific

Ocean Shore and
Calabazas Road

Ocean

F. M. 18489
Sht. No. 2

C	S	6	7	3	5
A	2	OF	A	2	