

Change in  
Puente County Road

Aug 5 1889 by Harry F. Stafford.  
Co Sur.

Scale 10chs=1in.

C. S. 6751

I. M. 42 Filed Aug 6, 1889

Road Book 1-4

WORKMAN

E. J. BAL

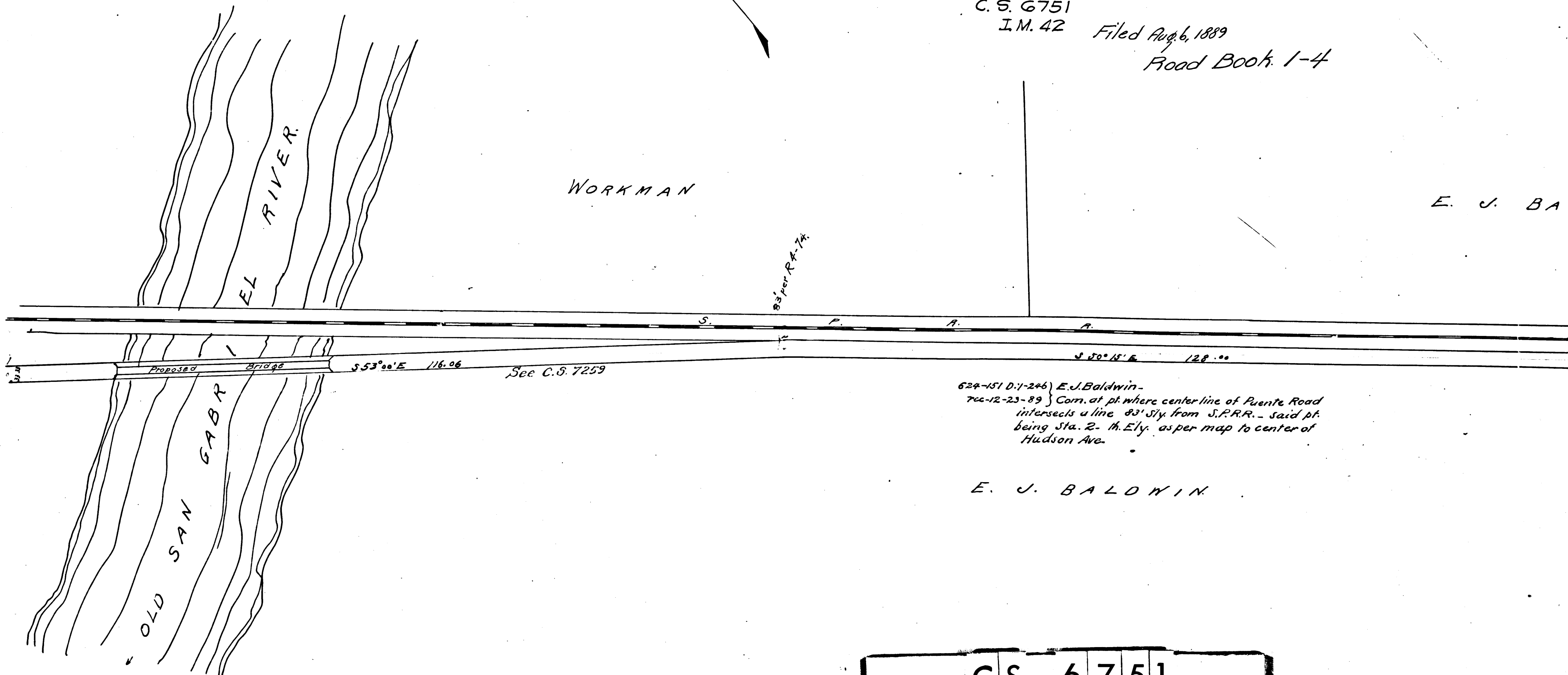

624-151 D. 1-246 } E. J. Baldwin -  
700-12-23-89 } Corn. at pt. where center line of Puente Road  
intersects a line 83' S'y from S.P.R.R. - said pt.  
being Sta. 2-14 E'y as per map to center of  
Hudson Ave.

E. J. BALDWIN

C	S	6	7	5	1
A	1	O	F	A	2



Change in  
Puente County Road.

Aug 5 1889 by Harry F. Stafford  
Co Sur.

Scale 1 inch = 100 ft.  
C. S. 6751

I. M. 42 Filed Aug 6, 1889

Road Book 1-4

E. J. BALDWIN

AN

83' per R.A. 74.

S 70° 15' E 128.00

S 45° 15' E 61.47

629-151 D. 1-246 } E. J. Baldwin -  
700-12-23-89 } Corn. at pt. where center line of Puente Road  
intersects a line 83' S'y from S.P.R.R. - said pt.  
being Sta. 2-14 Ely. as per map to center of  
Hudson Ave.

E. J. BALDWIN

C	S	6	7	5	1
A	2	O	F	A	2

