

Showing the Proposed Widening of

ROWLAND ROAD DISTRICT

LOS ANGELES CO. CAL.

IRWINDALE AVE.

Surveyed under instructions from the Honorable Board of Supervisors

A. R. STREET

County Surveyor

C. S. 6918

I. M. 27

Feb 7th 1894

Present road shown in yellow.  
Land proposed to be taken to widen road from 40 to 60  
Feet, shown in red.

Scale 3 chs. per inch.

Record of Surveys 5-84

Filed May 19, 1894

Puente and Ayuso Bridge. Road changed to Irwindale Ave. D. 13-60 R. B. 19 66

Note: For later map see C. S. B-2727

Center line Sec. 4

See Case 667

See C.S. 2550

House

La Puente

Orange Orchard

Strip 16' wide x 1200' long vacated Mar 24, 1900 Sec 4 T12N R10E S1W  
10 Strip Vac by M.B. 511-31 e-7  
N. 4° 03' W. 273.4' to cor.

Orchard

Baughman

Heath

Wade

E. R. Coffman

G.T.L.

V.L. Davenport

CS 6918

A1 OF A2

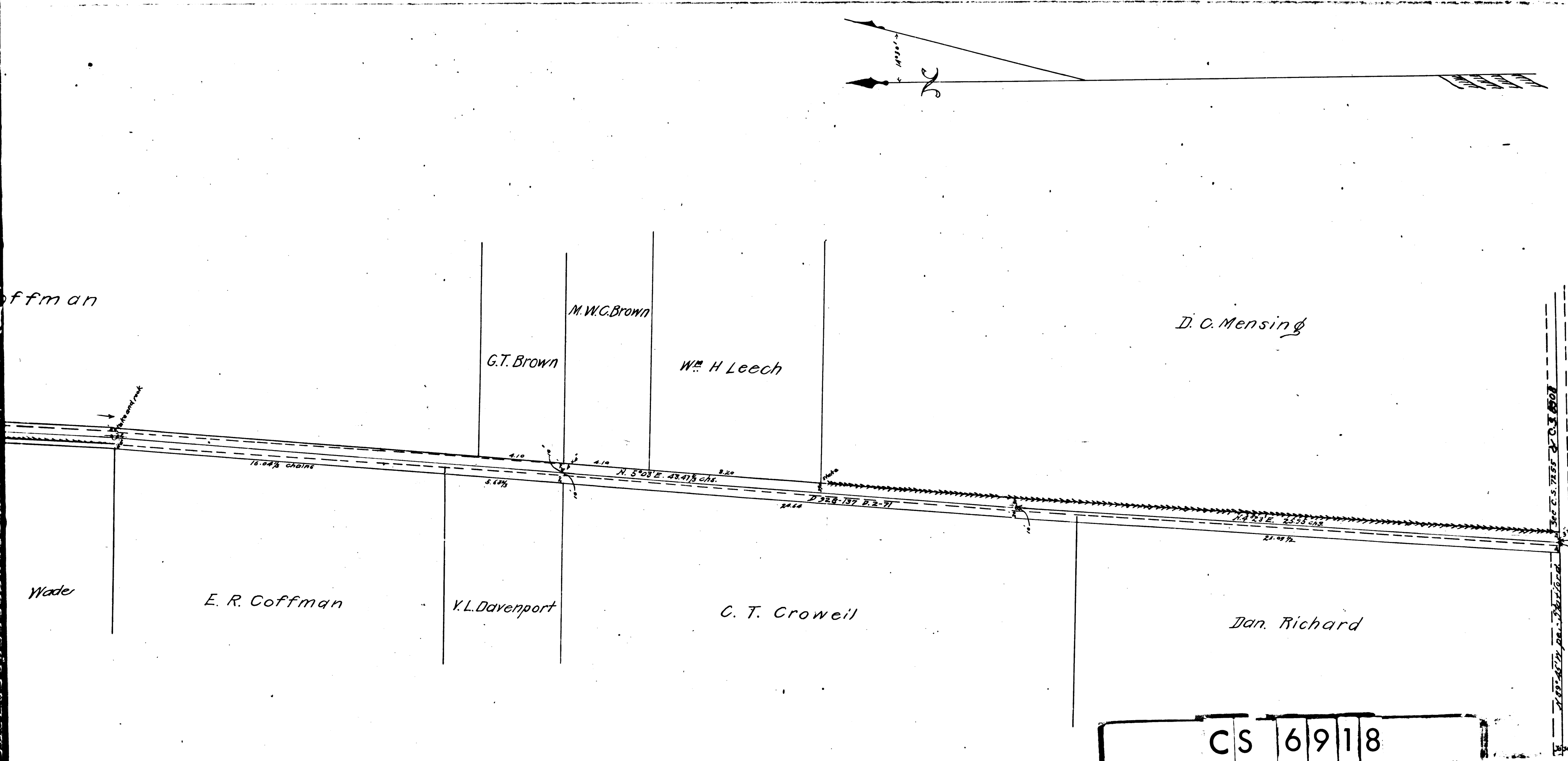

ffman

M.W.C. Brown

D. O. Mensing

G.T. Brown

W.H. Leech

Wade

E. R. Coffman

Y.L. Davenport

C. T. Crowell

Dan. Richard

CS 6918

A2 OF A2

E. J. B...