

GLENDORA ROAD DIST.

SCALE: 1" = 80 CHS

I. B. NOBLE COUNTY SURVEYOR

CORRECTED TO APRIL-1918.

G.I.

C.S. 7050

T.M. 4748



2	1	6	5	4	3	2	1
11	12	7	6	9	10	11	12
14	13	18	17	16	15	14	13
T.P. N. 10 W.				T.P. N. 9 W.			
23	24	19	20	21	22	23	24
26	25	30	29	28	27	26	25
35	36	31	32	33	34	35	36
T.I.N. R. 10 W.				T.I.N. R. 9 W.			
1	6	5	4	3	2	1	0
12	7	8	9	10	11	12	13
13	18	17	16	15	14	13	12
T.I.N. R. 10 W.				T.I.N. R. 9 W.			

Scale 1/4" = 80 Chs.

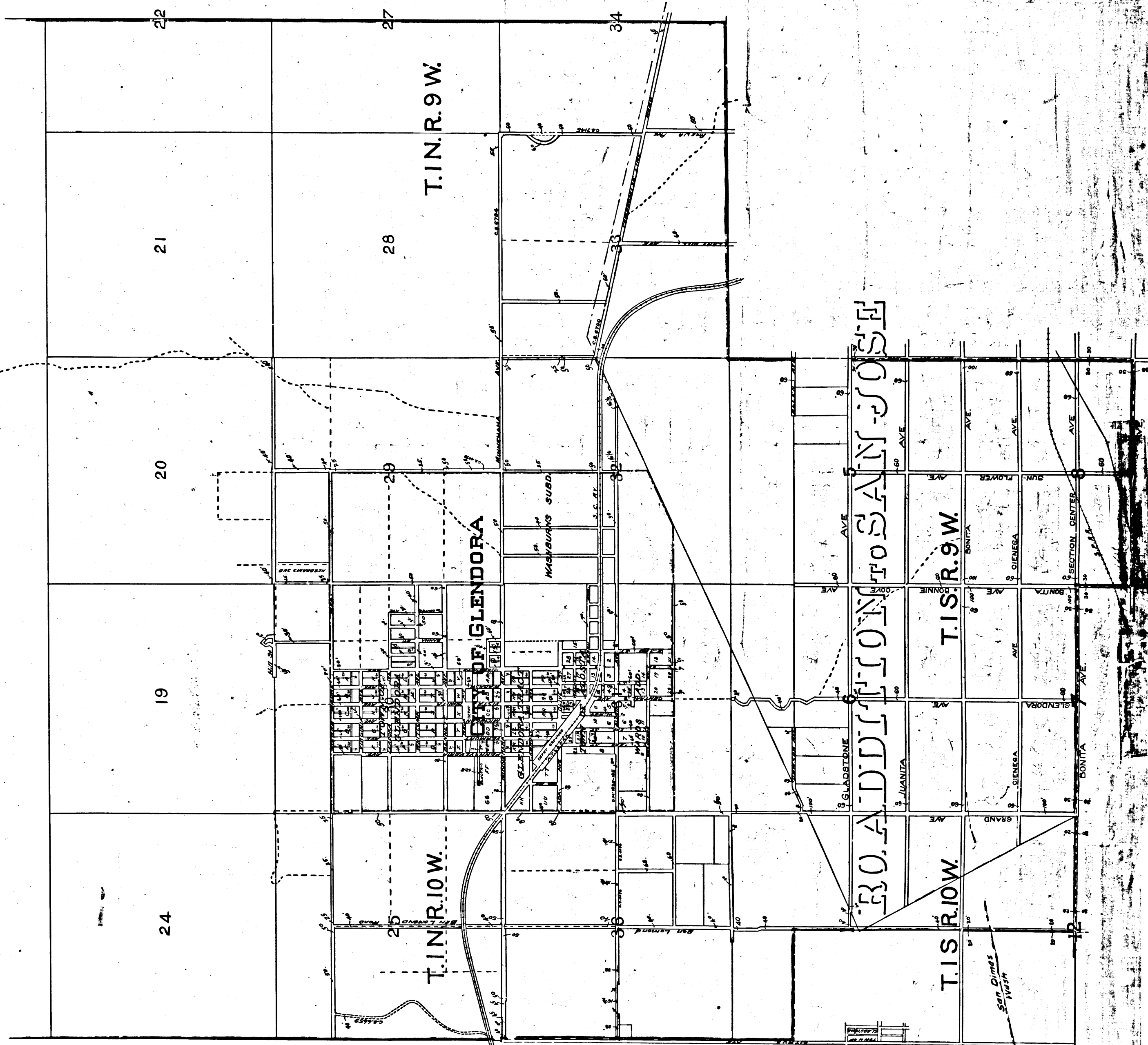

CS 7050