

Temple St. name added. Ord. 2827  
 Edith St. changed to Alameda St. Ord. 2828  
 Austin St. • Catalina St.  
 Bruce St. • Mississippi Ave.  
 Arminta St. • New Hampshire Ave.  
 Barrow St. • Oakwood Ave. Ord. 26525  
 For widening a part of Temple St. see C.F. 922 D. 3-10/27423-10

CS 7113  
 A1 OF A2

map  
OF  
SECTION 13.

T.I.S.R.14.W.

LOS ANGELES CO.

COUNTY SURVEYORS MAP NO. 7113

Leo V. Youngworth, County Surveyor.

Scale: 1 in. = 150 ft.

I.M. 9

F.B. 23. 72-77.

NOTE: Figures in Blue are record distances.  
Black - chained

This Photact Tracing made Nov. 1956,  
from the cloth mounted egg-shell original  
map which has been discarded.

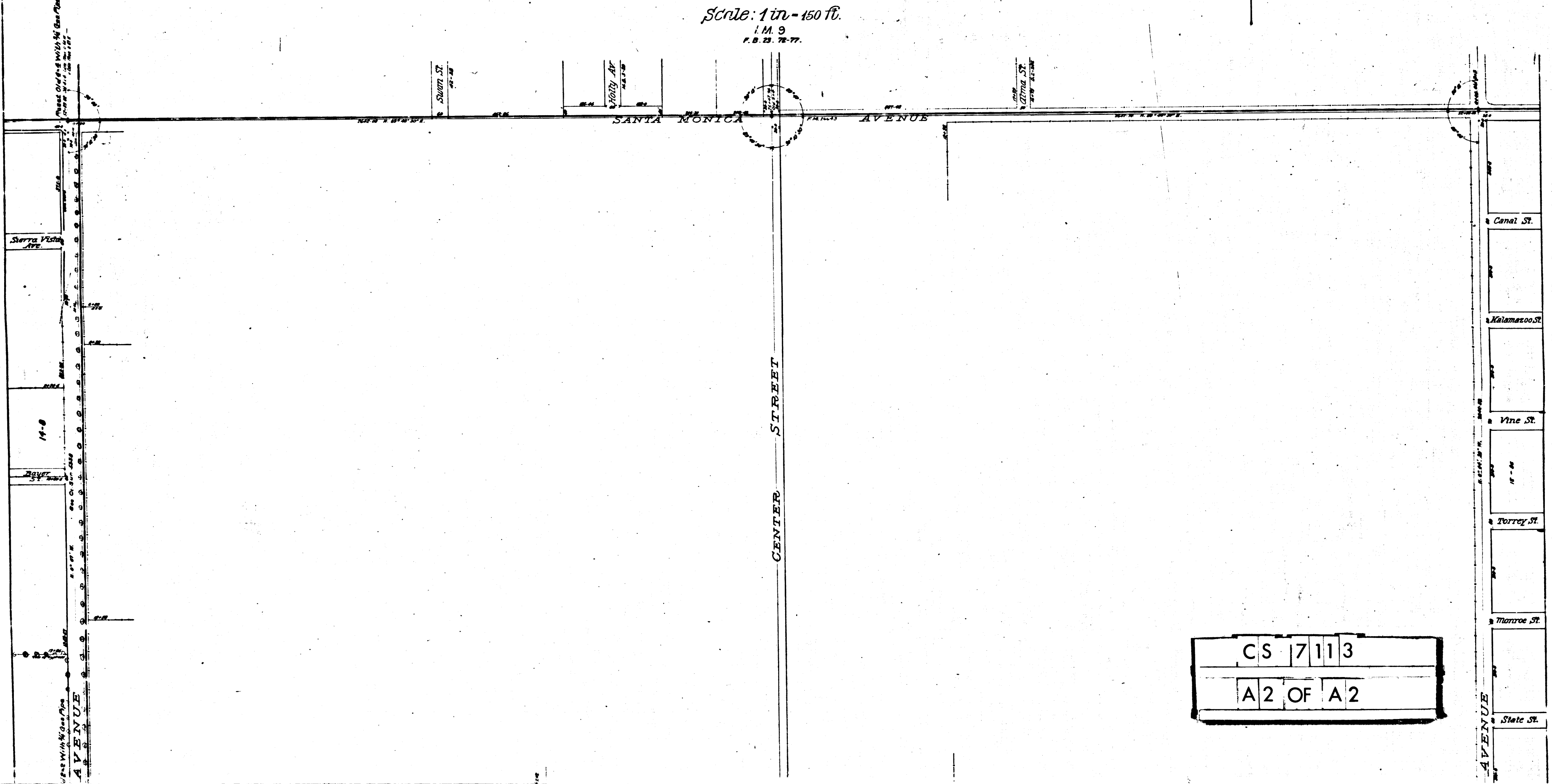
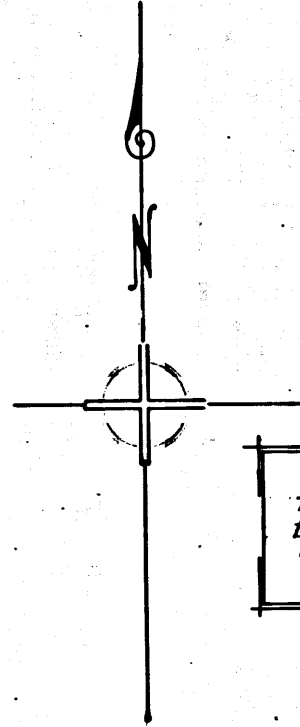

CS	7113	
A2	OF	A2