

CLAREMONT

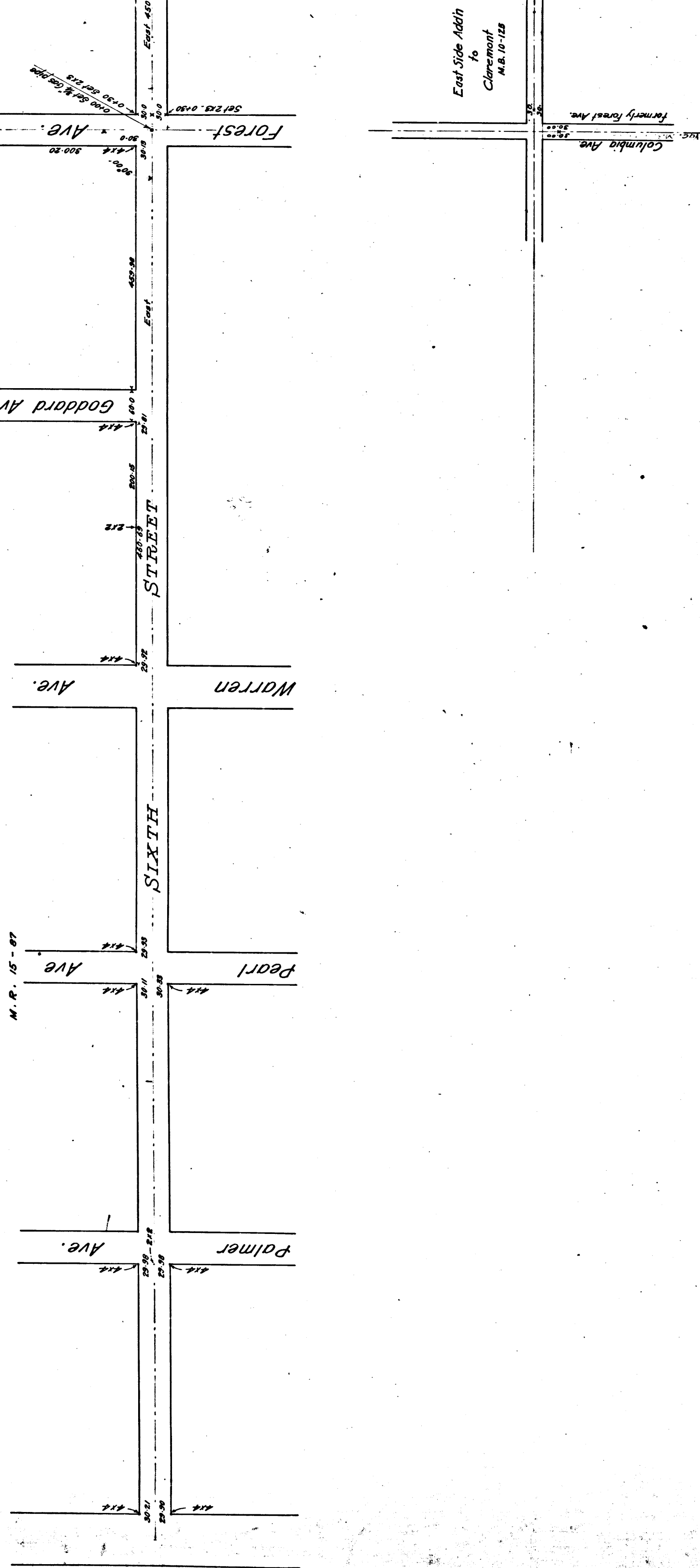

MAP
 OF EXTENSION OF SIXTH ST
 in Claremont,
 to Eastern boundary of
 LOS ANGELES CO.

February, 1904. C.S. 7148 Leo V. Youngworth, Co. Survr.

Scale: 1 in = 150 ft.

I.M. 49 F.B. 25-25

| | |
|----|-------|
| CS | 7148 |
| A1 | OF A2 |

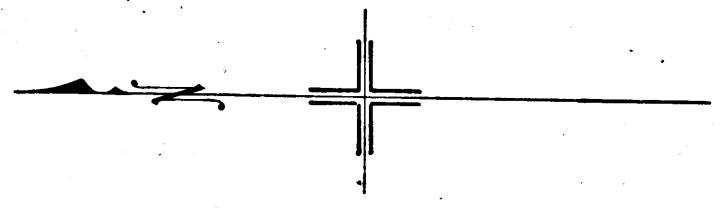

East Side Adh
to
Claremont
M.B. 10-125

Formerly Forest Ave.
Columbia Ave

East Side Adh
to
Claremont
M.B. 10-125

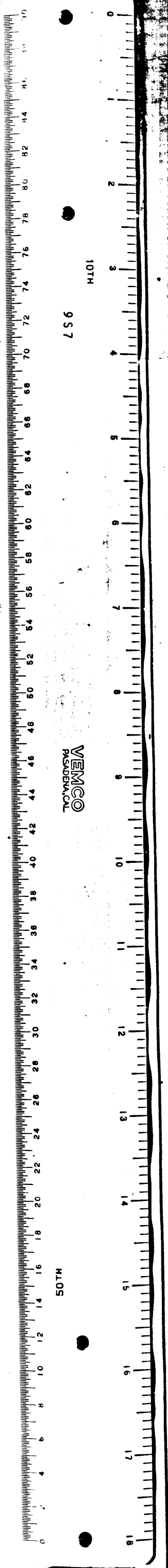

T. 1 S. R. 8 W.
SEC. 10.

East Side Addr
to
Claremont
N.B. 10-125

loc. or portion of 6th St. by Ord 37 D. 18-274.

TRACT No. 1008
M.B. 17-62-63

Scale: 1 inch = 300 ft.

Brooks Ave
Mills Ave

For dead Sixth St. see D. 6117-129 D. 18-273

| | | | | | |
|---|---|----|---|---|---|
| C | S | 7 | 1 | 4 | 8 |
| A | 2 | OF | A | 2 | |

San Bernardino County
Eastern Boundary of Los Angeles Co. (Approximate)

Santa Fe

0+00 Sta. Post in
Mount of Adams County
Boundary Mont. 1877.

