

SICHEL ST.

GRIFFIN AVE.

MISSION ROAD

MAP SHOWING
 PROPOSED DRIVES CURBS
 AND WALKS
 in grounds of
 LOS ANGELES CO. HOSPITAL

March, 1906. Leo V. Youngworth Co. Surveyor
 Scale: 1 in = 20 ft.
 L. S. P. 49 L. S. 19. 53.
 County Surveyors Map No 7236
 Elevations for Top of Curb are shown
 by underlined figures thus: 32.25

I. M. 8

Quantities.	
Curb	1351. lin. ft.
Walk	2221. sq. ft.
Driveway	2202. sq. ft.

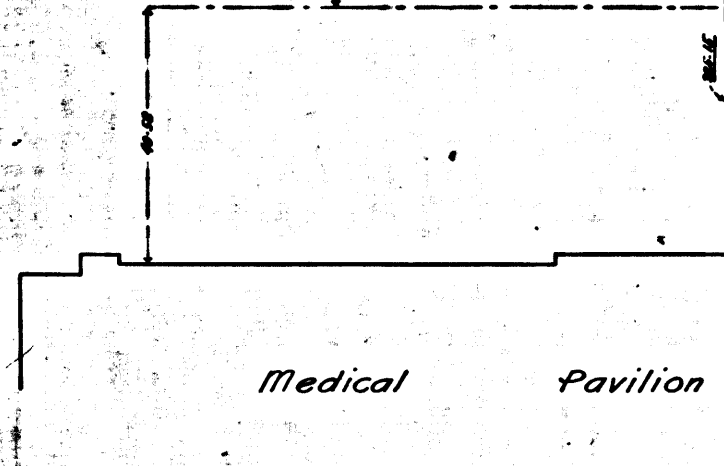
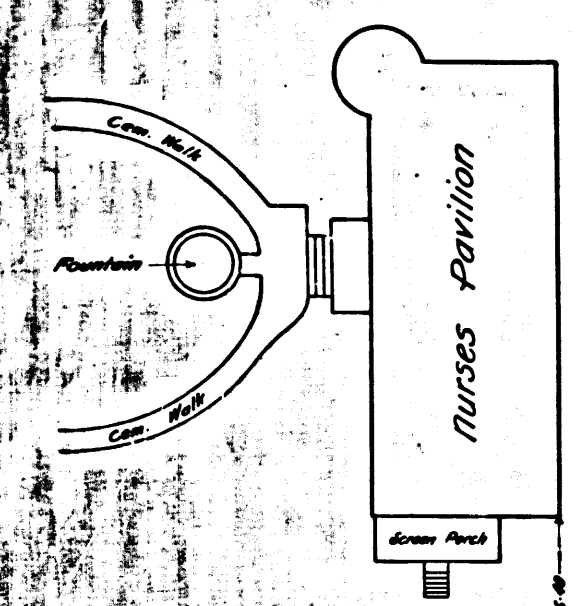

Medical Pavilion

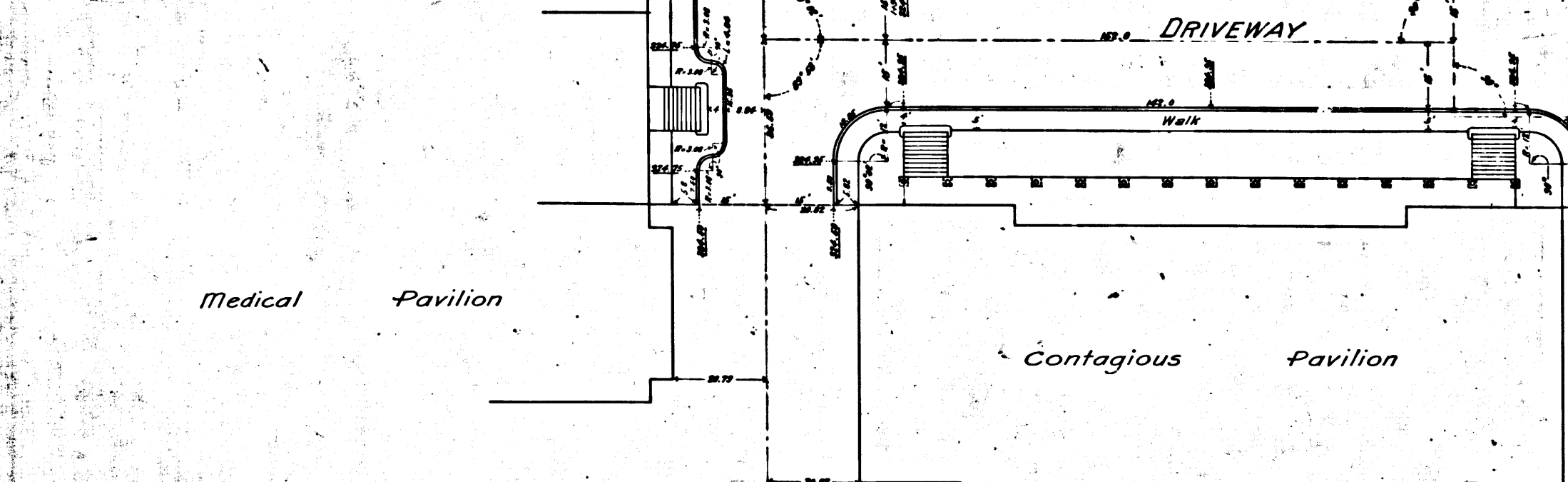

Contagious Pavilion

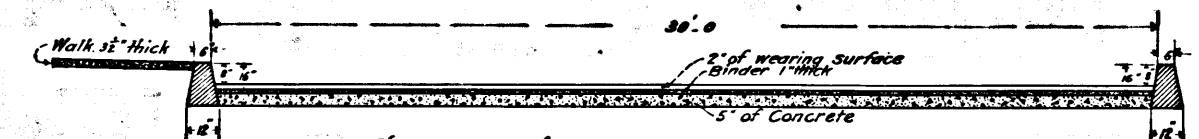

CROSS SECTION OF DRIVEWAY
 Scale: 1 in = 4 ft.

CS 7236